

Woodbury County Permit No. \_\_\_\_\_

**PERMIT FOR USE OF COUNTY ROAD/HIGHWAY RIGHT-OF-WAY FOR OVERHEAD AND/OR BURIED UTILITIES ACCOMMODATION**

**REQUEST BY APPLICANT:**

Name TelCom Construction - Tabitha Highway \_\_\_\_\_  
 Township Concord  
 Address 2218 200th St E PO Box 189 Clearwater MN 55320 City of Lawton  
 Office Phone 402.599.9221 Local Phone 402.599.9221 Section: 15  $\frac{1}{4}$  of  $\frac{1}{4}$  Sec  
 Type of Utility Installation Telephone T-89 N, R-47 W  
 Plans Prepared By Century Link Copy Enclosed  Yes  No  
 Map Showing Location Enclosed  Yes  No  
 Utility Location is \_\_\_\_\_ cross right-of-way  parallel to right-of-way  
 \_\_\_\_\_ overhead  underground  
 Proposed Method of Installation  
 \_\_\_\_\_ tunnel \_\_\_\_\_ suspend on poles \_\_\_\_\_ cased  
 \_\_\_\_\_ jack & bore \_\_\_\_\_ suspend on towers  trench  
 \_\_\_\_\_ open cut \_\_\_\_\_ plow

Estimated Starting Date 06.18.2020 Estimated Restoration Date 06.25.2020

The Applicant understands and agrees that the permitted work shall comply with all permit provisions and conditions listed on the reverse side hereof, and special provisions listed below or attached hereto, and any and all plans, details, or notes attached hereto and made a part thereof. Applicant is to complete in triplicate and send all copies including plans and maps to Woodbury County Engineer, 759 E. Frontage Road, Mowile, IA 51039. One executed copy will be returned to the Applicant.

By  Title Operations Support Supervisor  
 (Signature of Authorized Utility Representative)  
 Date 06.11.2020

**PERMIT APPROVAL BY PERMITTING AUTHORITY**

The foregoing application is hereby approved and permit issued by the Permitting Authority subject to full compliance by the Applicant with all provisions and conditions stated herein and on the reverse side hereof and all attachments hereto.

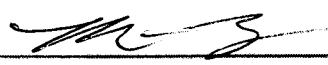
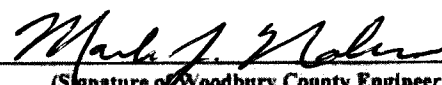
By  Title Chairman  
 (Signature of Woodbury County Board Chairman) Date 6-23-20  
 By  Title County Engineer  
 (Signature of Woodbury County Engineer) Date 6-23-2020

Other Special Provisions:

**Permit Provisions and Conditions of Issuance**

- The County and/or the County Board of Supervisors will not be charged with any responsibility for damages to the Applicant's property occasioned by any construction or maintenance operations on said county roads, including new or additional right-of-way acquired in connection therewith, subsequent to the building of the Applicant's facilities. The Board will endeavor to give the Applicant sufficient notice of any proposed construction or maintenance work, on either existing or newly acquired right-of-way that is likely to expose, cover up, or disturb any facilities belonging to the Applicant, in order that the Applicant may arrange to protect the facilities. The Board will inform contractors, and others working on the job of the location of the facilities so that reasonable care may be taken to avoid damaging the facilities, however the County and the Board of Supervisors will assume no responsibility for failure to give such notice.

2. The Applicant shall take all reasonable precaution during the construction of said facilities to protect and safeguard the lives and property of the adjacent property owners and the traveling public and shall save the County and the Board of Supervisors harmless of any damages or losses that may be sustained by adjacent property owners and the traveling public on account of such construction operations.
3. Operations in the construction and maintenance of said facilities shall be carried on in such a way as to not interfere with, or interrupt traffic on said roads. However, should the performance of work called for in this permit in any way interfere with or obstruct traffic on said roads, the Applicant shall provide the necessary flagmen as required by the Statutes when one-way traffic is involved and/or otherwise mark said work so as to protect the traveling public.
4. The Applicant shall hold the County and the Board of Supervisors harmless from any damages that may result to said highway because of the construction or maintenance of said facilities and shall reimburse the County or the Board of Supervisors for any expenditures that the County or the Board of Supervisors may have to make on said roads on account of replacement of surfacing gravel and bridge and culvert repairs.
5. Applicant shall lay, construct, operate and maintain said facilities so as not to interfere with natural drainage of the road and so as not to interfere with the construction or maintenance of said roads. When buried cable or wire lines are to be placed lengthwise with the roadway, they shall be placed in the County road shoulder or ditch near the toe of the fore-slope and parallel to centerline of roadbed at a depth of three (3) to four (4) feet by using specially designed plows or by trenching, whichever is appropriate. Plow slots and trenches shall be repacked as necessary to restore the disturbed area to its original condition. For buried line crossings of roadways not paved, an open trench may be dug and the lines placed therein, and the trench back-filled over the lines. Buried line crossings on paved roadways, lines may be placed through the sub-grade by jacking, or by boring a hole just large enough to take the lines; or if the County Engineer approves, a tunnel may be dug through and the cable or wire lines placed therein. All backfill of tunnels and trenches shall be thoroughly compacted in layers of 6" or less in depth. Back-filling of trenches within the right-of-way by not under the traveled roadway shall be tamped sufficiently to avoid settlement. When crossing an existing roadway, all buried facilities shall be placed a minimum of three (3) to four (4) below the bottom of the existing adjacent ditches. Overhead lines, where practical, shall be placed adjacent to and with two (2) feet of the Road/Highway Right-of-Way Line.
6. The Applicant will at any time subsequent to placing the facilities, and at the Applicant's expense, relay, replace, alter, change, reconstruct, or relocate its overhead and/or buried facilities and appurtenances thereto as may become necessary to conform to new grades, alignment, or widening right-of-way, resulting from maintenance or construction operations by the County Board of Supervisors irrespective of whether or not additional right-of-way is acquired in connection with such road improvements. The Applicant agrees to do this within ninety (90) days written notice from the Board of Supervisors, and without cost to the County. If the Applicant is unable to comply within said ninety (90) days, the Board of Supervisors may cause the work to be done and the Applicant will pay the cost thereof upon receipt of statement.
7. All work shall be done in a workmanlike manner; the surrounding ground, slopes, and ditch bottoms shall be reshaped to conform to the area and left in a neat condition satisfactory to the County Engineer. All areas where sod has been damaged or destroyed shall be re-seeded.
8. The Applicant shall notify the County Board of Supervisors at least forty-eight (48) hours in advance of the Applicant's intention of starting work covered by this permit on the road right-of-way. Said notice shall be in writing to the County Engineer.
9. Applicant, its' successors, grantees and assigns shall and hereby agrees to assume all responsibility, risks and liabilities for all accidents and damages that may occur to persons and/or property on account of the work done under this permit, and to this end, indemnify and hold the County and all authorized representatives thereof harmless from any and all claims, damages, losses, and expense including judgements, costs and including attorney's fees, for personal injuries (including death) or property damage arising or resulting from the activities of the Applicant in connection herewith, now and at all times in the future.
10. It is understood that this permit is issued only insofar as Woodbury County has jurisdiction and does not presume to release the Applicant from fulfilling any existing statutes relating to the installation, construction and operation of said facilities.
11. It is further understood that the facilities covered by this permit shall be constructed or installed within one (1) year after the date of approval of this permit, unless otherwise extended in writing by Woodbury County.
12. Engagement in the operations as herein applied for by the Applicant shall be considered and constitute an acceptance of all the terms and conditions herein set forth.

# BSW SKETCH FORM

NPA / NNX (Wire Center): 712239

Nectas #: 20098839-HELD

Date Submitted: 6-1-2020

|   |   |
|---|---|
| <p>Installation / Repair / Preprovisioning<br/>(Please Check One of the Above)</p> <p>Job ID <u>N 15933132</u></p> <p>TN <u>712 239 3522</u></p> <p>1. Held For BSW <input checked="" type="checkbox"/></p> <p>2. Held - cannot locate ENCAP <input type="checkbox"/></p> <p>3. OOS - Can not lay temp <input type="checkbox"/></p> <p>4. Held for F1-F2, also need BSW <input type="checkbox"/></p> <p>5. Temp Placed - (Need Sketch Below) <input type="checkbox"/></p> <p>6. Found Temp - Same Job <input type="checkbox"/></p> <p style="padding-left: 20px;">- Other Location <input type="checkbox"/></p> <p>7. Add Line <input type="checkbox"/></p> | <p>Customer Name: <u>Scott Ross</u></p> <p>Address: <u>1287 Carroll Ave</u> City: <u>LAWTON</u></p> <p>911 Address: _____</p> <p>Phone: <u>712 239 3522</u> CBR: <u>712 490 2685</u></p> <p>Subdivision: _____ Lot: _____ Block: _____</p> <p>County <u>Woodsbury</u> Section _____ Range _____ Township _____</p> <p style="text-align: center; font-size: small;">Quarter Section (Check one) NW - NE - SW - SE</p> <p>Submitted By: _____</p> <p>Name: <u>Rob Blades</u> EC: <u>662</u> Pgr/Cell: <u>490 4437</u></p> <p>Supervisor: <u>Jeff L</u></p> <p>Office #: _____ Pager: _____</p> <p>Customer was contacted: verbal <input checked="" type="checkbox"/> card <input type="checkbox"/></p> |
| <p>Hudson/King: Yr: _____ Pg: _____ Terminal Address: <u>1231-8</u></p> <p>Cross Street: <u>120th</u> Total BSW Footage: <u>150</u> Type of Wire: <u>3pr (3pr/8pr)</u></p>  |   |
| <p>L-INFO: <u>L</u> <u>F</u> <u>N-W</u> <u>2</u> <u>-</u> <u>G</u> <u>3</u> <u>S</u> <u>U</u> <u>C</u></p> <p style="font-size: small; text-align: center;">LE P/R N.E.S.W. 1-9-5-6-7 W.S.P.O.C. G.A.M.N. 3/8 S.N. P.N. 0</p>   |   |

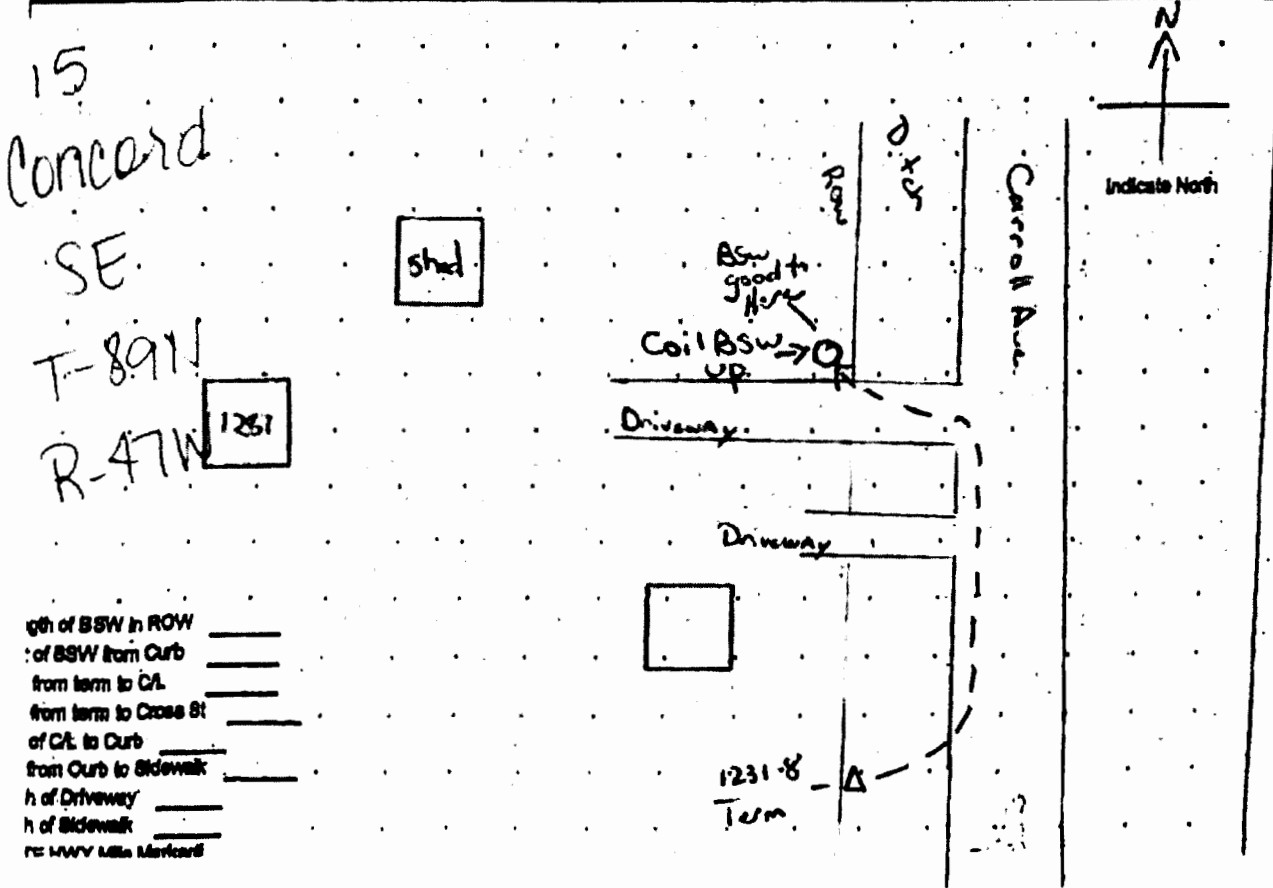

gth of BSW in ROW \_\_\_\_\_  
 of BSW from Curb \_\_\_\_\_  
 from term to CL \_\_\_\_\_  
 from term to Cross St \_\_\_\_\_  
 of CL to Curb \_\_\_\_\_  
 from Curb to Sidewalk \_\_\_\_\_  
 h of Driveway \_\_\_\_\_  
 h of Sidewalk \_\_\_\_\_  
 RE: WWW.MLS.Market



2. The Applicant shall take all reasonable precaution during the construction of said facilities to protect and safeguard the lives and property of the adjacent property owners and the traveling public and shall save the County and the Board of Supervisors harmless of any damages or losses that may be sustained by adjacent property owners and the traveling public on account of such construction operations.
3. Operations in the construction and maintenance of said facilities shall be carried on in such a way as to not interfere with, or interrupt traffic on said roads. However, should the performance of work called for in this permit in any way interfere with or obstruct traffic on said roads, the Applicant shall provide the necessary flagmen as required by the Statutes when one-way traffic is involved and/or otherwise mark said work so as to protect the traveling public.
4. The Applicant shall hold the County and the Board of Supervisors harmless from any damages that may result to said highway because of the construction or maintenance of said facilities and shall reimburse the County or the Board of Supervisors for any expenditures that the County or the Board of Supervisors may have to make on said roads on account of replacement of surfacing gravel and bridge and culvert repairs.
5. Applicant shall lay, construct, operate and maintain said facilities so as not to interfere with natural drainage of the road and so as not to interfere with the construction or maintenance of said roads. When buried cable or wire lines are to be placed lengthwise with the roadway, they shall be placed in the County road shoulder or ditch near the toe of the fore-slope and parallel to centerline of roadbed at a depth of three (3) to four (4) feet by using specially designed plows or by trenching, whichever is appropriate. Plow slots and trenches shall be repacked as necessary to restore the disturbed area to its original condition. For buried line crossings of roadways not paved, an open trench may be dug and the lines placed therein, and the trench back-filled over the lines. Buried line crossings on paved roadways, lines may be placed through the sub-grade by jacking, or by boring a hole just large enough to take the lines; or if the County Engineer approves, a tunnel may be dug through and the cable or wire lines placed therein. All backfill of tunnels and trenches shall be thoroughly compacted in layers of 6" or less in depth. Back-filling of trenches within the right-of-way by not under the traveled roadway shall be tamped sufficiently to avoid settlement. When crossing an existing roadway, all buried facilities shall be placed a minimum of three (3) to four (4) below the bottom of the existing adjacent ditches. Overhead lines, where practical, shall be placed adjacent to and with two (2) feet of the Road/Highway Right-of-Way Line.
6. The Applicant will at any time subsequent to placing the facilities, and at the Applicant's expense, relay, replace, alter, change, reconstruct, or relocate its overhead and/or buried facilities and appurtenances thereto as may become necessary to conform to new grades, alignment, or widening right-of-way, resulting from maintenance or construction operations by the County Board of Supervisors irrespective of whether or not additional right-of-way is acquired in connection with such road improvements. The Applicant agrees to do this within ninety (90) days written notice from the Board of Supervisors, and without cost to the County. If the Applicant is unable to comply within said ninety (90) days, the Board of Supervisors may cause the work to be done and the Applicant will pay the cost thereof upon receipt of statement.
7. All work shall be done in a workmanlike manner; the surrounding ground, slopes, and ditch bottoms shall be reshaped to conform to the area and left in a neat condition satisfactory to the County Engineer. All areas where sod has been damaged or destroyed shall be re-seeded.
8. The Applicant shall notify the County Board of Supervisors at least forty-eight (48) hours in advance of the Applicant's intention of starting work covered by this permit on the road right-of-way. Said notice shall be in writing to the County Engineer.
9. Applicant, its' successors, grantees and assigns shall and hereby agrees to assume all responsibility, risks and liabilities for all accidents and damages that may occur to persons and/or property on account of the work done under this permit, and to this end, indemnify and hold the County and all authorized representatives thereof harmless from any and all claims, damages, losses, and expense including judgements, costs and including attorney's fees, for personal injuries (including death) or property damage arising or resulting from the activities of the Applicant in connection herewith, now and at all times in the future.
10. It is understood that this permit is issued only insofar as Woodbury County has jurisdiction and does not presume to release the Applicant from fulfilling any existing statutes relating to the installation, construction and operation of said facilities.
11. It is further understood that the facilities covered by this permit shall be constructed or installed within one (1) year after the date of approval of this permit, unless otherwise extended in writing by Woodbury County.
12. Engagement in the operations as herein applied for by the Applicant shall be considered and constitute an acceptance of all the terms and conditions herein set forth.

