



NOTICE OF MEETING OF THE WOODBURY COUNTY BOARD OF SUPERVISORS
(SEPTEMBER 15, 2015) (WEEK 38 OF 2015)

Agenda and Minutes also available at
www.woodburycountyiowa.gov

Larry D. Clausen 389-5329 lclausen@woodburycountyiowa.gov
Mark A. Monson 204-1015 mark@mudflap.com
Jaclyn D. Smith 898-0477 jasmith@woodburycountyiowa.gov
Jeremy J. Taylor 259-7910 jercmytaylor@cableone.net
Matthew A. Ung 490-7852 matthewung@woodburycountyiowa.gov

You are hereby notified a meeting of the Woodbury County Board of Supervisors will be held September 15, 2015 at 4:30 p.m. in the Basement of the Courthouse, 620 Douglas Street, Sioux City, Iowa for the purpose of taking official action on the agenda items shown hereinafter and for such other business that may properly come before the Board.

This is a formal meeting during which the Board may take official action on various items of business. If you wish to speak on an item, please follow the seven participation guidelines adopted by the Board for speakers.

- 1. Anyone may address the Board on any agenda item after initial discussion by the Board.
- 2. Speakers will approach the microphone one at a time and be recognized by the Chair.
- 3. Speakers will give their name, spell their name, and give their address and then their statement.
- 4. Everyone will have an opportunity to speak. Therefore, please limit your remarks to **three minutes on any one item.**
- 5. At the beginning of the discussion on any item, the Chair may request statements in favor of an action be heard first followed by statements in opposition to the action.
- 6. Any concerns or questions you may have which do not relate directly to a scheduled item on the agenda will also be heard under the final agenda item "Citizen Concerns."
- 7. For the benefit of all in attendance, please turn off all cell phones and other devices while in the Board Chambers.

AGENDA

- 4:30 p.m.** 1. Call Meeting to Order – Pledge of Allegiance to the Flag – Moment of Silence
2. Citizen Concern Information
3. Approval of the agenda September 15, 2015 Action
4. Approval of the minutes of September 8, 2015 meeting Action
Approval of the minutes of September 11, 2015 meeting Action
5. Discussion and approval of claims Action
6. Human Resources – Ed Gilliland
Approval of Memorandum of Personnel Transaction Action
- 4:35 p.m.** 7. Board Administration/Public Bidder – Karen James
(Set time) a. Public hearing and sale of property Parcel #178876 (aka 2820 W. 14th St.) Action
- 4:37 p.m.** b. Public Hearing and Sale of Property Parcel #781410 (see legal description) Action
(Set time)
- 4:39 p.m.** c. Public Hearing and Sale of Property Parcel #786375 (see legal description) Action
(Set time)

- | | | |
|--------------------------------|--|-------------|
| 4:40 p.m.
(Set time) | 8. Secondary Roads – Mark Nahra | |
| | a. Receive and consider bids for PCC Paving of 255 th Street and turning lanes on Port Neal Road project RCX-CO97(119)—9A-97 | Action |
| 4:45 p.m.
(Set time) | b. Receive and consider bids for slide repair and RCB culvert extensions on D38 and K64 project ER-CO97(124)—58-97 | Action |
| | 9. Planning/Zoning – John Pylelo
Consideration and Referral of Final Platting to Zoning Commission for Public Hearing and Recommendation for Water Dog Addition - a minor subdivision; GIS Parcel # <u>874811300010</u> . | Action |
| | 10. Building Services – Kenny Schmitz
Approval of utilities and energy usage monitoring | Action |
| | 11. Board of Supervisors – Jeremy Taylor & Matthew Ung
Approval of a resolution sunsetting the “Investing in Woodbury County Loan” Program | Action |
| | 12. Secondary Roads – Mark Nahra | |
| | a. Consideration of award of bids to replace short span bridge project L-C(N48) --73-97 | Action |
| | b. Consideration of award of bids for PCC Paving of 255 th Street and turning lanes on Port Neal project RCX-CO97(119)—9A-97, subject to the approval of the Iowa Department of Transportation | Action |
| | c. Consideration of award of bids for slide repair and RCB culvert extensions on D38 and K64 project ER-CO97(124)—58-97 subject to the approval of the Iowa Department of Transportation | Action |
| | d. Consideration of approval of the contract with Hallett Materials for gravel to be furnished and placed on the roadway in five townships | Action |
| | 13. Reports on committee meetings | Information |
| | 14. Citizen's Concerns | Information |
| | 15. Board Concerns and Comments | Information |

ADJOURNMENT

Subject to Additions/Deletions

CALENDAR OF EVENTS

TUESDAY, SEPTEMBER 15	4:30 p.m.	Community Action Agency of Siouxland Board Meeting, 2700 Leech Avenue
WEDNESDAY, SEPTEMBER 16	12:00 noon	Siouxland Economic Development Corporation Meeting, 617 Pierce St., Ste. 202, Sioux City, Iowa
THURSDAY, SEPTEMBER 17	11:00 a.m.	Siouxland Regional Transit Systems (SRTS) Board Meeting, SIMPCO Office, 1122 Pierce St., Sioux City, Iowa
TUESDAY, SEPTEMBER 22	1:30 p.m.	Sioux Rivers Regional Governance Board Meeting, Plymouth County Courthouse Annex Building, 215 4th Ave.
WEDNESDAY, SEPTEMBER 23	6:30 p.m.	Board of Supervisors Town Hall Meeting, Cushing Fire Station
MONDAY, SEPTEMBER 28	6:00 p.m.	Zoning Commission Meeting, Board of Supervisors' Chambers
	7:30 p.m.	Fair Board Meeting, Woodbury County Fair Office, Fairgrounds, Merville, Iowa.
TUESDAY, SEPTEMBER 29	2:00 p.m.	Decat Board Meeting, Western Hills AEA, Room F
THURSDAY, OCTOBER 1	5:00 p.m.	Conservation Board Meeting, Brown's Lake/Bigelow Park Dale Bell Shelter
MONDAY, OCTOBER 5	6:00 p.m.	Board of Adjustment meeting, Board of Supervisors' Chambers
TUESDAY, OCTOBER 6	4:45 p.m.	Veteran Affairs Meeting, Veteran Affairs Office, 1211 Tri-View Ave.
WEDNESDAY, OCTOBER 7	12:00 noon	District Board of Health Meeting, 1014 Nebraska St.
THURSDAY, OCTOBER 8	7:00 p.m.	Siouxland Mental Health Center, Board Meeting, 625 Court Street
	12:00 p.m.	SIMPCO Board of Directors, 1122 Pierce St, Sioux City, Iowa
WEDNESDAY, OCTOBER 14	8:05 a.m.	Woodbury County Information Communication Commission, Board of Supervisors' Chambers
THURSDAY, OCTOBER 15	11:00 a.m.	Siouxland Regional Transit Systems (SRTS) Board Meeting, SIMPCO Office, 1122 Pierce St., Sioux City, Iowa
TUESDAY, OCTOBER 20	4:30 p.m.	Community Action Agency of Siouxland Board Meeting, 2700 Leech Avenue
WEDNESDAY, OCTOBER 21	12:00 noon	Siouxland Economic Development Corporation Meeting, 617 Pierce St., Ste. 202, Sioux City, Iowa
	10:00 a.m.	Senior Center Board of Directors Meeting, 313 Cook Street

Woodbury County is an Equal Opportunity Employer. In compliance with the Americans with Disabilities Act, the County will consider reasonable accommodations for qualified individuals with disabilities and encourages prospective employees and incumbents to discuss potential accommodations with the Employer.

Federal and state laws prohibit employment and/or public accommodation discrimination on the basis of age, color, creed, disability, gender identity, national origin, pregnancy, race, religion, sex, sexual orientation or veteran's status. If you believe you have been discriminated against, please contact the Iowa Civil Rights Commission at 800-457-4416 or Iowa Department of Transportation's civil rights coordinator. If you need accommodations because of a disability to access the Iowa Department of Transportation's services, contact the agency's affirmative action officer at 800-262-0003.

#4a

SEPTEMBER 8, 2015 — THIRTYSEVENTH MEETING OF THE WOODBURY COUNTY BOARD OF SUPERVISORS

The Board of Supervisors met on Tuesday, September 8, 2015 at 4:00 p.m. Board members present were Clausen, Monson, Ung and Taylor; Smith was absent. Staff members present were Karen James, Board Administrator, Dennis Butler, Finance/Operations Controller, Ed Gilliland, Human Resources Director, Gloria Mollet, Assistant Human Resources Director and Patrick Gill, Auditor/Clerk to the Board.

- 1. Motion by Taylor second by Ung to go into closed session per Iowa Code Section 21.5(1)(a). Carried 4-0 on a roll-call vote.

Motion by Clausen second by Taylor to go out of closed session per Iowa Code Section 21.5(1)(a). Carried 4-0 on roll-call vote.

Motion by Clausen second by Ung to grant a request for \$500.00 to assist an appellant with general relief dollars. Carried 4-0.
- 2. The meeting was called to order – Pledge of Allegiance to the Flag – Moment of Silence.
- 3. There were no citizen concerns.
- 4. Motion by Taylor second by Ung to approve the Agenda for September 8, 2015. Carried 4-0. Copy filed.
- 5. Motion by Taylor second by Ung to approve the minutes of the September 1, 2015 Board meeting. Carried 4-0. Copy filed.
- 6. Motion by Ung second by Taylor to approve the county’s claims totaling \$361,988.81. Carried 4-0. Copy filed.
- 7. Motion by Taylor second by Ung to postpone for two weeks action to approve a request for a Community Attraction and Tourism Grant in support of Cone Park. Carried 4-0. Copy filed.
- 8c. Motion by Clausen second by Taylor to approve Preconstruction Agreement #2016-C-017, project #NHSX-020-1(117)—3H-97, with the Iowa Department of Transportation to construct paved fillets at gravel road intersections along four land US Highway 20. Carried 4-0. Copy filed.
- 8b. Motion by Clausen second by Ung to approve the Preconstruction Agreement #2016-C-018, project #NHSX-020-1(133)—3H-97, with the Iowa Department of Transportation to construct paved fillets at gravel intersections along four lane US Highway 20. Carried 4-0. Copy filed.
- 8a. Bid letting was held at 4:45 p.m. for bridge replacement project L-C(N45)—73-97. The bids are as follows:

Midwest Contraction	\$72,769.00
Peterson Contractors	\$85,474.55
Graves Construction	\$92,230.00
K & L Construction	\$99,590.00

 Motion by Clausen second by Taylor to receive the bids and submit them to Secondary Roads for review and recommendation. Carried 4-0. Copy filed.
- 8d. Motion by Clausen second by Taylor to approve and authorize the Chairperson to sign a Resolution to Revise Woodbury County 2016 Five Year Road Program to add the Port Neal Circle PCC Project to the FY 2016 Construction Program. Carried 4-0.

**RESOLUTION TO REVISE THE WOODBURY COUNTY
2016 FIVE YEAR ROAD PROGRAM
RESOLUTION #12,270**

Unforeseen circumstances have arisen since adoption of the approved Secondary Road Construction Program, and previous revisions, requiring changes to the sequence, funding and timing of the proposed work plan,

The Board of Supervisors of Woodbury County, Iowa, in accordance with Iowa Code section 309.22, initiates and recommends modification of the following project(s) in the accomplishment year (State Fiscal Year 2016), for approval by the Iowa Department of Transportation (Iowa DOT), per Iowa Code 309.23 and Iowa DOT Instructional Memorandum 2.050.

The following approved Priority Year projects shall be ADDED to the Program's Accomplishment year:

Project Number Local ID TPMS #	Project Location Description of work	AAD T Leng th NBIS #	Type Work Fund basis	Accomplishment Year (\$1000's of dollars)		
					New amount	
RC- C097(130) --9A-97	Port Neal Circle, from Pt Neal Rd and Pt Neal Circle, west&sou th 1.672 Miles to AGP and MAE plants, in S30 T87 R48W Pavement replacem ent on Port Neal Circle	740				
Port Neal Circle PCC Replacem ent		1.672 MI	RIS E		\$150 6	
TPMS ID: 34252						
Totals					\$150 6	

Fund ID	Accomplishment year (\$1000's of dollars)		
	Previous Amount	New Amount	Net Change
Local Funds	\$2,280	\$3,033	\$753
Farm to Market Funds	\$1,340	\$1,340	\$0
Special Funds	\$3,590	\$4,343	\$753
Federal Aid Funds	\$1,560	\$1,560	\$0
Total construction cost (All funds)	\$8,770	\$10,276	\$1,506
Local 020 Construction cost totals (Local Funds + BROS-8J FA funds)	\$2,280	\$3,033	\$753

- 8e. Motion by Clausen second by Taylor to approve the contract with Hallett Materials for an estimated 101,000 tons at a price of \$984,100 for project #G-2016-Stockpile. Carried 4-0. Copy filed.
- 9a. Motion by Ung second by Taylor to approve the separation of Jacob Fry, Temporary Summer Laborer, Secondary Roads Dept., effective 8-7-15. End of Temporary Work.; the separation of Shane Funk, Temporary Summer Laborer, Secondary Roads Dept., effective 8-07-15. End of Temporary Work.; the separation of Dillon Hinrickson, Temporary Summer Laborer, Secondary Roads Dept., effective 8-07-15. End of Temporary Work.; the separation of Reed Mitchell, Temporary Summer Laborer, Secondary Road Dept., effective 8-07-15. End of Temporary Work.; and the promotion of Douglas Shupe, District Foreman, Secondary Roads Dept., effective 9-14-15, \$61,838/year. Job Vacancy Posted 6-17-15. Entry Level Salary: \$57,850-\$61,838/year. Carried 4-0. Copy filed.
- 9b. Motion by Ung second by Taylor to authorize the Chairperson to sign the Authorization to Initiate the Hiring Process for Equipment Operator, Secondary Roads Dept., CWA Secondary Roads: \$21.13/hour. Carried 4-0. Copy filed.
- 9c. Motion by Taylor second by Clausen to approve the contract for Northwest Environmental for LEC Mitigation as amended. Carried 4-0. Copy filed.
- 9d. Motion by Taylor second by Ung to approve employee theft insurance coverage. Carried 4-0. Copy filed.
- 10. Motion by Monson second by Taylor to approve a contract with Janet Carl to provide consulting services and an expenditure of up to \$5,500.00 from gaming funds to complete the project. Carried 3-1; Clausen opposed.
- 11a. Motion by Taylor second by Ung to approve an expenditure of \$12,000.00 from gaming funds for a two day training for leaders, elected officials, and department heads for True Speak subject to Board approval of a contract for the services rendered. Carried 3-1; Clausen opposed. Copy filed.
- 11b. The Board discussed Energy CAP pricing and a demonstration.
- 12. Reports on committee meetings.
- 13. There were no citizen's concerns.
- 14. There were no Board concerns or comments.

The Board adjourned the regular meeting until September 15, 2015.

Meeting sign in sheet. Copy filed.

SEPTEMBER 11, 2015-SPECIAL MEETING OF THE WOODBURY COUNTY BOARD OF SUPERVISORS



The Board of Supervisors met on Friday, September 11, 2015, at 9:00 a.m. Board members present were Clausen, Ung, Taylor, and Monson; Smith was absent. Staff members present were Patrick F. Gill, Auditor/Clerk to the Board and Steve Hofmeyer, Deputy Commissioner of Elections.

The meeting was called to order to canvass the Regular School Board Election held in Woodbury County on September 8, 2015.

Steve Hofmeyer, Deputy Commissioner of Elections, announced there was nine (9) after-election ballots and nine (9) provisional ballots which all were accepted and added to the tally. Official Canvass results were as follows:

Lawton-Bronson School Board Director District 1

Rick Scott	Received one hundred twenty-four (124) votes
Candidate Total	One hundred twenty-four (124) votes
SCATTERING	Twenty-three (23) votes
TOTAL	One hundred forty-seven (147) votes

We therefore declare:

Rick Scott duly elected for the office of Lawton-Bronson School Board Director District 1 for the term of 4 years.

Lawton-Bronson School Board Director District 2

Molly Holtz	Received one hundred forty-four (144) votes
Candidate Total	One hundred forty-four (144) votes
SCATTERING	One (1) votes
TOTAL	One hundred forty-five (145) votes

We therefore declare:

Molly Holtz duly elected for the office of Lawton-Bronson School Board Director District 2 for the term of 4 years.

Lawton-Bronson School Board Director District 5

Kristie Amick	Received one hundred forty-six (146) votes
Candidate Total	One hundred forty-six (146) votes
SCATTERING	Two (2) votes
TOTAL	One hundred forty-eight (148) votes

We therefore declare:

Kristie Amick duly elected for the office of Lawton-Bronson School Board Director District 5 for the term of 2 years.

Lawton-Bronson School Board Director District 4

Dennis Reinke	Received eighty-six (86) votes
Amy Ricke	Received seventy-six (76) votes
Candidate Total	One hundred sixty-two (162) votes
SCATTERING	Zero (0) votes
TOTAL	One hundred sixty-two (162) votes

We therefore declare:

Dennis Reinke duly elected for the office of Lawton-Bronson School Board Director District 4 for the term of 4 years.

Lawton-Bronson Question:

Summary: To adopt the revenue purpose statement to replace the current Revenue Purpose Statement and authorize the expenditure of revenues from the State of Iowa secure an advanced vision for education fund received by the Lawton-Bronson Community School District.

In the Lawton-Bronson Community School District, the following Revenue Purpose Statement which specifies the use of the sales, services and use tax funds from the State of Iowa secure an advanced vision for education fund for school infrastructure (penny sales, services and use tax for schools) shall be adopted:

To provide funds for property tax relief.

To provide funds to build and furnish a new school building or buildings; to build and furnish addition(s) to school buildings in the District; to remodel, repair, expand, and improve the school buildings in the District; to purchase and improve grounds; for demolition work; to furnish and equip district facilities.

To provide funds for the purchase, lease or lease-purchase of buildings, equipment (including transportation and recreation equipment), or technology, as authorized by law, to implement energy conservation measures, sharing or rental of facilities, procuring or acquisition of libraries, or opening roads to schoolhouses or buildings.

To provide funds for emergency repairs to respond to natural disasters, such as fire, wind damage, flood; unanticipated mechanical, plumbing, structural, roof, electrical system failures; environmental remediation; or to respond to changes in demographics that require construction of additions or improvements to school buildings or new school buildings.

To provide funds to establish and maintain public recreation places and playgrounds; provide for supervision and instruction for recreational activities; or for community education purposes; and other authorized expenditures and purposes as now or hereafter permitted by law and designated by the Lawton-Bronson Community School District.

To provide funds for the payment of principal and interest or retirement of general obligation bonds issued for school infrastructure purposes, energy improvement loans, loan agreements authorized by Iowa Code section 297.36, sales, service and use tax revenue bonds issued under Iowa Code section 423E.5.

It being understood that if this proposition should fail to be approved by the voters, such failure shall not be construed to terminate or restrict authority previously granted by the voters to expend receipts from the secure an advanced vision for education fund.

If approved, this Revenue Purpose Statement shall remain in effect until replaced or amended by the Lawton-Bronson Community School District.

For the question, there were:	One hundred twenty-four (124) votes
Against the question, there were:	Twenty-four (24) votes
TOTAL	One hundred forty-eight (148) votes

We therefore declare the public measure to be adopted.

Maple Valley-Anthon-Oto School Board Director-District 2

Tammy Flanigan	Received one hundred eleven (111) votes
Laura M. Streck	Received forty-two (42) votes
Candidate Total	One hundred fifty-three (153) votes
SCATTERING	Zero (0) votes
TOTAL	One hundred fifty-three (153) votes

We therefore declare:

Tammy Flanigan duly elected for the office of Maple Valley-Anthon-Oto School Board Director-District 2 for the term of 4 years.

Maple Valley-Anthon-Oto School Board Director-District 4

Robert Clausen	Received one hundred twenty-nine (129) votes
Candidate Total	One hundred twenty-nine (129) votes
SCATTERING	Five (5) votes
TOTAL	One hundred thirty-four (134) votes

We therefore declare:

Robert Clausen duly elected for the office of Maple Valley-Anthon-Oto School Board Director-District 4 for the term of 4 years.

River Valley School Board Director District 2

Nicole Deeds	Received forty-eight (48) votes
James J. Joy	Received forty-four (44) votes
Candidate Total	Ninety-two (92) votes
SCATTERING	Forty-two (42) votes
TOTAL	One hundred thirty-four (134) votes

We therefore declare:

Nicole Deeds duly elected for the office of River Valley School Board Director District 2 for the term of 4 years.

River Valley School Board Director - At Large

Gaylen Goettsch	Received one hundred twenty-eight (128) votes
Candidate Total	One hundred twenty-eight (128) votes
SCATTERING	One (1) votes
TOTAL	One hundred twenty-nine (129) votes

We therefore declare:

Gaylen Goettsch duly elected for the office of River Valley School Board Director - At Large for the term of 4 years.

River Valley School Board Director District 3

Scott Knaack	Received one hundred twenty-six (126) votes
Candidate Total	One hundred twenty-six (126) votes
SCATTERING	One (1) votes
TOTAL	One hundred twenty-seven (127) votes

We therefore declare:

Scott Knaack duly elected for the office of River Valley School Board Director District 3 for the term of 4 years.

Sergeant Bluff-Luton School Board Director

Amiee M. Krogh	Received one thousand sixty-seven (1067) votes
Derek Memmott	Received two hundred fifty-five (255) votes
Jeff W. Wright	Received nine hundred seventy-seven (977) votes
Lonnie Zimmerman	Received six hundred forty-five (645) votes

WRITE-IN

Tammy Matthey	Received seven hundred forty-four (744) votes
Candidate Total	Three thousand six hundred eighty-eight (3688) votes
SCATTERING	Thirty-seven (37) votes
TOTAL	Three thousand seven hundred twenty-two (3722) votes

We therefore declare:

Amiee M. Krogh duly elected for the office of Sergeant Bluff-Luton School Board Director for the term of 4 years.

Tammy Matthey duly elected for the office of Sergeant Bluff-Luton School Board Director for the term of 4 years.

Jeff W. Wright duly elected for the office of Sergeant Bluff-Luton School Board Director for the term of 4 years.

Sergeant Bluff-Luton Question A

Shall the Board of Directors of the Sergeant Bluff-Luton Community School District in the County of Woodbury, State of Iowa, be authorized to contract indebtedness and issue General Obligation Bonds in an amount not to exceed \$45,000,000 to provide funds to build, furnish and equip a new High School building and to improve the site, including construction of an athletic complex; to remodel, repair, improve, furnish and equip the existing High School building for a Middle School building; and to remodel, repair, improve, furnish and equip the existing Middle School building for an Elementary Building?

For the question, there were:	Seven hundred sixty-nine (769) votes
Against the question, there were:	Nine hundred seventy-one (971) votes
TOTAL	One thousand seven hundred forty (1740) votes

We therefore declare the public measure not to be adopted.

Sergeant Bluff-Luton Question B

Shall the Board of Directors of the Sergeant Bluff-Luton Community School District in the County of Woodbury, State of Iowa, be authorized to levy annually a tax exceeding Two Dollars and Seventy Cents (\$2.70) per Thousand Dollars (\$1,000), but not exceeding Four Dollars and Five Cents (\$4.05) per Thousand Dollars (\$1,000) of the assessed value of the taxable property within said school corporation to pay the principal of and interest on bonded indebtedness of said school corporation, it being understood that the approval of this proposition shall not limit the source of payment of the bonds and interest, but shall only operate to restrict the amount of bonds which may be issued?

For the question, there were: Seven hundred thirty-nine (739) votes
 Against the question, there were: Nine hundred eighty-eight (988) votes
TOTAL One thousand seven hundred twenty-seven (1727) votes
We therefore declare the public measure not to be adopted.

Sioux City School Board Director

David Gleiser	Received two thousand fifty-five (2055) votes
Daniel Greenwell	Received one thousand nine hundred fifteen (1915) votes
Robert Henderson	Received one thousand four hundred seventy (1470) votes
Mike Krysl	Received two thousand four hundred sixty-seven (2467) votes
Michael McTaggart	Received two thousand four hundred forty (2440) votes
John Meyers	Received one thousand seven hundred seventy-three (1773) votes
Jacqueline R. Warnstadt	Received two thousand four hundred thirty-four (2434) votes
Candidate Total	Fourteen thousand five hundred fifty-four (14554) votes
SCATTERING	Sixty-two (62) votes
TOTAL	Fourteen thousand six hundred sixteen (14616) votes

We therefore declare:

David Gleiser duly elected for the office of Sioux City School Board Director for the term of 4 years.
 Mike Krysl duly elected for the office of Sioux City School Board Director for the term of 4 years.
 Michael McTaggart duly elected for the office of Sioux City School Board Director for the term of 4 years.
 Jacqueline R. Warnstadt duly elected for the office of Sioux City School Board Director for the term of 4 years.

Westwood School Board Director

Andy Brouillette	Received one hundred four (104) votes
Brandon East	Received ninety-four (94) votes
Jenny Miller	Received ninety-six (96) votes
Candidate Total	Two hundred ninety-four (294) votes
SCATTERING	Four (4) votes
TOTAL	Two hundred ninety-eight (298) votes

We therefore declare:

Andy Brouillette duly elected for the office of Westwood School Board Director for the term of 4 years.
 Brandon East duly elected for the office of Westwood School Board Director for the term of 4 years.
 Jenny Miller duly elected for the office of Westwood School Board Director for the term of 4 years.

Woodbury Central School Board Director

Theresa Archer	Received sixty-eight (68) votes
Gary Frafjord	Received seventy-nine (79) votes
Scott Edward Lamp	Received ninety-one (91) votes
Eric F. Nelson	Received eighty-three (83) votes
WRITE-IN	
Ryan Kluender	Received one hundred four (104) votes
Candidate Total	Four hundred twenty-five (425) votes
SCATTERING	Eight (8) votes
TOTAL	Four hundred thirty-three (433) votes

We therefore declare:

Ryan Kluender duly elected for the office of Woodbury Central School Board Director for the term of 4 years.
 Gary Frafjord duly elected for the office of Woodbury Central School Board Director for the term of 4 years.
 Scott Edward Lamp duly elected for the office of Woodbury Central School Board Director for the term of 4 years.
 Eric F. Nelson duly elected for the office of Woodbury Central School Board Director for the term of 4 years.

Woodbury Central School Board Director-2 Year Vacancy

Jeanene Sampson	Received ninety-three (93) votes
Candidate Total	Ninety-three (93) votes
SCATTERING	Twelve (12) votes
TOTAL	One hundred five (105) votes

We therefore declare:

Jeanene Sampson duly elected for the office of Woodbury Central School Board Director-2 Yr Vacancy for the residual of the

term ending on September 12, 2017.

Motion by Clausen second by Taylor to approve and receive the Official Canvass results. Carried 4-0. Copy filed.

The Board adjourned the meeting.

#6

WOODBURY COUNTY BOARD OF SUPERVISORS AGENDA ITEM(S) REQUIRED

Date: 9-10-15

Weekly Agenda Date: 9-15-15

DEPARTMENT HEAD / CITIZEN: Ed Gilliland

SUBJECT: Memorandum of Personnel Transactions

ACTION REQUIRED:

Approve Ordinance

Approve Resolution

Approve Motion

Give Direction

Other: Informational

Attachments

WORDING FOR AGENDA ITEM: Approval of Memorandum of Personnel Transactions

EXECUTIVE SUMMARY:

BACKGROUND:

FINANCIAL IMPACT:

RECOMMENDATION:

ACTION REQUIRED/PROPOSED MOTION: Motion to Approve the Memorandum of Personnel Transactions

HUMAN RESOURCES DEPARTMENT

MEMORANDUM OF PERSONNEL TRANSACTIONS

DATE: September 15, 2015

* PERSONNEL ACTION CODE:

- A - Appointment
- T - Transfer
- P - Promotion
- D - Demotion
- R - Reclassification
- E - End of Probation
- S - Separation
- O - Other

TO: WOODBURY COUNTY BOARD OF SUPERVISORS

NAME	DEPARTMENT	EFFECTIVE DATE	JOB TITLE	SALARY REQUESTED	% INCREASE	*	REMARKS
Corbiñ, Nolan	Secondary Roads	9-16-15	Temporary Engineering Aide			S	End of Temporary Work.

APPROVED BY BOARD DATE: _____

GLORIA MOLLET, ASST. HR DIRECTOR: Gloria Mollet

WOODBURY COUNTY
HUMAN RESOURCES DEPARTMENT

TO: Board of Supervisors and the Taxpayers of Woodbury County
FROM: Ed Gilliland, Human Resources Director
Gloria Mollet, Human Resources Assistant Director
gmollet
SUBJECT: Memorandum of Personnel Transactions
DATE: September 15, 2015

For the September 15, 2015 meeting of the Board of Supervisors and the Taxpayers of Woodbury County the Memorandum of Personnel Transactions will include:

- 1) Secondary Roads Temporary Engineering Aide, End of Temporary Work.

Thank you

#7a

RESOLUTION #
NOTICE OF PROPERTY SALE

Parcel #178875

WHEREAS Woodbury County, Iowa was the owner under a tax deed of a certain parcel of real estate described as:

**Lot Two Garden View Addition, City of Sioux City, Woodbury County, Iowa
(2820 W. 14th Street)**

NOW THEREFORE,

BE IT RESOLVED by the Board of Supervisors of Woodbury County, Iowa as follows:

1. That a public hearing on the aforesaid proposal shall be held on the **15th Day of September, 2015 at 4:35 o'clock p.m.** in the basement of the Woodbury County Courthouse.
2. That said Board proposes to sell the said parcel of real estate at a public auction to be held on the **15th Day of September, 2015**, immediately following the closing of the public hearing.
3. That said Board proposes to sell the said real estate to the highest bidder at or above a **total minimum bid of \$125.00** plus recording fees.
4. That this resolution, preceded by the caption "Notice of Property Sale" and except for this subparagraph 4 be published as notice of the aforesaid proposal, hearing and sale.

Dated this 1st Day of September, 2015.

ATTEST:

WOODBURY COUNTY BOARD OF SUPERVISORS

Patrick F. Gill
Woodbury County Auditor
and Recorder

Mark A. Monson, Chairman

REQUEST FOR MINIMUM BID

Name: Isaac Curk Date: 3-19-14

Address: _____ Phone: _____

Address or approximate address/location of property interested in:

2820 W. 14th St.

894730102002

**This portion to be completed by Board Administration **

Legal Description:

Lot 2 Garden View Addition

Tax Sale #/Date: 2004-01397 Parcel # 178875

Tax Deeded to Woodbury County on: 12/14/2014

Current Assessed Value: Land \$5,800 Building — Total \$5,800

Approximate Delinquent Real Estate Taxes: \$3,860.00

Approximate Delinquent Special Assessment Taxes: \$2,959.00

*Cost of Services: \$118

Inspection to: George Boykin / Mark Monson Date: _____

Minimum Bid Set by Supervisor: _____

Date and Time Set for Auction: September 15th @ 4:35pm
\$700 - \$125 total

* Includes: Abstractors costs; Sheriff's costs; publishing costs; and mailing costs.



Overview



Legend

- Roads
-  Corp Boundaries
-  Townships
-  Sections
- Residential Sales
-  2013
-  2014
-  2015
-  Parcels

Parcel ID	894730102002	Alternate ID	178875	Owner Address	WOODBURY COUNTY
Sec/Twp/Rng	0-0-0	Class	R		WOODBURY COUNTY COURTHOUSE
Property Address	2820 W 14TH ST	Acreage	n/a		620 DOUGLAS ST
	SIOUX CITY				SIOUX CITY, IA 51101-0000
District	087 SC LL SIOUX CITY COMM				
Brief Tax Description	GARDEN VIEW				
	LOT 2				

(Note: Not to be used on legal documents)

Date created: 8/26/2015
 Last Data Upload: 8/26/2015 12:35:27 AM



Overview



Legend

- Roads
- Corp Boundaries
- Townships
- Sections
- Residential Sales
 - 2013
 - 2014
 - 2015
- Parcels

Parcel ID	894730102002	Alternate ID	178875	Owner Address	WOODBURY COUNTY
Sec/Twp/Rng	0-0-0	Class	R		WOODBURY COUNTY COURTHOUSE
Property Address	2820 W 14TH ST	Acreage	n/a		620 DOUGLAS ST
	SIOUX CITY				SIOUX CITY, IA 51101-0000
District	087 SC LL SIOUX CITY COMM				
Brief Tax Description	GARDEN VIEW				
	LOT 2				
	<i>(Note: Not to be used on legal documents)</i>				

Date created: 8/26/2015
 Last Data Upload: 8/26/2015 12:35:27 AM

 Developed by
 The Schneider Corporation

#76

RESOLUTION #

NOTICE OF PROPERTY SALE

Parcel #781410

WHEREAS Woodbury County, Iowa was the owner under a tax deed of a certain parcel of real estate described as:

**Except Bremer and White tracts of abandoned Railroad Right of Way in Section 4, Township 88, Range 42, Eastwood Rock, Woodbury County, Iowa
(See legal description)**

NOW THEREFORE,

BE IT RESOLVED by the Board of Supervisors of Woodbury County, Iowa as follows:

1. That a public hearing on the aforesaid proposal shall be held on the **15th Day of September, 2015 at 4:37 o'clock p.m.** in the basement of the Woodbury County Courthouse.
2. That said Board proposes to sell the said parcel of real estate at a public auction to be held on the **15th Day of September, 2015**, immediately following the closing of the public hearing.
3. That said Board proposes to sell the said real estate to the highest bidder at or above a **total minimum bid of \$26.00** plus recording fees.
4. That this resolution, preceded by the caption "Notice of Property Sale" and except for this subparagraph 4 be published as notice of the aforesaid proposal, hearing and sale.

Dated this 1st Day of September, 2015.

ATTEST:

WOODBURY COUNTY BOARD OF SUPERVISORS

Patrick F. Gill
Woodbury County Auditor
and Recorder

Mark A. Monson, Chairman

REQUEST FOR MINIMUM BID

Name: Pat Davis Date: 7/31/15

Address: 3640 Indian Hills Dr. ~~231~~ # 231 Phone: 223-4540

Address or approximate address/location of property interested in:

N/A

GIS # 884204200002

**This portion to be completed by Board Administration **

* Class: Commercial 2.09 acres

Legal Description:

Except Bremer and White tracts of abandoned
Railroad right of way in Section 4, Township 28
Range 42 eastward 1/4, Woodbury County, Iowa

Tax Sale #/Date: # 364 6/15/87 Parcel # 781410

Tax Deeded to Woodbury County on: 8/9/91

Current Assessed Value: Land \$22,000- Building Ø Total \$22,000

Approximate Delinquent Real Estate Taxes: Ø

Approximate Delinquent Special Assessment Taxes: Ø

*Cost of Services: \$25-

Inspection to: Mark Monson Date: 7/31/15

Minimum Bid Set by Supervisor: \$100 - Total: \$26-

Date and Time Set for Auction: September 15th - @ 4:37pm

* Includes: Abstractors costs; Sheriff's costs; publishing costs; and mailing costs.

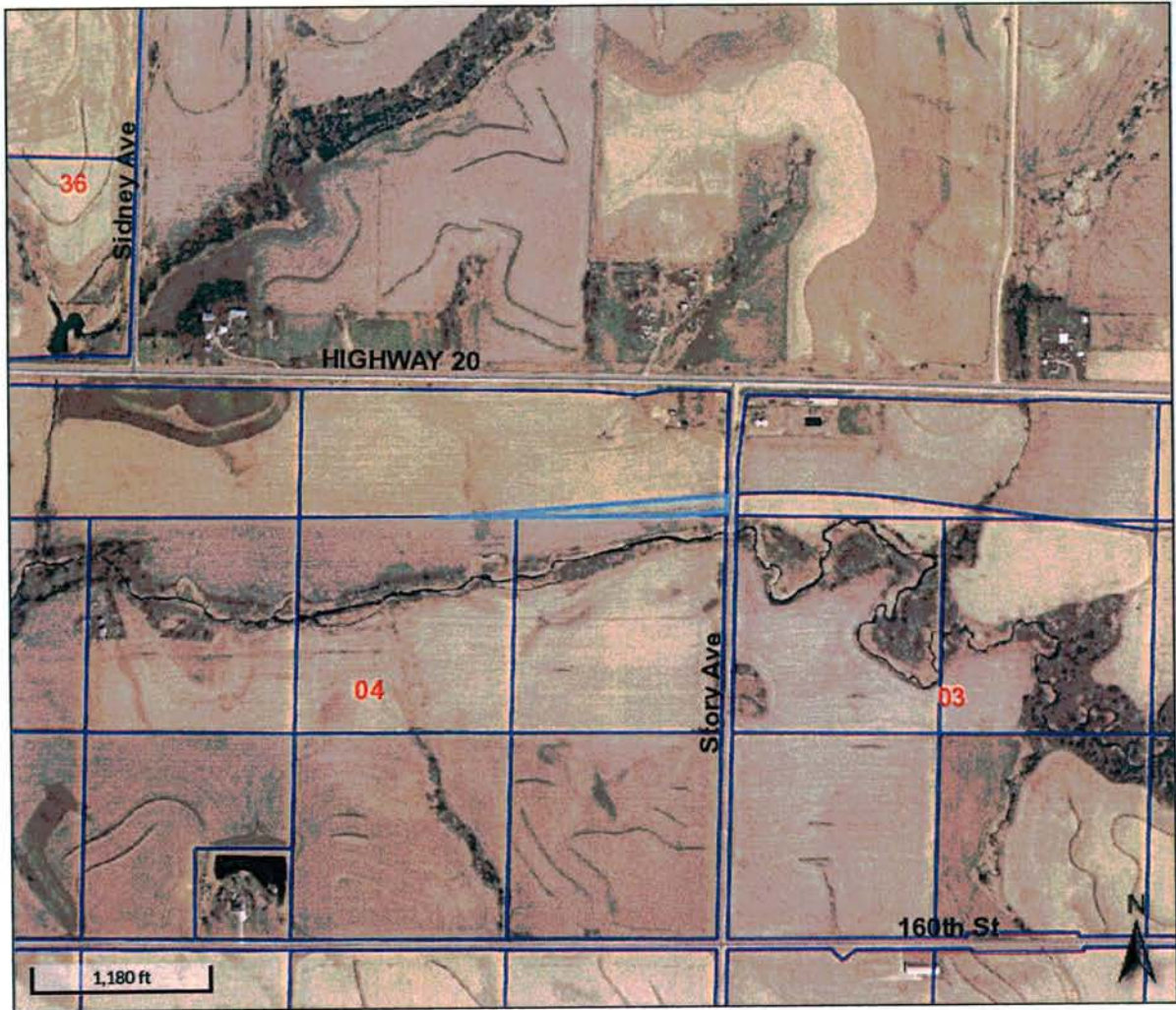

Overview



Legend

- Roads
- Corp Boundaries
- Townships
- Sections
- Residential Sales
 - 2013
 - 2014
 - 2015
- Parcels

Parcel ID	884204200002	Alternate ID	000000000781410	Owner Address	WOODBURY COUNTY
Sec/Twp/Rng	4-88-42	Class	C		620 DOUGLAS ST
Property Address	ROCK	Acreage	n/a		SIOUX CITY, IA 51101-0000

District 017 ROCK RIVER VALLEY CO MM
 Brief Tax Description ROCK TOWNSHIP
 EX BREMER & WHITE TC
 TS ABND RR R/W IN SE
 C 4-88-42
 (Note: Not to be used on legal documents)

Date created: 7/31/2015
 Last Data Upload: 7/31/2015 3:49:26 AM



Overview



Legend

- Roads
- Corp Boundaries
- Townships
- Sections
- Residential Sales
- 2013
- 2014
- 2015
- Parcels

Parcel ID 884204200002 Alternate ID 000000000781410 Owner Address WOODBURY COUNTY
 Sec/Twp/Rng 4-88-42 Class C 620 DOUGLAS ST
 Property Address Acreage n/a SIOUX CITY, IA 51101-0000

District ROCK
 Brief Tax Description 017 ROCK RIVER VALLEY CO MM
 ROCK TOWNSHIP
 EX BREMER & WHITE TC
 TS ABND RR R/W IN SE
 C 4-88-42
 (Note: Not to be used on legal documents)

Date created: 7/31/2015
 Last Data Upload: 7/31/2015 3:49:26 AM

Developed by
 The Schneider Corporation

woodbury County since 1991

was previously owned by Chicago → northwestern Railway

#7c

RESOLUTION #

NOTICE OF PROPERTY SALE

Parcel #786375

WHEREAS Woodbury County, Iowa was the owner under a tax deed of a certain parcel of real estate described as:

**Tri. Comm. 228 ft North of N.E. Corner South ½ SW NE SW Anthon-Oto Comm. Kedron Section 34, Township 88 North, Range 43, West of the Fifth Principal Meridian
(See legal description)**

NOW THEREFORE,

BE IT RESOLVED by the Board of Supervisors of Woodbury County, Iowa as follows:

1. That a public hearing on the aforesaid proposal shall be held on the **15th Day of September, 2015 at 4:39 o'clock p.m.** in the basement of the Woodbury County Courthouse.
2. That said Board proposes to sell the said parcel of real estate at a public auction to be held on the **15th Day of September, 2015**, immediately following the closing of the public hearing.
3. That said Board proposes to sell the said real estate to the highest bidder at or above a **total minimum bid of \$17.00** plus recording fees.
4. That this resolution, preceded by the caption "Notice of Property Sale" and except for this subparagraph 4 be published as notice of the aforesaid proposal, hearing and sale.

Dated this 1st Day of September, 2015.

ATTEST:

WOODBURY COUNTY BOARD OF SUPERVISORS

Patrick F. Gill
Woodbury County Auditor
and Recorder

Mark A. Monson, Chairman

REQUEST FOR MINIMUM BID

Name: Pat Davis Date: 7/31/15
Address: 3640 Indian Hills Dr. # 231 Phone: 223-4540

Address or approximate address/location of property interested in:

N/A

884334300003

Class: Commercial **This portion to be completed by Board Administration**
2 acres

Legal Description:

Tri. Comm. 228 ft North of N.E. Corner South
1/2 SW NE SW Anthon-Oto Comm. Keokuk
Section 34, Township 88 North, Range 43
West of the Fifth Principal meridian

Tax Sale #/Date: # 10 12/3/63 Parcel # 786375

Tax Deeded to Woodbury County on: 2/24/65

Current Assessed Value: Land \$22,000 Building 0 Total \$22,000

Approximate Delinquent Real Estate Taxes: 0

Approximate Delinquent Special Assessment Taxes: 0

*Cost of Services: \$7

Inspection to: Mark Monson Date: 7/31/15

Minimum Bid Set by Supervisor: \$10⁰⁰ - \$17 total

Date and Time Set for Auction: September 15th @ 4:39 pm

* Includes: Abstractors costs; Sheriff's costs; publishing costs; and mailing costs.



Overview



Legend

- Roads
- Corp Boundaries
- Townships
- Sections
- Residential Sales
- 2013
- 2014
- 2015
- Parcels

Parcel ID	884334300003	Alternate ID	00000000786375	Owner Address	WOODBURY COUNTY
Sec/Twp/Rng	34-88-43	Class	C		620 DOUGLAS ST
Property Address		Acreage	n/a		SIOUX CITY, IA 51101-0000
	KEDRON				

District 002 KEDRON ANTHON OTO COMM
 Brief Tax Description KEDRON TOWNSHIP
 TRI COMM 228 FT N OF
 NEC OR S 1/2 SW 34-
 88-43 NE SW
 (Note: Not to be used on legal documents)

Date created: 7/31/2015
 Last Data Upload: 7/31/2015 3:49:26 AM



Overview



Legend

- Roads
- Corp Boundaries
- Townships
- Sections
- Residential Sales
- 2013
- 2014
- 2015
- Parcels

Parcel ID	884334300003	Alternate ID	000000000786375	Owner Address	WOODBURY COUNTY
Sec/Twp/Rng	34-88-43	Class	C		620 DOUGLAS ST
Property Address		Acreage	n/a		SIOUX CITY, IA 51101-0000

District: KEDRON
 Brief Tax Description: 002 KEDRON ANTHON OTO COMM
 KEDRON TOWNSHIP
 TRI COMM 228 FT N OF
 NE COR S 1/2 SW 34-
 88-43 NE SW

(Note: Not to be used on legal documents)

Woodbury County since 1965.

Date created: 7/31/2015
 Last Data Upload: 7/31/2015 3:49:26 AM

#8a

WOODBURY COUNTY BOARD OF SUPERVISORS AGENDA ITEM(S) RECOMMENDATION

Date: September 10, 2015

Weekly Agenda Date: September 15, 2015

DEPARTMENT HEAD / CITIZEN: Mark J. Nahra P.E. Secondary Roads Dept Head/BenKusler Project Engineer

SUBJECT: **Receive and consideration of award of bids for project RCX-CO97(119)—9A-97 (SET TIME 4:40 PM)**

ACTION REQUIRED:

Approve Ordinance

Approve Resolution

Approve Motion

Give Direction

Other: Informational

Attachments

Consideration X

WORDING FOR AGENDA ITEM: Receive and consider bids for PCC Paving of 255th Street and turning lanes on Port Neal Road project RCX-CO97(119)—9A-97

EXECUTIVE SUMMARY: This project is the second phase of the construction of the CF Industries entrance roadway on 255th street and the construction of turning lanes on Port Neal Road to 255th Street.

BACKGROUND: The department solicited bids from seven contractors. This project is in the five year construction program.

FINANCIAL IMPACT: This project is funded within the Construction line item within secondary roads department budget, funded 50% RISE Iowa Dept. of Transportation and 50% local funds through TIF and the Urban renewal district. Total cost is expected to be approximately \$1,500,000.00.

RECOMMENDATION: Recommend that we receive bids and allow engineer to evaluate them and make an award at a later time during this meeting.

ACTION REQUIRED: Motion to receive bids and direct the project engineer to evaluate the bids and return with a recommendation for award at a later time during this meeting.

Approved by Board of Supervisors March 3, 2015.

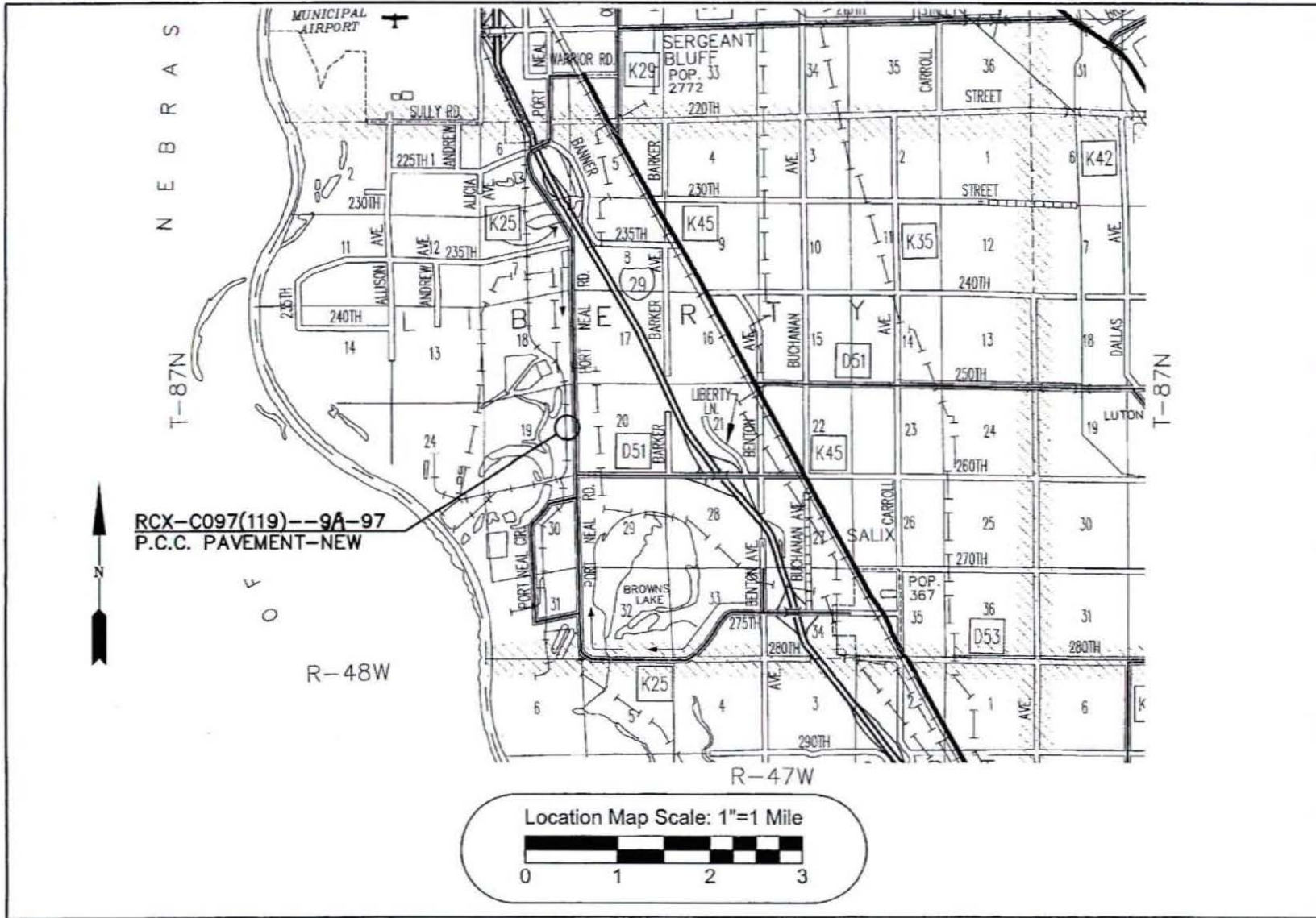

WOODBURY COUNTY ENGINEERS OFFICE	
DESIGNED BY: _____	DATE: _____
DRAWN BY: _____	REVISION: _____
DESIGNED BY: _____	DATE: _____
APPROVED BY: _____	DATE: _____
PROJECT DESCRIPTION: DIVISION I & II OF ENTRANCE ROAD AND PORT NEAL TURNING LANES	
SHEET DESCRIPTION: LOCATION MAP	
PROJECT NO. RCX-C097(119)-9A-97	
SHEET A2	

#86

WOODBURY COUNTY BOARD OF SUPERVISORS AGENDA ITEM(S) RE

Date: September 10, 2015

Weekly Agenda Date: September 15, 2015

DEPARTMENT HEAD / CITIZEN: Mark J. Nahra P.E. Secondary Roads Dept Head/BenKusler Project Engineer

SUBJECT: **Receive and consideration of award of bids for project ER-CO97(124)—58-97 (SET TIME 4:45 PM)**

ACTION REQUIRED:

Approve Ordinance

Approve Resolution

Approve Motion

Give Direction

Other: Informational

Attachments

Consideration X

WORDING FOR AGENDA ITEM: Receive and consider bids for slide repair and RCB culvert extensions on D38 and K64 project ER-CO97(124)—58-97.

EXECUTIVE SUMMARY: This project is repair work authorized by Federal Highway and the Iowa Dept of Transportation as a result of damage in the June 2014 flood event.

BACKGROUND: The department solicited bids from eight contractors. This project is considered maintenance work.

FINANCIAL IMPACT: This project is funded by FEMA 75% State 10% Local 15%

RECOMMENDATION: Recommend that we receive bids and allow engineer to evaluate them and make an award at a later time during this meeting.

ACTION REQUIRED: Motion to receive bids and direct the project engineer to evaluate the bids and return with a recommendation for award at a later time during this meeting.

Approved by Board of Supervisors March 3, 2015.

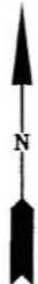

- DDIR-IA-14-01-97-08
- DDIR-IA-14-01-97-10
- DDIR-IA-14-01-97-04
- DDIR-IA-14-01-97-03
- DDIR-IA-14-01-97-07

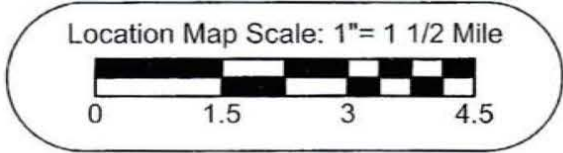
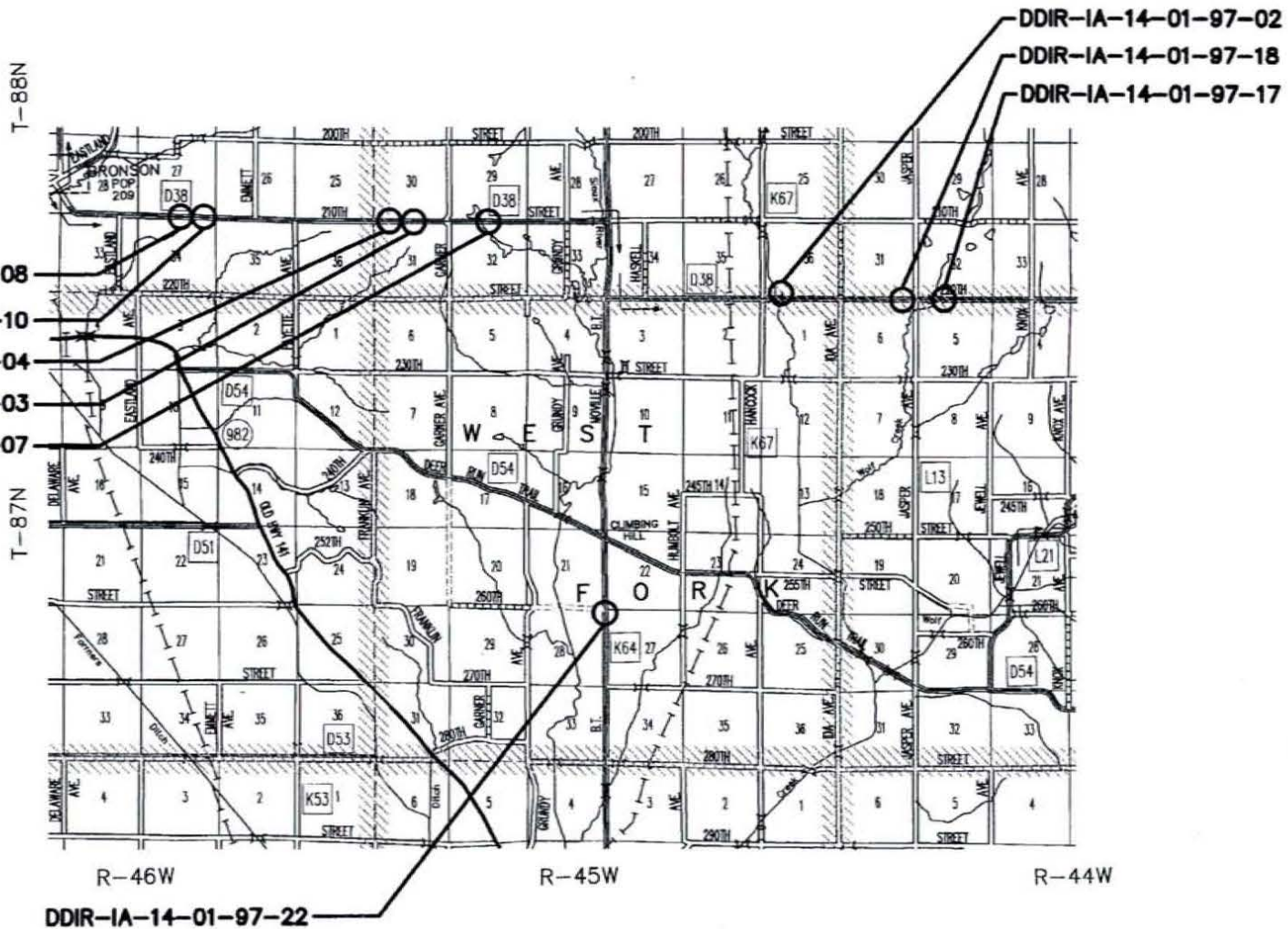

WOODBURY COUNTY
ENGINEERS OFFICE

CMG DRAWN BY:	DATE:
CMG DESIGNED BY:	REVISION:
M/J/N APPROVED BY:	DATE:

PROJECT DESCRIPTION: EMERGENCY SHOULDER AND DRAINAGE REPAIRS ON D38 AND K64

SHEET DESCRIPTION: LOCATION MAP

PROJECT NO.
ER-C097(124)-56-67
SHEET
A2

#9

WOODBURY COUNTY BOARD OF SUPERVISORS AGENDA ITEM(S)

Date: September 9, 2015

Weekly Agenda Date: September 15, 2015

ELECTED OFFICIAL / DEPARTMENT HEAD / CITIZEN: Planning and Zoning – John Pylelo, Director

SUBJECT: Final Platting Referral for Water Dog Addition – a Minor Subdivision

ACTION REQUIRED:

Approve Ordinance

Approve Resolution

Approve Motion

Give Direction

Other: Informational

Attachments

WORDING FOR AGENDA ITEM: Consideration and Referral of Final Platting to Zoning Commission for Public Hearing and Recommendation for Water Dog Addition - a minor subdivision; GIS Parcel #874811300010.

EXECUTIVE SUMMARY: See attached narrative and final platting.

BACKGROUND: See attached narrative. Referral of Final Platting to Zoning Commission for Public Hearing and Recommendation.

FINANCIAL IMPACT: \$200.00 offset by application fee.

RECOMMENDATION: Approve Motion Referring Final Platting to Zoning Commission for Public Hearing and Recommendation.

ACTION REQUIRED / PROPOSED MOTION: Motion to "Refer Final Platting to the Zoning Commission for Public Hearing and Recommendation."



OFFICE OF
Woodbury County Planning & Zoning Director

620 DOUGLAS ST., 6TH FLOOR - SIOUX CITY, IA 51101

John Pylelo - Planning & Zoning Director • jpylelo@sioux-city.org

Peggy Napier - Clerk II • pnapier@sioux-city.org

Telephone (712) 279-6557

Fax (712) 279-6530

To: Board of Supervisors

From: John Pylelo – Planning and Zoning

**Re: Board of Supervisors Meeting
of Tuesday September 15, 2015**

Date: September 9, 2015

Planning and Zoning – John Pylelo, Director

Consideration of Final Platting for Water Dog Addition- a Minor Subdivision with referral to Zoning Commission for Public Hearing and Recommendation; GIS Parcel #874811300010.

Roger and Jean Hassebroek have filed a subdivision application and final platting for a rural Woodbury County parcel. The applicants intend to subdivide 8.09 acres into two (2) lots. The applicants currently reside on the parent parcel within one of the two existing single family dwellings. The applicants wish to subdivide the parcel into two lots in order to place each dwelling on an independent parcel.

The parent parcel lies within rural Woodbury County approximately 9/10 of a mile southwest of the Sioux City corporate limits. The closest intersection is ½ mile to the east at 235th St. and Allison Ave. Location mapping can be found on the attached final plat. The location is within a portion of the NE ¼ of the SW ¼ of Section 11, Liberty West Township.

The parent parcel is zoned GI (General Industrial); is not located within a special flood hazard area; and does not lie within any drainage district. The parcel is serviced by drives addressed 1020 and 1022 235th St. The current and proposed use of the parent parcel and its structures are classified as legal non-conforming uses within the GI zoning district designation and Woodbury County zoning ordinances.

As the use of the parent parcel is residential no CSR value for the parcel is unavailable. CSR values for congruent parcels range from 30.57 to 39.00. This range is below the threshold where county policy discourages subdivision platting approval.

The location is located along graveled right-of-way and will require the recording of a paving agreement pursuant to county paving policy as part of any final plat approval. Further the city of Sioux City can exercise its right to extraterritorial review and final plat approval.

Your Board is asked to consider the final platting referring to the Zoning Commission for public hearing and recommendation.



Overview

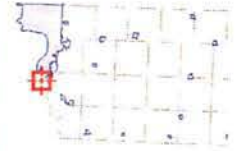

Legend

- Roads
- ▭ Corp Boundaries
- ▭ Townships
- ▭ Sections
- Residential Sales
- ▭ 2013
- ▭ 2014
- ▭ 2015
- ▭ Parcels

Parcel ID	874811300010	Alternate ID	00000000770794	Owner Address	HASSEBROEK ROGER A
Sec/Twp/Rng	11-87-48	Class	R		HASSEBROEK JEAN
Property Address	1020 235TH ST LIBERTY	Acreeage	n/a		1610 REYNOLDS RD #51 LAKELAND, FL 33801-6959

District 038 LIBERTY SGT BLUFF LUTON COMM
 Brief Tax Description LIBERTY TOWNSHIP
 PT NE SW COM NE COR
 THEC S 94.12' TO POB
 ; THEC S 572.33', W
 403.89', N 159.77',
 NWLY 182.1', S 176.
 87', W 326.4', NWLY
 124.33', W; 1.73',
 NWLY 180.2', NELY 2
 62.5', & NEL 734.47
 ' 11-87-48

(Note: Not to be used on legal documents)

Water Dog Addition
 1020-1022 235th St.
 GIS Parcel #874811300010
 NESW Section 11 Liberty West
 Zoned: G1

Date created: 9/9/2015
 Last Data Upload: 9/8/2015 11:18:30 PM

Beacon™ Woodbury County, IA / Sioux City

Summary

Parcel ID 874811300010
Alternate ID 00000000770794
Property Address 1020 235th St
 Liberty
Sec/Twp/Rng 11-87-48
Brief Legal Description LIBERTY TOWNSHIP PT NE SW COM NE COR
 THEC S 94.12' TO POB ; THEC S 572.33', W
 403.89', N 159.77', NWLY 182.12', S 176.87', W
 326.49', NWLY 124.33', W 21.73', NWLY 180.22',
 NELY 2 62.5', & NELY 734.47' 11-87-48
 (Note: Not to be used on legal documents)
Document(s) DED: 599-1402 (6/27/2003)
Gross Acres 0.00
Net Acres 8.09
Exempt Acres -8.09
CSR N/A
Class R - Residential
Tax District 038 LIBERTY SGT BLUFF LUTON COMM
School District SGT BLUFF LUTON



Owner

Primary Owner
 (Deed Holder)
 Hassebroek Roger A
 Hassebroek Jean
 1610 Reynolds Rd #51
 Lakeland, FL 33801-6959
Secondary Owner

Land

Lot Area 8.09 Acres; 352,400 SF

Residential Dwellings

Water Dog Addition
 1020-1022 235th St.
 GIS Parcel #874811300010
 NESW Section 11 Liberty West
 Zoned: G1

Residential Dwelling	
Occupancy	Single-Family / Owner Occupied
Style	1 1/2 Story Frame
Architectural Style	N/A
Year Built	1900
Condition	Very Good
Grade what's this?	5+10
Roof	Asph / Hip
Flooring	L/C
Foundation	Brk
Exterior Material	Vinyl
Interior Material	Drwl
Brick or Stone Veneer	
Total Gross Living Area	1,457 SF
Attic Type	None;
Number of Rooms	6 above; 0 below
Number of Bedrooms	4 above; 0 below
Basement Area Type	None
Basement Area	0
Basement Finished Area	
Plumbing	1 Base Plumbing (Full ; 1 Half Bath;
Appliances	
Central Air	No
Heat	Yes
Fireplaces	1 Masonry;
Porches	1S Frame Enclosed (72 SF);
Decks	
Additions	1 Story Frame (342 SF);
Garages	

Residential Dwelling

Occupancy Single-Family / Owner Occupied

Style 1 Story Frame

Architectural Style N/A

Year Built 1960

Condition Normal

Grade what's this? 4+10

Roof Asph / Hip

Flooring Carp

Foundation C Blk

Exterior Material WOOD

Interior Material Drwl

Brick or Stone Veneer

Total Gross Living Area 2,070 SF

Attic Type None;

Number of Rooms 7 above; 2 below

Number of Bedrooms 4 above; 0 below

Basement Area Type Full

Basement Area 2,070

Basement Finished Area

Plumbing 1 Base Plumbing (Full ; 1 Three Quarter Bath; 1 Half Bath;

Appliances 1 Range Unit; 1 Oven - Single;

Central Air Yes

Heat Yes

Fireplaces 1 Masonry;

Porches

Decks

Additions

Garages 528 SF - Att Frame (Built 1960);

Agricultural Buildings

Plot #	Type	Description	Width	Length	Year Built	Building Count
0	Steel Utility Building	MACHINE SHED	50	100	1960	1
0	Steel Utility Building	MACHINE SHED	35	45	1979	1
0	Steel Utility Building	MACHINE SHED	60	117	1982	1
0	Steel Utility Building	MACHINE SHED	45	45	1982	1
0	Shed - Loafing		10	34	1957	1
0	Crib	CRIB	0	0	1957	2
0	Bin - Grain Storage (Bushel)		0	0	1960	1
0	Barn - Pole		36	96	1951	1
0	Barn - Pole	CATTLE SHED	22	52	1941	1
0	Silo - Concrete	SILO	14	40	1940	1
0	Silo - Concrete	SILO	14	40	1959	1
0	Milk House	MILK ROOM	19	20	1959	1
0	Milking Parlor	MILK PARLOR	18	28	1959	1
0	Shed - Loafing	LOAFING SHED	0	0	1946	1
0	Addition to Bldg	LEG	0	0	1980	1

Yard Extras

#1 - (1) SCREEN PATIO Width=18, Length=21, Quantity=378, Built 2012

Sales

Date	Seller	Buyer	Recording	NUTC	Type	Multi Parcel	Amount
5/22/2001	KROGH MAX E & HELEN ETAL	HASSEBROCK ROGER A & JEAN	492/1309	SALE OF PORTION OF PROPERTY (SPLIT)	Deed	Y	\$132,500.00

+

Valuation

	2015	2014	2013	2012	2011
Classification	Residential	Residential	Residential	Residential	Residential
+ Assessed Land Value	\$25,500	\$25,500	\$25,500	\$25,500	\$25,500
+ Assessed Building Value	\$0	\$0	\$0	\$0	\$0
+ Assessed Dwelling Value	\$209,100	\$209,100	\$208,870	\$206,870	\$206,870
+ Exempt Value	\$0	\$0	\$0	\$0	\$0
= Gross Assessed Value	\$234,600	\$234,600	\$234,370	\$232,370	\$232,370
- Exempt Value	\$0	\$0	\$0	\$0	\$0
= Net Assessed Value	\$234,600	\$234,600	\$234,370	\$232,370	\$232,370

Taxation

	2013	2012	2011	2010
+ Taxable Land Value	\$13,872	\$13,468	\$12,942	\$12,375
+ Taxable Building Value	\$0	\$0	\$0	\$0
+ Taxable Dwelling Value	\$113,626	\$109,262	\$104,990	\$104,582
= Gross Taxable Value	\$127,498	\$122,730	\$117,932	\$116,957
- Military Exemption	\$0	\$0	\$0	\$0
= Net Taxable Value	\$127,498	\$122,730	\$117,932	\$116,957
x Levy Rate (per \$1000 of value)	26.10861	25.98995	25.56737	25.95039
= Gross Taxes Due	\$3,328.80	\$3,189.75	\$3,015.21	\$3,035.08
- Ag Land Credit	\$0.00	\$0.00	\$0.00	\$0.00
- DSC Credit	\$0.00	\$0.00	\$0.00	\$0.00
- Family Farm Credit	\$0.00	\$0.00	\$0.00	\$0.00
- Homestead Credit	(\$126.63)	(\$126.05)	(\$96.72)	(\$79.29)
- Business Property Credit	\$0.00	\$0.00	\$0.00	\$0.00
- Prepaid Tax	\$0.00	\$0.00	\$0.00	\$0.00
= Net Taxes Due	\$3,202.00	\$3,064.00	\$2,918.00	\$2,956.00

Treasurer Link

[Click here to view tax information for this parcel](#)

Tax History

Year	Due Date	Amount	Paid	Date Paid	Receipt
------	----------	--------	------	-----------	---------

Year	Due Date	Amount	Paid	Date Paid	Receipt
2013	March 2015	\$1,601	Yes	2015-02-24	10321
	September 2014	\$1,601	Yes	2014-09-23	
2012	March 2014	\$1,532	Yes	2014-03-17	10362
	September 2013	\$1,532	Yes	2013-09-23	
2011	March 2013	\$1,459	Yes	2013-03-18	10356
	September 2012	\$1,459	Yes	2012-09-19	
2010	March 2012	\$1,478	Yes	2012-03-20	10342
	September 2011	\$1,478	Yes	2011-09-19	

Iowa Land Records

Book-Page: 599-1402 (6/27/2003)

Data for Woodbury County between Beacon and Iowa Land Records is available on the Iowa Land Records site beginning in 1994. For records prior to 1994, contact the County Recorder or Customer Support at www.iowaLandRecords.org.

Photos



Sketches

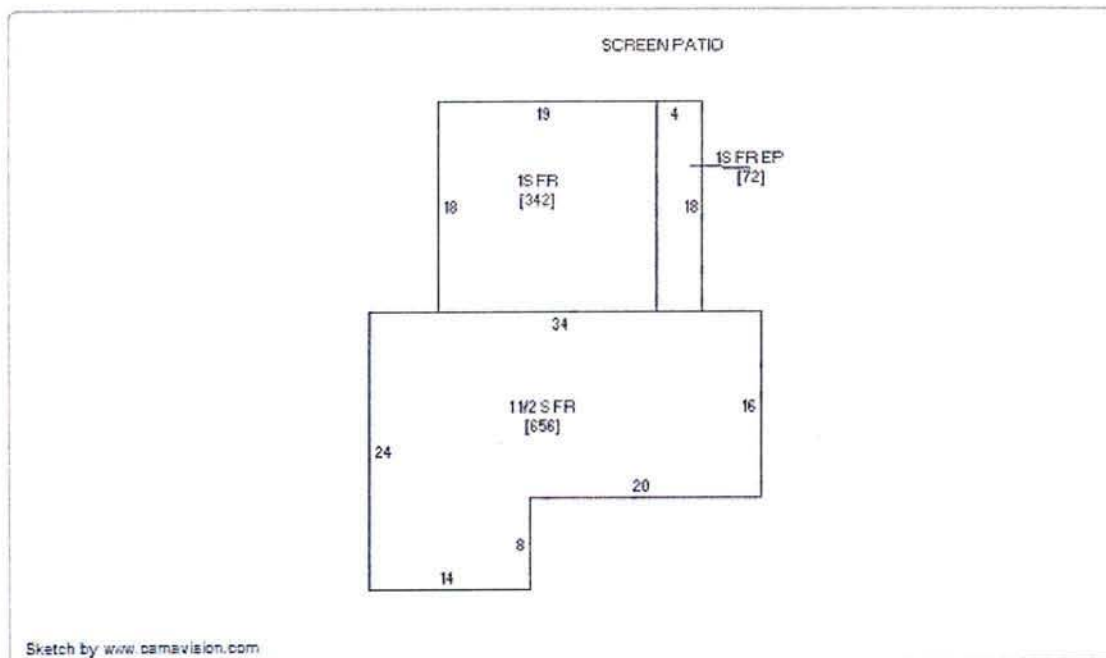

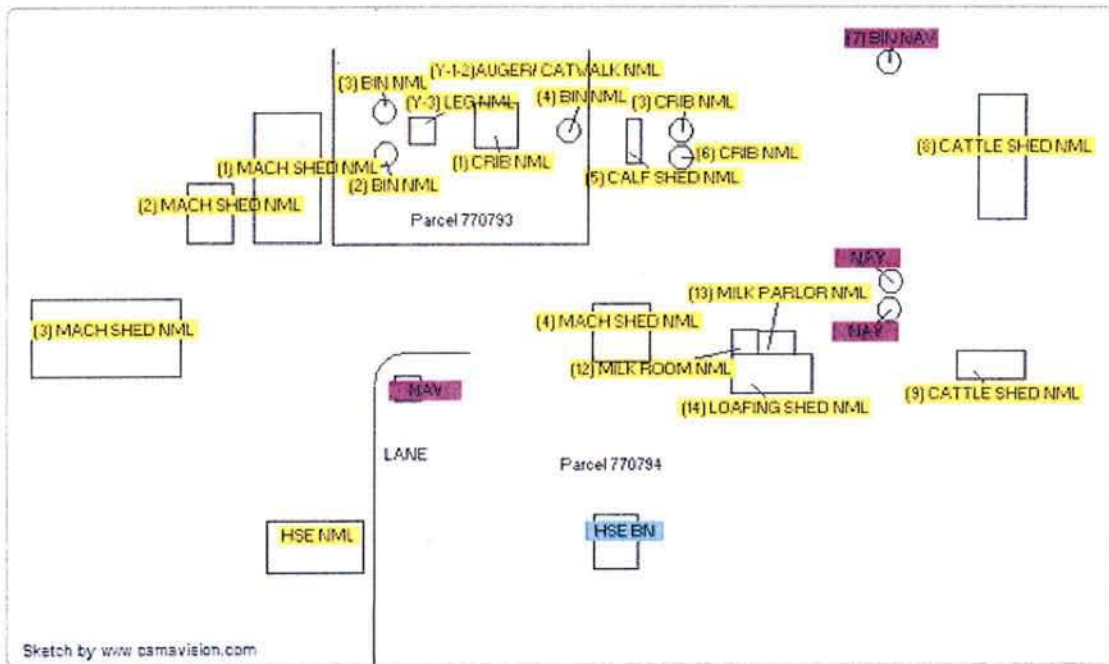
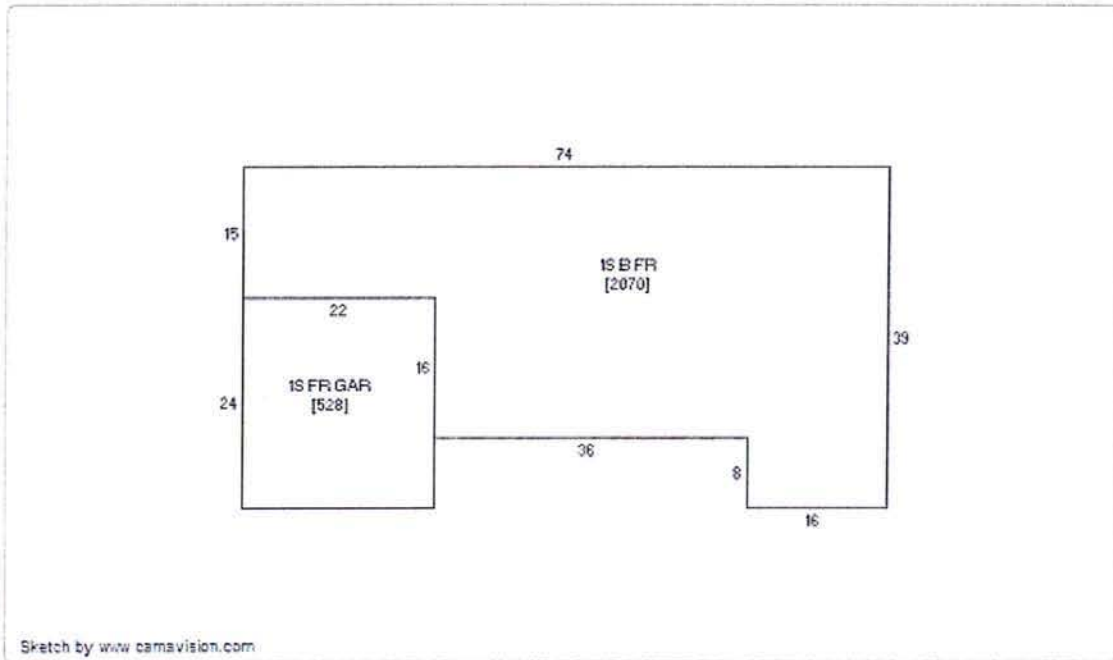

No data available for the following modules: Commercial Buildings, Permits, Valuation (Sioux City), Unpaid Fees and Special Assessments.

The maps and data available for access at this website are provided "as is" without warranty or any representation of accuracy, timeliness, or completeness. There are no warranties, expressed or implied, as to the appropriate use of the maps and data or the fitness for a particular purpose. The maps and associated data at this website do not represent a survey. No liability is assumed for the accuracy of the data delineated on any map, either expressed or implied.

Last Data Upload: 9/8/2015 11:18:30 PM



#10

WOODBURY COUNTY BOARD OF SUPERVISORS AGENDA ITEM(S) R

Date: September 10, 2015

Weekly Agenda Date: September 15, 2015

ELECTED OFFICIAL / DEPARTMENT HEAD / CITIZEN: Kenny Schmitz; Building Services

SUBJECT: EnergyCap

ACTION REQUIRED:

Approve Ordinance

Approve Resolution

Approve Motion

Give Direction

Other: Informational

Attachments

WORDING FOR AGENDA ITEM: Utilities & Energy usage monitoring

EXECUTIVE SUMMARY: EnergyCap System Database Program

BACKGROUND: Database system to allow monitoring of utility consumption

FINANCIAL IMPACT: Based on Database size – "Enterprise System" Annual fee \$5K plus one-time Implementation & Training \$10K – Total Preliminary GSA Pricing Quote per EnergyCap \$16,385.98

RECOMMENDATION: Woodbury County would benefit with the ability to track utility usage. Building Services recommends moving forward with EnergyCap Enterprise.

ACTION REQUIRED / PROPOSED MOTION: Motion to approve Contract with EnergyCap per WICC terms & conditions.



Preliminary GSA Pricing Quote

Prepared for:

County of Woodbury, IA
 620 Douglas Street
 Sioux City, IA 51101

Quote #26615
 September 8, 2015
 EXPIRES IN 90 DAYS

Summary of Product & Service Purchase Fees

Table	Item	Description	Price
1	Software License and Maintenance	EnergyCAP® Enterprise, annual license, no limit on number of users.	\$4,940.00
2	Database Hosting Service	Database to be hosted by Licensee.	-
2	Implementation Services	Project Management, Systems Engineering, and Implementation Assistance on all facets of implementation of licensed features.	\$10,374.00
2	Training Services	Training Services performed by assigned project manager.	\$950.00
2	Bill CAPture Service	Initial enrollment and setup of service and first year bill processing service fee.	-
		Industrial Funding Fee (0.75%)	\$121.98
TOTAL FIRST YEAR FEE			\$16,385.98

Estimated Three-Year Fee Summary

The prices in the following Three-Year Cost Summary are based on the software features and services listed in Tables 1 & 2 below.

Item	Year One	Year Two	Year Three
Software License and Maintenance	\$4,940.00	\$4,940.00	\$4,940.00
Database Hosting Service	-	-	-
Implementation Services	\$10,374.00	-	-
Training Services	\$950.00	-	-
Bill CAPture Service	-	-	-
Industrial Funding Fee (0.75%)	\$121.98	\$37.05	\$37.05
Total	\$16,385.98	\$4,977.05	\$4,977.05

Product & Service Purchase Details

The following items are included in the Total Initial Fee quoted above:

Table 1: Software License and Maintenance

Product and Scope Details	
EnergyCAP Enterprise	6.3 or latest
EnergyCAP Web Client	3.3 or latest
Licensed Number of Users	Unlimited
Licensed Number of Meters* (see Terms and Conditions #2)	250
Approx. Number of Buildings	TBD
Type of Buildings	Government
Approx. Commodities to be Tracked	Electric, Natural Gas, etc.

Base Software License Features (see Terms and Conditions #3)			\$3,800.00
Account & Meter Tracking	Project Tracking	Budgets & Forecasts	
Benchmarking Charts	Reports, Charts & Graphs	Counters	
Bill Audits	Setup Wizards	Custom Spreadsheets	
Data Import Templates	Supported APIs	Energy Contract Administration	
Electronic Bill Import	Target Comparison	Energy Procurement	
Energy Dashboard	Tree View Navigation	Issue Tracker	
ENERGY STAR Benchmarking	User Permissions	Rate/Tariff Analysis	
Greenhouse Gas Tracking	Weather Data	Report Distribution	
PowerViews™	Workflow Management	Unit System (Editing)	

Advanced Software License Features (see Terms and Conditions #3)	\$1,140.00
Cost Avoidance (M&V), Calendarization & Normalization, Energy Use Intensity, Use vs Weather	\$1,140.00

EnergyCAP Maintenance Agreement (ECMA)	
Upon the one-year anniversary of software installation, Licensee will have the option of continuing the Maintenance Agreement for successive one-year periods. The Maintenance Agreement provides technical support, regular software upgrades, and access to Weather Data, Greenhouse Gas conversion factors, and the ENERGY STAR interface to Portfolio Manager.	Included in annual license fee

Table 2: Professional Services

Project Implementation Services	Project management, systems engineering, and professional assistance on the implementation of licensed features.	\$10,374.00
Online Training:	5 Online Sessions	\$950.00
	One hour on-line training sessions using an online web conferencing service and conference call.	\$950.00
Training Videos:		No Fee

Table 3: Project and Invoicing Schedule (see Terms and Conditions #12)

Activity	Start Week	End Week	Project Timeline	Invoice Schedule	Amount
Acceptance	0	0			
Remote Kickoff Meeting	1	1			
Implementation database installed at ECI	1	1			
EnergyCAP Software installed & tested at Licensee site	2	2		Software License: 50%	\$2,470.00
				Database Hosting: 100%	-
				Implementation Services: 25%	\$2,593.50
Data collection—identify required data, available data, and data sources	1	8			
Setup of billing templates and workflow	1	8			
Entry of setup data (facilities, organizational structure, accounts, meters)	1	12			
Entry of electronic historical billing data	12	18			
Development of data interfaces (if purchased)	6	20			
Live data processing of a current utility bill in other than a testing, training, or demonstration mode	20	20		Software License: 40%	\$1,976.00
				Implementation Services: 50%	\$5,187.00
				Bill CAPture Service: 100%	-
Training Sessions—upon completion of all sessions	16	24		Training Services: 100%	\$950.00
Knowledge Transfer Document provided to Licensee	24	24			
Transfer production database to Licensee (if Licensee hosting)	24	24			
Project Completion	24	24		Software License: 10%	\$494.00
				Implementation Services: 25%	\$2,593.50
Software License, Maintenance and Support—upon the annual date of the initial software installation	54	54		Annual Maintenance: 100%	\$4,940.00

Optional Products & Services

The following items are not included in the Total Initial Fee, and Licensee is not obligated to purchase the items at any time. Prices quoted for all optional items are valid for a period of three years after the initial purchase date. Prices are subject to change after the initial three-year period. The license, implementation, and annual maintenance fees will be adjusted accordingly, with updated prices to be reflected in invoices from ECI to Licensee.

Software License

Item	Software License Fee	Professional Services Fee	Total Initial Fee	Annual Maintenance Fee *
Meter Growth: Block of 100 Meters	\$1,482.00	\$142.50/Hour	\$1,482.00	\$1,482.00
Accounts Payable or G/L Export	\$950.00	\$1,330.00	\$2,280.00	\$950.00
Bill Accruals	\$1,900.00	\$2,660.00	\$4,560.00	\$1,900.00
Chargebacks, Submeters, Bill Splits, Formulas	\$1,520.00	\$3,192.00	\$4,712.00	\$1,520.00
Report Designer	\$1,495.00	\$750.00	\$2,245.00	\$1,495.00
Interval Data, Meter Data Import	\$950.00	\$1,330.00	\$2,280.00	\$950.00

Professional Services

Item	Rate	Total Fee
Catalyst: Comprehensive User Group Training Session. Next is April, 2016; for more details go to www.EnergyCAPCatalyst.com	Registration Fees Apply	-
Database Hosting	\$2,375 or \$0.95/meter	\$2,375.00
Database Conversion, TBD Format, for up to TBD Years	\$142.50/Hour	\$3,000-\$7,000
Development of Interface to TBD Accounting System	\$190/Hour	\$5,500-\$7,500
Development of Interface to TBD Metering System	\$190/Hour	\$3,500-\$5,500
Development of Custom Report	\$190/Hour	\$2,000-\$5,000
Onsite Training	\$5,500/Two-Day Session	-
Online Training	\$190/Hour	-
Bill CAPture Bill Processing Services	\$2-\$3/Transaction; \$5-\$10/Meter Enrollment	-

* Will be added to the next renewal period.

Terms and Conditions

1. This quote and product pricing are the proprietary property of EnergyCAP, Inc. (ECI), are provided to the recipient at recipient's request, and may not be divulged to any third parties.
2. A meter is a point of service as itemized on the bill and tracked in EnergyCAP as a meter/logical device and includes points of service for which no physical meter exists, such as sewer, fire lines, outdoor lighting, fuel oil tanks, storm drainage, ISP and telephone service, etc. Meter records that are used in split, calculated, and virtual bill processes for Chargeback and Cost Allocation purposes are included in the total meter count. Growth in scope of meter count of up to the licensed amount in Table 1 is permitted. Growth beyond the amount listed in Table 1, whether due to reorganization, merger, acquisition, etc., exceeds the pricing considerations, and ECI reserves the right to charge the software license and annual maintenance fees listed in the Optional Products & Services table with prior Licensee authorization.
3. Base and Advanced Software Features comply with the detailed feature descriptions and explanations shown at www.EnergyCAP.com/Products for this version of the licensed software.
4. Operating systems, Microsoft SQL Server, and hardware of any kind are not included.
5. For the Enterprise version, if Licensee hosts or for ECI hosted versions, if Licensee elects to download the Installed Client, software installation will be accomplished by Licensee. ECI will assist in software installation via phone and email technical support.
6. Implementation assistance for hourly projects: If Licensee options ECI to provide hourly implementation assistance instead of project-based, hours must be used within 120 calendar days from initial assistance. Expired hours can be reactivated for 25% of the purchase price. If implementation assistance and support is needed beyond the level of service purchased in this Agreement, ECI can quote a fee based on the scope of work at a billable rate of \$142.50/hour.
7. Licensee is responsible for delivering complete custom development specifications to ECI before commencement of development services. ECI will develop deliverables in the agreed upon timeframe as outlined the project schedule. Delivered items will be referenced as functional deliverables. Upon request, ECI will provide up to two iterations of functional deliverables as long as the scope change is minimal and in sum amount less than 10% of the total cost of the deliverable. Each iteration must be requested by Licensee within a four-week period from first delivery of the functional deliverable. If the iterations exceed 10%, if Licensee requests more than two iterations, or if the timeframe exceeds four weeks from original delivery date, then ECI shall provide a quotation to Licensee for services at ECI's then-current rates for services.
8. Hosting service: If Licensee options ECI to provide database hosting services, ECI will host Licensee's database on hardware owned and maintained by ECI. Equipment is located in Pittsburgh, PA in a commercial co-location facility that has secure access, redundant high speed Internet access, and redundant power supply. Databases will be backed up nightly to on-site and off-site locations. Ownership of proprietary EnergyCAP SQL database schema resides with ECI. (Database schema includes database design elements, to include: table and field design; indexes and triggers; stored procedures, scripts and views.) ECI shall treat Licensee databases as confidential information and shall not release, divulge, or provide access to data by any third parties without the prior consent of Licensee. Guaranteed system availability is 98% during customary Eastern Time Zone office hours. Licensee shall be entitled to a credit of \$500 on the next invoice if system availability in any calendar quarter falls below 98% for that quarter. ECI can store bill images on hosted servers; additional annual fee of \$0.05/bill applies. If additional non-production databases are needed for testing and/or demo purposes, an additional per database fee applies. ECI reserves the right, upon approval by Licensee, to charge additional fees for services outside of the normal hosting services (services for remote desktop access, custom backup processes, scheduled tasks, etc.).
9. ECI reserves the right to increase annual fees each year not to exceed 3% or the then current CPI, whichever is greater.
10. The End-User EnergyCAP Software License Purchase Agreement, EnergyCAP Software License Agreement, EnergyCAP Maintenance Agreement, EnergyCAP Software Implementation Services Agreement, EnergyCAP Database Hosting Service Agreement, and EnergyCAP Bill CAPture Service Agreement are incorporated herein and are available upon request from EnergyCAP, Inc. and at www.EnergyCAP.com/Legal.
11. Bill CAPture Service: Licensee has the option to subscribe to the Bill CAPture bill processing service. Licensee must maintain an active and current ECMA in order to subscribe to the Bill CAPture service. Licensee is responsible for all EnergyCAP data revisions and maintenance including but not limited to: the creation of new accounts, meters, places, and vendors, managing account number changes, and taking action on bill kick-out reports. ECI and Licensee will schedule a time for initiation of the enrollment process. If the total number of meters enrolled in the service or the total number of transactions processed exceeds the maximum limits listed in Table 2, ECI shall provide a quotation to Licensee for the following fees:
TBD/Meter and TBD/Transaction
12. The Project and Invoicing Schedule is preliminary. The timeline is highly dependent on the receipt of usable data from Licensee. Most implementation projects take between four and eight months from the project Kickoff Meeting to Project Completion. Times can vary, and a detailed project schedule for licensee's specific project will be provided after the Kickoff Meeting. Invoicing Schedule terms is net 30 days; 1% per month late fee may be applied.

Acceptance

To order, please sign and return this page, provide a purchase order or payment referencing this Quote form, or request a formal proposal that includes all license agreements from your EnergyCAP, Inc. account executive.

I signify that I am an authorized representative of the organization named above. My signature below confirms the organization's intent to purchase the above-noted products and services ("Products") and authorizes EnergyCAP, Inc. ("ECI") to deliver and invoice for the Products under the Terms & Conditions outlined herein.

Signature: _____
Date: _____
Name: _____
Title: _____
PO #: _____

WOODBURY COUNTY BOARD OF SUPERVISORS AGENDA ITEM(S) REQUEST



Date: September 9, 2015

Weekly Agenda Date: September 15, 2015

ELECTED OFFICIAL / DEPARTMENT HEAD / CITIZEN: Supervisors Matthew Ung and Jeremy Taylor

SUBJECT: Use of Local Option Sales Tax for Economic Development

ACTION REQUIRED:

Approve Ordinance

Approve Resolution

Approve Motion

Give Direction

Other: Informational

Attachments

WORDING FOR AGENDA ITEM: Approval of a resolution sunsetting the "Investing in Woodbury County" Loan Program

EXECUTIVE SUMMARY: We believe in the name of fairness and greater economic impact that the low-interest revolving Loan Program has fulfilled its purpose and should sunset. We are also cognizant that even in recent weeks, the county has been asked for contributions to economic development projects ranging from \$75,000 to \$2,000,000, and having funds from a revolving loan program already "tied up" for several years can present a hindrance to their full consideration. We believe the intent of Local Option Sales Tax (LOST) dollars for economic development is for the public good. Low-interest loans to private citizens for their own business expansions don't necessarily hurt Woodbury County, and they aren't necessarily bad decisions—but we believe they may not be the best decisions. Furthermore, it is misleading for us as a County Board to claim we have "created" one or a couple jobs when our loans are typically not the primary source of funds, but secondary, tertiary, etc... How do we know that part-time job (for instance) wouldn't already be created?

Five years after inception, and after the recession, we don't believe spending further tax dollars to advertise preferential loan terms to entrepreneurs is our place, especially considering Siouxland Economic Development Corporation's capable role in this area. Considering the county's income streams are very limited/inflexible, speculation should not be our role. *Loaning funds out below any bank's rate represents a loss to the taxpayers funding the loan.*

BACKGROUND: The Loan Program was created in 2010 after the 2008-2009 recession. Although \$1 million was intended, four loans have been approved, all at a 2% rate and totaling \$359,000. No loans were given out in FY 2014.

FINANCIAL IMPACT: We intend continued use of Local Option Sales Tax for economic development, but for public rather than private benefit. In accordance with the resolution's action to rescind commitment of \$400,000 in LOST funds to the Loan Program, LOST funds unallocated for FY 2016 would rise dramatically from \$151,653 to \$551,653.

The four current loans already begun will not be affected in any way and their repayments will still go to the fund established.

ACTION REQUIRED / PROPOSED MOTION: "I move to approve the resolution."

Approved by Board of Supervisors March 3, 2015. Revised May 5, 2015.

RESOLUTION NO _____

A RESOLUTION ELIMINATING THE

“INVESTING IN WOODBURY COUNTY” LOAN PROGRAM

WHEREAS, the “Investing in Woodbury County” Loan Program was created by Resolution #10,691 on July 20, 2010 to benefit private business owners “and in order to offer local solutions to the national economic recession”; and

WHEREAS, a goal of up to \$1M in low-interest loans of 2% was established in a revolving loan fund, with current loan lengths ranging from 5-10 years; and

WHEREAS, Woodbury County appreciates the Siouxland Economic Development Corporation, which not only assists the county’s loan program with screening and all loan recommendations, but manages a much larger private loan program, and therefore Woodbury County finds its own revolving loan program to be of diminished use; and

WHEREAS, Woodbury County’s practice of being a partial lender gives no guarantee whether the low-interest loans they approve create jobs that would have otherwise already been created, or if taxpayers are comfortable with a limited number of businesses being granted loans below market rate, in some cases for business expansion rather than creation; and

WHEREAS, Woodbury County funding for economic development projects that service the public good over private interests are in high demand and will continue to be so;

NOW THEREFORE, BE IT RESOLVED BY THE BOARD OF SUPERVISORS OF WOODBURY COUNTY, IOWA that the program created by Resolution #10,691 is eliminated; and

BE IT FURTHER RESOLVED that the action taken by the Woodbury County Board of Supervisors on Feb. 24, 2015 to allocate a total of \$400,000 of Local Option Sales Tax funds to the Loan Program is hereby rescinded.

BE IT SO RESOLVED this 15th day of September, 2015.

WOODBURY COUNTY BOARD OF SUPERVISORS

Mark A. Monson, Chairman

Attest: Patrick F. Gill, Woodbury County Auditor

#12a

WOODBURY COUNTY BOARD OF SUPERVISORS AGENDA ITEM(S) REQUEST

Date: September 10, 2015

Weekly Agenda Date: September 15, 2015

DEPARTMENT HEAD / CITIZEN: Mark J. Nahra P.E. Secondary Roads Dept Head/BenKusler Project Engineer

SUBJECT: **Consideration of award of Bids for Project No. L-C(N48)—73-97**

ACTION REQUIRED:

Approve Ordinance

Approve Resolution

Approve Motion

Give Direction

Other: Informational

Attachments

Consideration X

WORDING FOR AGENDA ITEM: Consideration of award of bids to replace short span bridge project L-C(N48)—73-97

EXECUTIVE SUMMARY: This project was let for bid on September 8, 2015. Bids were opened at the Board meeting. The low bid was from Midwest Contracting of Marshall, Minnesota.

BACKGROUND: The department solicited bids from ten contractors. This culvert is in the five year construction program.

FINANCIAL IMPACT: This project is funded within the Construction line item within secondary roads department budget.

RECOMMENDATION: Recommend award of the low bid from Midwest Contracting.

ACTION REQUIRED: Motion to accept and award the bid to Midwest Contracting for replacement of a short span bridge culvert for \$72,769.00

Approved by Board of Supervisors March 3, 2015.

L-C(N48)--73-97

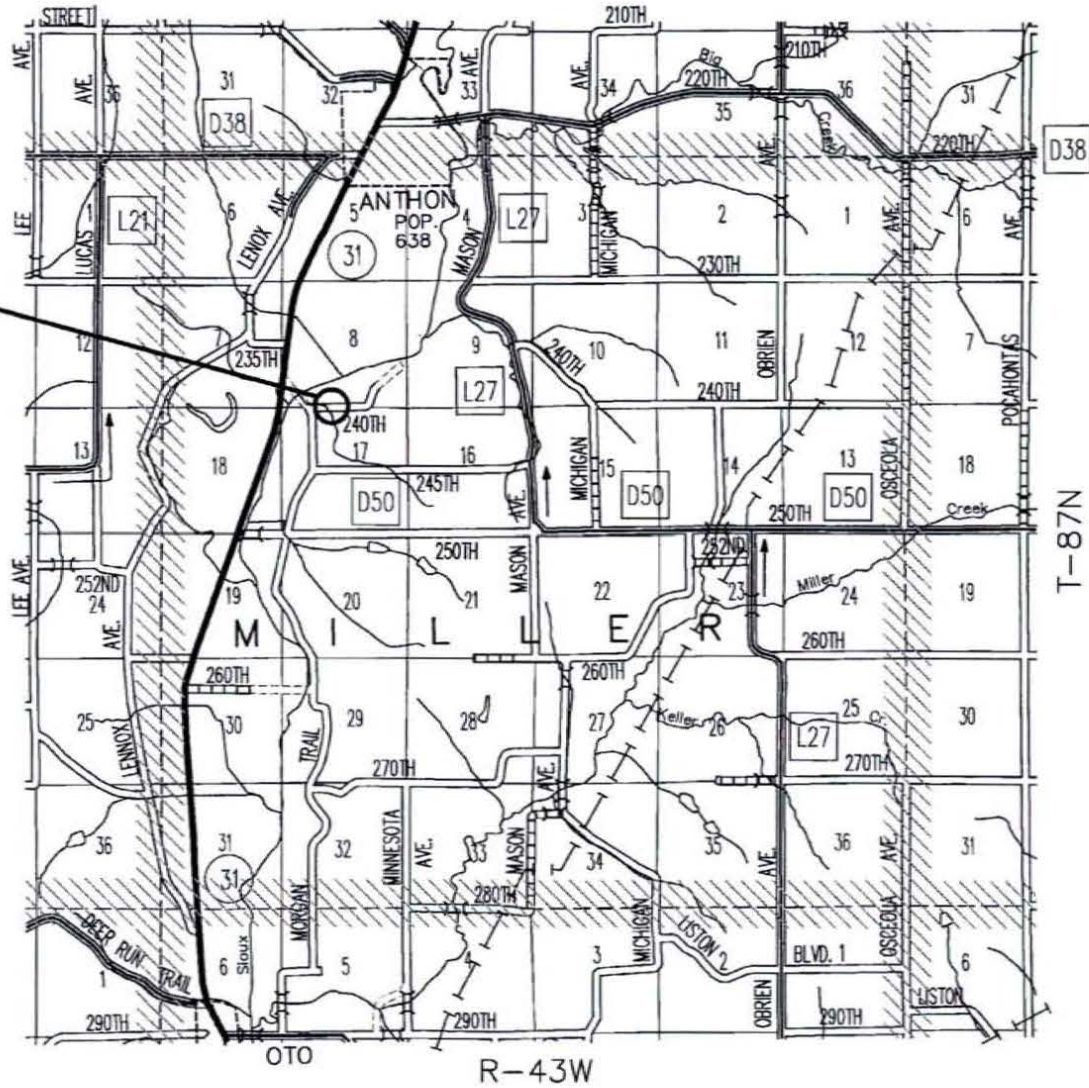
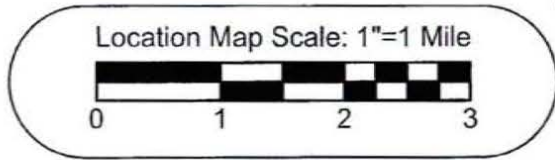

WOODBURY COUNTY ENGINEERS OFFICE	
CMG DRAWN BY:	DATE:
CMG DESIGNED BY:	REVISION:
MLK APPROVED BY:	
PROJECT DESCRIPTION: BRIDGE REPLACEMENT WITH PRECAST RCB NORTH LINE SEC. 17, T87N, R43W	
SHEET DESCRIPTION: LOCATION MAP	
PROJECT NO. L-C(N48)--73-97	
SHEET A2	

PROJECT NO. L-C(N48)-73-97
 LETTING: TUESDAY, September 8, 2015
 BRIDGE REPLACEMENT WITH RCB
 IN SECTION 17 T87N, R43W

NOTE: IN CASE OF MATHEMATICAL ERROR, UNIT PRICE SHALL GOVERN

		Engineer's Estimate		K&L Construction		Peterson Contractors		Midwest Contracting			
		BID BOND		BID BOND		BID BOND		BID BOND			
ITEM NO.	ITEM	QUANTITIES	UNIT PRICE	AMOUNT	UNIT PRICE	AMOUNT	UNIT PRICE	AMOUNT	UNIT PRICE	AMOUNT	SUMMARY OF BIDS
1	Clearing and Grubbing	0.15 Acres	\$ 5,000.00	\$ 750.00	\$ 10,000.00	\$ 1,500.00	\$ 12,500.00	\$ 1,875.00	\$ 6,000.00	\$ 900.00	1) Midwest Contracting \$ 72,769.00
2	Excavation Class 10 Rdwy & Borrow	178 Cu.Yds.	\$ 14.00	\$ 2,492.00	\$ 20.00	\$ 3,560.00	\$ 10.85	\$ 1,931.30	\$ 15.00	\$ 2,670.00	2) Peterson Contractors \$ 85,474.55
3	Excavation Class 10 Channel	45 Cu. Yds.	\$ 20.00	\$ 900.00	\$ 30.00	\$ 1,350.00	\$ 10.85	\$ 486.25	\$ 15.00	\$ 675.00	3) Graves Construction \$ 92,230.00
4	Removal of Existing Bridge	1 L.S.	\$ 20,000.00	\$ 20,000.00	\$ 7,500.00	\$ 7,500.00	\$ 4,000.00	\$ 4,000.00	\$ 6,500.00	\$ 6,500.00	4) K&L Construction \$ 99,590.00
5	Granular Backfill	12 Cu.Yds.	\$ 60.00	\$ 720.00	\$ 65.00	\$ 780.00	\$ 103.00	\$ 1,236.00	\$ 65.00	\$ 780.00	5) Engineer's Est. \$ 104,192.00
6	Excavation Class 20 For Rdwy Box Culvert	140 Cu. Yds.	\$ 15.00	\$ 2,100.00	\$ 25.00	\$ 3,500.00	\$ 15.50	\$ 2,170.00	\$ 15.00	\$ 2,100.00	6)
7	Precast Concrete Box Culvert 10' x 5'	30 L.F.	\$ 1,000.00	\$ 30,000.00	\$ 1,200.00	\$ 36,000.00	\$ 1,085.00	\$ 32,550.00	\$ 850.00	\$ 25,500.00	7)
8	Precast Concrete Box Culvert End Section	2 Each	\$ 9,500.00	\$ 19,000.00	\$ 12,000.00	\$ 24,000.00	\$ 11,600.00	\$ 23,200.00	\$ 9,500.00	\$ 19,000.00	
9	Revetment Class E	62 Ton	\$ 65.00	\$ 4,030.00	\$ 100.00	\$ 6,200.00	\$ 52.00	\$ 3,224.00	\$ 62.00	\$ 3,844.00	
10	Safety Closure	2 Each	\$ 600.00	\$ 1,200.00	\$ 350.00	\$ 700.00	\$ 150.00	\$ 300.00	\$ 100.00	\$ 200.00	
11	Traffic Control	1 L.S.	\$ 3,000.00	\$ 3,000.00	\$ 2,500.00	\$ 2,500.00	\$ 2,500.00	\$ 2,500.00	\$ 1,600.00	\$ 1,600.00	
12	Mobilization	1 L.S.	\$ 20,000.00	\$ 20,000.00	\$ 12,000.00	\$ 12,000.00	\$ 12,000.00	\$ 12,000.00	\$ 9,000.00	\$ 9,000.00	
TOTAL				\$ 104,192.00		\$ 99,590.00		\$ 85,474.55		\$ 72,769.00	
		Graves Construction									
ITEM NO.	ITEM	QUANTITIES	UNIT PRICE	AMOUNT	UNIT PRICE	AMOUNT	UNIT PRICE	AMOUNT	UNIT PRICE	AMOUNT	
1	Clearing and Grubbing	0.15 Acres	\$ 30,000.00	\$ 4,500.00		\$ -		\$ -		\$ -	
2	Excavation Class 10 Rdwy & Borrow	178 Cu.Yds.	\$ 15.00	\$ 2,670.00		\$ -		\$ -		\$ -	
3	Excavation Class 10 Channel	45 Cu. Yds.	\$ 10.00	\$ 450.00		\$ -		\$ -		\$ -	
4	Removal of Existing Bridge	1 L.S.	\$ 8,000.00	\$ 8,000.00		\$ -		\$ -		\$ -	
5	Granular Backfill	12 Cu.Yds.	\$ 125.00	\$ 1,500.00		\$ -		\$ -		\$ -	
6	Excavation Class 20 For Rdwy Box Culvert	140 Cu. Yds.	\$ 20.00	\$ 2,800.00		\$ -		\$ -		\$ -	
7	Precast Concrete Box Culvert 10' x 5'	30 L.F.	\$ 850.00	\$ 25,500.00		\$ -		\$ -		\$ -	
8	Precast Concrete Box Culvert End Section	2 Each	\$ 9,550.00	\$ 19,100.00		\$ -		\$ -		\$ -	
9	Revetment Class E	62 Ton	\$ 55.00	\$ 3,410.00		\$ -		\$ -		\$ -	
10	Safety Closure	2 Each	\$ 150.00	\$ 300.00		\$ -		\$ -		\$ -	
11	Traffic Control	1 L.S.	\$ 4,000.00	\$ 4,000.00		\$ -		\$ -		\$ -	
12	Mobilization	1 L.S.	\$ 20,000.00	\$ 20,000.00		\$ -		\$ -		\$ -	
TOTAL				\$ 92,230.00		\$ -		\$ -		\$ -	

#12b

WOODBURY COUNTY BOARD OF SUPERVISORS AGENDA ITEM(S) RE

Date: September 10, 2015

Weekly Agenda Date: September 15, 2015

DEPARTMENT HEAD / CITIZEN: Mark J. Nahra P.E. Secondary Roads Dept Head/BenKusler Project Engineer

SUBJECT: **Consideration of award of Bids for Project No RCX-CO97(119)--9A-97**

ACTION REQUIRED:

Approve Ordinance

Approve Resolution

Approve Motion

Give Direction

Other: Informational

Attachments

Consideration X

WORDING FOR AGENDA ITEM: Consideration of award of bids for PCC Paving of 255th Street and turning lanes on Port Neal Road project RCX-CO97(119)—9A-97, subject to the approval of the Iowa Department of Transportation.

EXECUTIVE SUMMARY: This project was let for bid on September 15 at 4:40 PM, 2015. Bids were opened during the Board meeting.

BACKGROUND: The department solicited bids from ten contractors. This project is in the five year construction program..

FINANCIAL IMPACT: This project is funded within the Construction line item within secondary roads department budget, funded 50% RISE Iowa Dept. of Transportation and 50% local funds through TIF and the Urban renewal district. Total cost is expected to be approximately \$1,500,000.00.

RECOMMENDATION: Recommend award of the low bid subject to the approval of the Iowa Department of Transportation.

ACTION REQUIRED: Motion to accept and award the bid subject to the approval of the Iowa Department of Transportation.

Approved by Board of Supervisors March 3, 2015.

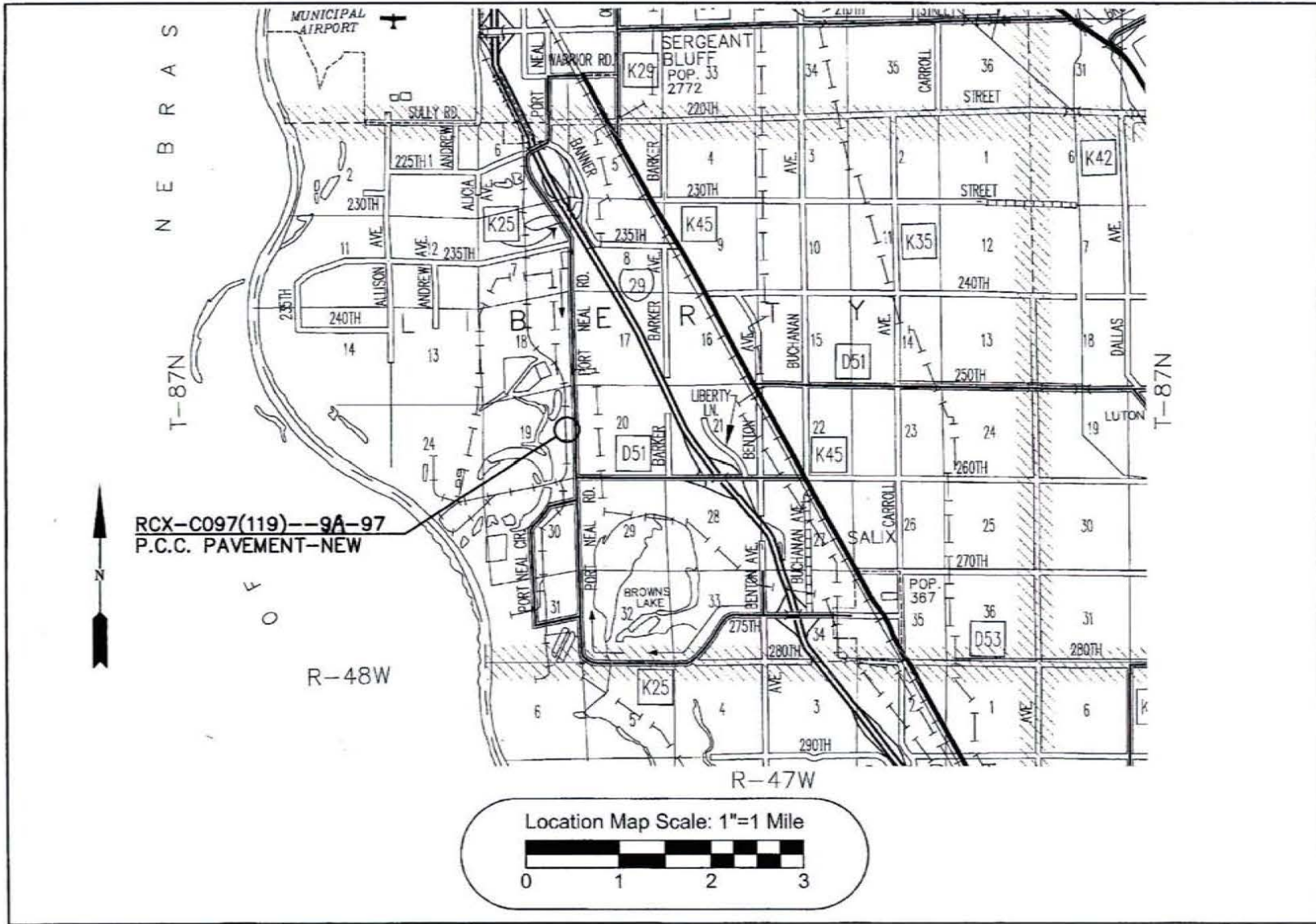

WOODBURY COUNTY ENGINEERS OFFICE	
DESIGNED BY: _____	DATE: _____
DRAWN BY: _____	REVISION: _____
CHECKED BY: _____	DATE: _____
APPROVED BY: _____	DATE: _____
PROJECT DESCRIPTION: DIVISION I & II OF ENTRANCE ROAD AND PORT NEAL TURNING LANES	
SHEET DESCRIPTION: LOCATION MAP	
PROJECT NO. RCX-C097(119)-9A-97	
SHEET	
A2	

#12C

WOODBURY COUNTY BOARD OF SUPERVISORS AGENDA ITEM(S) REQUEST

Date: September 10, 2015

Weekly Agenda Date: September 15, 2015

DEPARTMENT HEAD / CITIZEN: Mark J. Nahra P.E. Secondary Roads Dept Head/BenKusler Project Engineer

SUBJECT: **Consideration of award of Bids for Project No. ER-CO97(124)—58-97**

ACTION REQUIRED:

Approve Ordinance

Approve Resolution

Approve Motion

Give Direction

Other: Informational

Attachments

Consideration X

WORDING FOR AGENDA ITEM: Consideration of award of bids for slide repair and RCB culvert extensions on D38 and K64 project ER-CO97(124)--58-97 subject to the approval of the Iowa Department of Transportation.

EXECUTIVE SUMMARY: This project was let for bid on September 15 at 4:45 PM, 2015. Bids were opened at the Board meeting.

BACKGROUND: The department solicited bids from ten contractors. This project is repair work authorized by Federal Highway and the Iowa Department of Transportation as a result of damage in the June 2014 flood event.

FINANCIAL IMPACT: This project is funded by FEMA 75% State 10% Local 15%

RECOMMENDATION: Recommend award of the low bid subject to the approval of the Iowa Department of Transportation.

ACTION REQUIRED: Motion to accept and award the bid subject to the approval of the Iowa Department of Transportation.

Approved by Board of Supervisors March 3, 2015.

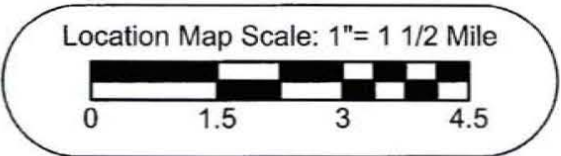
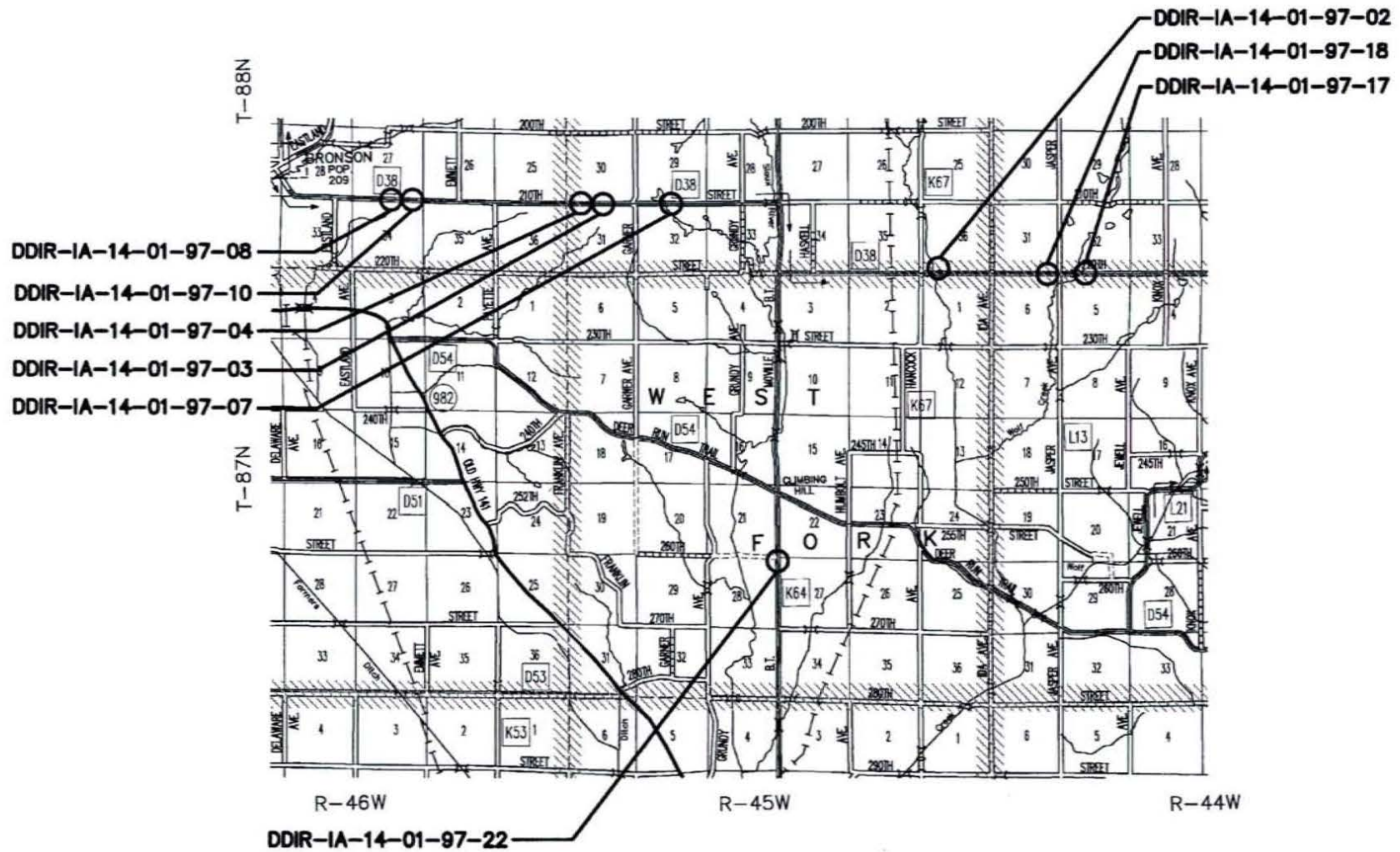
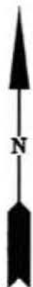

WOODBURY COUNTY ENGINEERS OFFICE											
PROJECT DESCRIPTION: EMERGENCY SHOULDER AND DRAINAGE REPAIRS ON D38 AND K64 SHEET DESCRIPTION: LOCATION MAP	<table border="1"> <tr> <td>CMG</td> <td>DATE</td> </tr> <tr> <td>DRAWN BY</td> <td>REVISION</td> </tr> <tr> <td>DESIGNED BY</td> <td></td> </tr> <tr> <td>IN CHARGE</td> <td></td> </tr> <tr> <td>APPROVED BY</td> <td></td> </tr> </table>	CMG	DATE	DRAWN BY	REVISION	DESIGNED BY		IN CHARGE		APPROVED BY	
CMG	DATE										
DRAWN BY	REVISION										
DESIGNED BY											
IN CHARGE											
APPROVED BY											
PROJECT NO. ER-COR7(124)-98-97 SHEET A2											

#12d

WOODBURY COUNTY BOARD OF SUPERVISORS AGENDA ITEM(S) REQUESTION

Date: September 10, 2015

Weekly Agenda Date: September 15, 2015

DEPARTMENT HEAD / CITIZEN: Mark J. Nahra P.E. Secondary Roads Dept Head/BenKusler Project Engineer

SUBJECT: **Consideration of approval of contract for FY 2016 gravel haul to roadway quotations**

ACTION REQUIRED:

Approve Ordinance

Approve Resolution

Approve Motion

Give Direction

Other: Informational

Attachments

Consideration X

WORDING FOR AGENDA ITEM: Consideration of approval of the contract with Hallett Materials for gravel to be furnished and placed on the roadway in five townships.

EXECUTIVE SUMMARY: Quotations were received by the county engineer's office. The request for quotations were published in county newspapers.

BACKGROUND: The quotations were due September 8, 2015 by 4:00 PM.

FINANCIAL IMPACT: This product contract is funded within the departmental budgets for Secondary Road Department.

RECOMMENDATION: Recommend that the board approve the contract and direct the chair to sign it on behalf of Woodbury County

ACTION REQUIRED: Motion to approve the contract with Hallett Materials for the estimated 13,290 tons at a price of \$157,030.50

Approved by Board of Supervisors March 3, 2015.



OFFICE OF
Woodbury County Planning & Zoning Director
SIXTH FLOOR • SEVENTH AND DOUGLAS STREETS - SIOUX CITY, IA 51101

John Pylelo - Planning & Zoning Director • jpylelo@sioux-city.org

Peggy Napier - Clerk II • pnapier@sioux-city.org

Telephone (712) 279-6557

Fax (712) 278-6530

<http://woodburyiowa.com/departments/planningandzoning/>

Date: September 10, 2015

To: Woodbury County REC; Verizon; Iowa Department of Natural Resources; Siouxland District Health Department; Woodbury County: Assessor, Board of Supervisors, Department of Emergency Services, Engineer, Recorder-Real Estate Dept.; Woodbury County; City Clerk, City of Sioux City; Brent Nelson, City of Sioux City.

From: John Pylelo, Planning and Zoning Director - Woodbury County

Re: Request for Comment upon Final Platting for Water Dog Addition - a minor subdivision; GIS Parcel #874811300010.

Roger and Jean Hassebroek have filed an application and final platting to subdivide 8.842 acres into two (2) lots. The applicants currently reside on the parent parcel within the existing single family dwelling addressed 1020 235th St. The parent parcel has a second dwelling addressed 1012 235th St. in which relatives reside. The applicants wish to split the parcel so each residence lies on an independent parcel.

The parent parcel lies within rural Woodbury County approximately 9/10 of a mile southwest of the Sioux City corporate limits. The closest intersection is 1/2 mile to the east at 235th St. and Allison Ave. The location is within a portion of the NE 1/4 of the SW 1/4 of Section 11, Liberty West Township.

The parent parcel is zoned GI (General Industrial); is not located within a special flood hazard area; and does not lie within any drainage district. The parent parcel is serviced by multiple circular drives. The current and proposed residential use of the parent parcel and its structures are classified as legal and legal non-conforming use(s) within the GI zoning district designation and Woodbury County zoning ordinances. Certain of the parent parcel's structures may be exempt for Woodbury County zoning ordinances due to their agricultural use. Any structure not agriculturally exempt may have restrictions foregoing enlargement or replacement if destroyed.

Of note is the fact an access/egress easement traverses portions of proposed Lots 1 and 2 providing access from two locations along 235th St. ROW to the congruent parcel to the south currently owned by Wagner Farm Enterprises, LLC.

Please review the enclosed final platting and respond to this office with any comments or inquiries before 10:00 AM September 25, 2015. Please do not respond directly to the applicant.

A public hearing on the application and final platting will held before the Woodbury County Zoning Commission at their meeting beginning at 6:00 PM on Monday evening September 28, 2015 in the Woodbury County Courthouse Board Office Meeting Room #104, 620 Douglas St., in Downtown Sioux City, IA. If attending the public hearing please use the 7th St. Courthouse entrance. Be advised a security screening procedure is now required to enter the Woodbury County Courthouse.

Final Platting is in the Board office for review.

When: Tuesday, September 29th
Time: 6:00 p.m. – REAP Open House
6:30-8 p.m. – REAP Assembly

Where: Correctionville
Correctionville Comm. Center

We look forward to seeing you there.

**RESOURCE ENHANCEMENT
& PROTECTION**
IOWA DEPARTMENTS OF:

- AGRICULTURE & LAND STEWARDSHIP
- CULTURAL AFFAIRS
- NATURAL RESOURCES
- TRANSPORTATION

WWW.IOWAREAP.COM

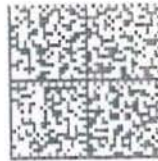

U.S. POSTAGE PITNEY-BOWES
PLEASE PLACE STAMP HERE
ZIP 50319 \$ 000.35⁰
02 1W
0001398789 SEP 09 2015

MARK MONSON
620 DOUGLAS ST
SIOUX CITY IA 51101

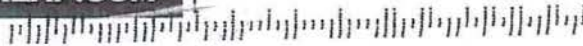

You are invited....

2015 REAP ASSEMBLY

SEPTEMBER 29TH | CORRECTIONVILLE COMM. CENTER
312 DRIFTWOOD STREET, CORRECTIONVILLE, IA 51016

Are you interested in your local parks and trails? Then come help your city take part in the state's premiere outdoor recreation and conservation funding program – **Resource Enhancement And Protection (REAP)** – at your regional meeting.

For 26 years, REAP has funded nearly \$300 million projects for cities, county and state parks, water quality, habitat improvements, roadside prairies, historical development and conservation education. More than \$45.7 million of that has gone directly to city park and trail projects. Did you know that in your 5 county area alone, **REAP has spent over \$13 million on local projects?**

This is a great opportunity to learn more about REAP and work with your constituents to share your thoughts on how to make REAP work better for your city. You will also have the chance to elect delegates to the REAP Congress that will be held in January 2016 in Des Moines. The REAP Congress will vote on priorities to send to the Governor and Legislature.

August 31, 2015

Woodbury County Board of Supervisors
620 Douglas St
Sioux City, IA 51101

I am writing to encourage you to join us on Tuesday, October 13 at the Des Moines Marriott Downtown for the **Ninth Annual Iowa Hunger Summit**, an important part of the annual World Food Prize events. **Free and open to the public**, this unique event will bring together community, business and civic leaders from across Iowa united by their interest and involvement in the fight against hunger – both at home and abroad.

Inspired by Nobel Peace Prize Laureate and Iowa hero Dr. Norman E. Borlaug, and with Governors Terry Branstad, Robert Ray, Chet Culver and Tom Vilsack serving as Honorary Co-Founders, the Hunger Summit is an all-day event highlighting our state's impact in fighting food insecurity, malnutrition and deprivation. Leading anti-hunger organizations will host **informative presentations** as well as **crucial discussions on ending domestic and international hunger**. A detailed agenda is included in the enclosed brochure.

The day's highlight will be the **Hunger Luncheon** – featuring state and international leaders, meals representing Iowa-based programs working to alleviate hunger, the presentation of the **Robert D. Ray Iowa SHARES Award** which annually recognizes an Iowan who has provided significant leadership confronting hunger at home and abroad and a keynote address by **Mr. Raymond Offenheiser, President of Oxfam America**. Under the leadership of Mr. Offenheiser since 1996, Oxfam America is a pioneer in building systemic solutions that address the root causes of poverty around the world, as well as a leader in raising awareness of the connections between hunger at home and abroad.

Here is how you can get involved in the 2015 Iowa Hunger Summit:

- **Plan to attend:** The event is free and open to all but you will need to register. You can do so at www.worldfoodprize.org/hsregister.
- **Share your story:** Throughout the year, the online **Iowa Hunger Directory** at www.iowahungerdirectory.org promotes networking and collaboration among Iowa's hunger fighters by profiling every Iowa organization, business, and civic group whose work impacts hunger in Iowa or abroad. Join the directory at www.worldfoodprize.org/shareyourstory
- **Spread the word:** Encourage others interested in hunger and nutrition issues to attend the Iowa Hunger Summit. Follow us on Twitter [@IAHungerSummit](https://twitter.com/IAHungerSummit)

Please join us as we celebrate our common heritage of humanitarian action at the 2015 Iowa Hunger Summit, the kick-off to our World Food Prize events – known as one of “the most significant observances of World Food Day anywhere around the globe.”

Sincerely,

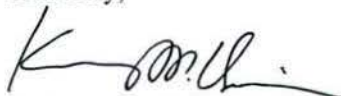

Ambassador Kenneth M. Quinn (ret.)
President, the World Food Prize Foundation

WOODBURY COUNTY JAIL WEEKLY POPULATION REPORT AT 0600 HRS.

<u>DATE</u>	<u>Day</u>	<u>DAILY TOTAL</u>	<u>LEC</u>	<u>ELECTRONIC MONITORING</u>	<u>PRAIRIE HILLS</u>	<u>FEDERAL PRISONERS</u>
8/29/15	Saturday	225	214	11	0	
8/30/15	Sunday	229	218	11	0	
8/31/15	Monday	224	213	11	0	31
9/1/15	Tuesday	218	207	11	0	31
9/2/15	Wednesday	220	211	9	0	33
9/3/15	Thursday	216	208	8	0	32
9/4/15	Friday	202	194	8	0	26
		1534	1465	69	0	153

24 HOUR DAILY COUNT

<u>DATE</u>	<u>TOTAL</u>	<u>MALE</u>	<u>FEMALE</u>
8/29/15	250	214	36
8/30/15	247	210	37
8/31/15	245	210	35
9/1/15	235	200	35
9/2/15	245	206	39
9/3/15	243	205	38
9/4/15	232	192	40
	1697	1437	260

*Highest population count each day

WOODBURY COUNTY JAIL WEEKLY POPULATION REPORT AT 0600 HRS.

<u>DATE</u>	<u>Day</u>	<u>DAILY TOTAL</u>	<u>LEC</u>	<u>ELECTRONIC MONITORING</u>	<u>PRAIRIE HILLS</u>	<u>FEDERAL PRISONERS</u>
9/5/15	Saturday	196	188	8	0	19
9/6/15	Sunday	209	201	8	0	19
9/7/15	Monday	203	195	8	0	19
9/8/15	Tuesday	203	195	8	0	19
9/9/15	Wednesday	193	184	9	0	18
9/10/15	Thursday	192	183	9	0	17
9/11/15	Friday	204	194	10	0	17
		1400	1340	60	0	128

24 HOUR DAILY COUNT

<u>DATE</u>	<u>TOTAL</u>	<u>MALE</u>	<u>FEMALE</u>
9/5/15	227	187	40
9/6/15	218	183	35
9/7/15	224	189	35
9/8/15	222	187	35
9/9/15	218	180	38
9/10/15	228	193	35
9/11/15	207	174	33
	1544	1293	251

*Highest population count each day

WOODBURY COUNTY JUVENILE DETENTION CENTER

Trosper-Hoyt Bldg
822 Douglas St - 4th Floor
Sioux City, Iowa 51101

Phone 712-279-6622
Email: molsen@sioux-city.org
Fax 712-234-2900

6:00 a.m.

6:00 p.m.

October, 2015

October 31, 2015 15

September, 2015

September 1, 2015 15 15

September 2, 2015 14 15

September 3, 2015 17 17

September 4, 2015 17 17

September 5, 2015 17 17

September 6, 2015 17 17

September 7, 2015 17

The Center averaged 16.3 residents per day during the 6:00 a.m. head count and 16.1 during the 6:00 p.m. check for a weekly average of 16.2 residents per day during the above week.

Of the seventeen residents detained on September 7, 2015 eight or forty seven percent were identified as gang members.

We are currently detaining ten BIA referrals.

Mark Olsen

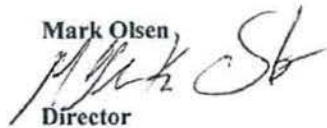

Director

WCJDC

September 7, 2015