

Woodbury County Permit No. \_\_\_\_\_

PERMIT FOR USE OF COUNTY ROAD/HIGHWAY RIGHT-OF-WAY FOR OVERHEAD AND/OR BURIED UTILITIES ACCOMMODATION

REQUEST BY APPLICANT:

Name Gavin W Dinwoodie- Magellan Pipeline Company L.P.

Highway Old Hwy 75 and Benton Road

Address One Williams Center, OTC-8 Tulsa, OK 74172

Township Liberty

City of Salix, 51052

Office Phone 918-574-7959

Local Phone 281-723-1469

Section: NE 1/4 of NE 1/4 Sec 21

Type of Utility Installation Description Attached

T 87 N, R 47 W

Plans Prepared By \_\_\_\_\_

Copy Enclosed Yes  No

Map Showing Location Enclosed  Yes  No

Utility Location is  cross right-of-way  parallel to right-of-way  
 overhead  underground

Proposed Method of Installation

tunnel  suspend on poles  cased  
 jack & bore  suspend on towers  trench  
 open cut  plow

Estimated Starting Date 11-1-2022

Estimated Restoration Date 11-4-2022

The Applicant understands and agrees that the permitted work shall comply with all permit provisions and conditions listed on the reverse side hereof, and special provisions listed below or attached hereto, and any and all plans, details, or notes attached hereto and made a part thereof. Applicant is to complete in triplicate and send all copies including plans and maps to Woodbury County Engineer, 759 E. Frontage Road, Merville, IA 51039. One executed copy will be returned to the Applicant.

By [Signature]  
(Signature of Authorized Utility Representative)

Title Sr. Real Estate Representative

Date 10-20-2022

PERMIT APPROVAL BY PERMITTING AUTHORITY

The foregoing application is hereby approved and permit issued by the Permitting Authority subject to full compliance by the Applicant with all provisions and conditions stated herein and on the reverse side hereof and all attachments hereto.

By [Signature]  
(Signature of Woodbury County Board Chairman)

Title Chairman

Date 10/25/2022

By [Signature]  
(Signature of Woodbury County Engineer)

Title County Engineer

Date 10/25/2022

Other Special Provisions:

Permit Provisions and Conditions of Issuance

- 1. The County and/or the County Board of Supervisors will not be charged with any responsibility for damages to the Applicant's property occasioned by any construction or maintenance operations on said county roads, including new or additional right-of-way acquired in connection therewith, subsequent to the building of the Applicant's facilities. The Board will endeavor to give the Applicant sufficient notice of any proposed construction or maintenance work, on either existing or newly acquired right-of-way that is likely to expose, cover up, or disturb any facilities belonging to the Applicant, in order that the Applicant may arrange to protect the facilities. The Board will inform contractors, and others working on the job of the location of the facilities so that reasonable care may be taken to avoid damaging the facilities, however the County and the Board of Supervisors will assume no responsibility for failure to give such notice.

Approved 1/19/99

2. The Applicant shall take all reasonable precaution during the construction of said facilities to protect and safeguard the lives and property of the adjacent property owners and the traveling public and shall save the County and the Board of Supervisors harmless of any damages or losses that may be sustained by adjacent property owners and the traveling public on account of such construction operations.
3. Operations in the construction and maintenance of said facilities shall be carried on in such a way as to not interfere with, or interrupt traffic on said roads. However, should the performance of work called for in this permit in any way interfere with or obstruct traffic on said roads, the Applicant shall provide the necessary flagmen as required by the Statutes when one-way traffic is involved and/or otherwise mark said work so as to protect the traveling public.
4. The Applicant shall hold the County and the Board of Supervisors harmless from any damages that may result to said highway because of the construction or maintenance of said facilities and shall reimburse the County or the Board of Supervisors for any expenditures that the County or the Board of Supervisors may have to make on said roads on account of replacement of surfacing gravel and bridge and culvert repairs.
5. Applicant shall lay, construct, operate and maintain said facilities so as not to interfere with natural drainage of the road and so as not to interfere with the construction or maintenance of said roads. When buried cable or wire lines are to be placed lengthwise with the roadway, they shall be placed in the County road shoulder or ditch near the toe of the fore-slope and parallel to centerline of roadbed at a depth of three (3) to four (4) feet by using specially designed plows or by trenching, whichever is appropriate. Plow slots and trenches shall be repacked as necessary to restore the disturbed area to its original condition. For buried line crossings of roadways not paved, an open trench may be dug and the lines placed therein, and the trench back-filled over the lines. Buried line crossings on paved roadways, lines may be placed through the sub-grade by jacking, or by boring a hole just large enough to take the lines; or if the County Engineer approves, a tunnel may be dug through and the cable or wire lines placed therein. All backfill of tunnels and trenches shall be thoroughly compacted in layers of 6" or less in depth. Back-filling of trenches within the right-of-way by not under the traveled roadway shall be tamped sufficiently to avoid settlement. When crossing an existing roadway, all buried facilities shall be placed a minimum of three (3) to four (4) below the bottom of the existing adjacent ditches. Overhead lines, where practical, shall be placed adjacent to and with two (2) feet of the Road/Highway Right-of-Way Line.
6. The Applicant will at any time subsequent to placing the facilities, and at the Applicant's expense, relay, replace, alter, change, reconstruct, or relocate its overhead and/or buried facilities and appurtenances thereto as may become necessary to conform to new grades, alignment, or widening right-of-way, resulting from maintenance or construction operations by the County Board of Supervisors irrespective of whether or not additional right-of-way is acquired in connection with such road improvements. The Applicant agrees to do this within ninety (90) days written notice from the Board of Supervisors, and without cost to the County. If the Applicant is unable to comply within said ninety (90) days, the Board of Supervisors may cause the work to be done and the Applicant will pay the cost thereof upon receipt of statement.
7. All work shall be done in a workmanlike manner; the surrounding ground, slopes, and ditch bottoms shall be reshaped to conform to the area and left in a neat condition satisfactory to the County Engineer. All areas where sod has been damaged or destroyed shall be re-seeded.
8. The Applicant shall notify the County Board of Supervisors at least forty-eight (48) hours in advance of the Applicant's intention of starting work covered by this permit on the road right-of-way. Said notice shall be in writing to the County Engineer.
9. Applicant, its' successors, grantees and assigns shall and hereby agrees to assume all responsibility, risks and liabilities for all accidents and damages that may occur to persons and/or property on account of the work done under this permit, and to this end, indemnify and hold the County and all authorized representatives thereof harmless from any and all claims, damages, losses, and expense including judgements, costs and including attorney's fees, for personal injuries (including death) or property damage arising or resulting from the activities of the Applicant in connection herewith, now and at all times in the future.
10. It is understood that this permit is issued only insofar as Woodbury County has jurisdiction and does not presume to release the Applicant from fulfilling any existing statutes relating to the installation, construction and operation of said facilities.
11. It is further understood that the facilities covered by this permit shall be constructed or installed within one (1) year after the date of approval of this permit, unless otherwise extended in writing by Woodbury County.
12. Engagement in the operations as herein applied for by the Applicant shall be considered and constitute an acceptance of all the terms and conditions herein set forth.

**Description of work:**

Magellan contractors will be excavating the area in question down to the pipeline. Expose the line, investigate, sand blast-cleaning the exterior of the pipeline. Apply a new metal sleeve on the pipeline anomaly of the area in question. Weld and recoat the sleeve with a protective and cathodic sealant. The entire process weather permitting takes 2-3 days maximum. The trench soil will be compacted and grass seed spread to ensure revegetation, and the surface is left in as good or better condition than prior to the excavation work.

**Location:** off Old Hwy 75 at Benton Road to the East side of the Hwy. Part of trench in bar ditch, 42.34244697, -96.31093833 Woodbury Co

# Work in Woodbury Co ROW

Legend

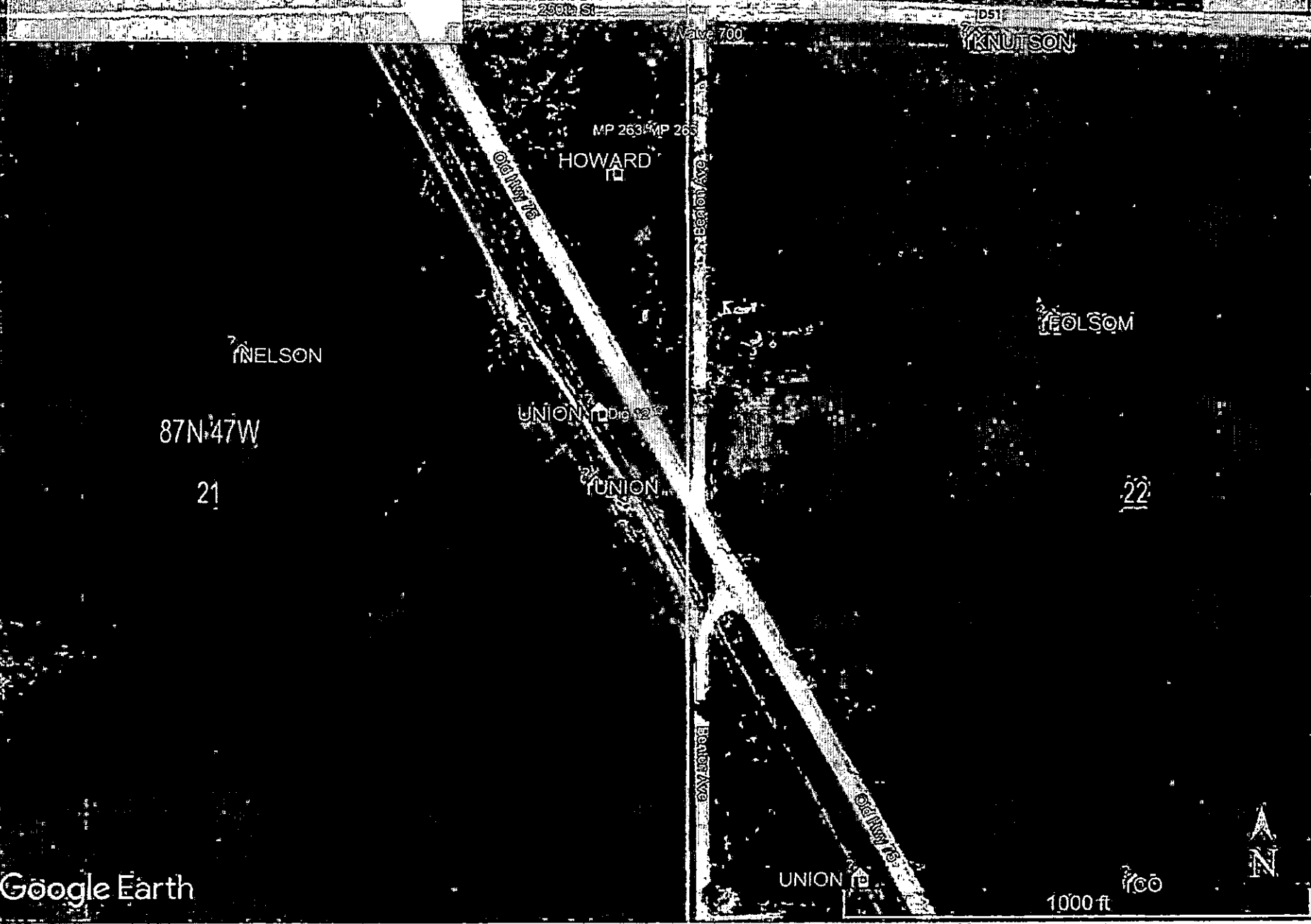

MP 263 MP 265

HOWARD

NELSON

87N 47W

21

UNION

UNION

FOLSOM

22

UNION

1000 ft

Google Earth



- Legend**
- BARNSDALL
  - Dig 12
  - Feature 1
  - Feature 2
  - IL XYZ Placer
  - IL XYZ Placer
  - IN
  - IN
  - UNION



Benton Ave

Benton Ave

© 2014 Intel

GENERAL NOTES

1. THE CONTRACTOR SHALL INSTALL AND MAINTAIN THE TRAFFIC CONTROL DEVICES AS SHOWN HEREIN, AS WELL AS ANY ADDITIONAL TRAFFIC CONTROL DEVICES AS MAY BE REQUIRED TO ENSURE THE SAFE MOVEMENT OF TRAFFIC AND PEDESTRIANS THROUGH OR AROUND THE WORK AREA AND TO PROVIDE MAXIMUM PROTECTION AND SAFETY TO CONSTRUCTION WORKERS.
2. ALL DELINEATORS SHALL BE EQUIPPED WITH REFLECTIVE BANDS.
3. ALL SIGNS, STRIPES, DELINEATORS, BARRICADES, AND OTHER TRAFFIC CONTROL DEVICES AND THEIR INSTALLATION SHALL CONFORM TO MUTCD, STANDARD SPECIFICATIONS LATEST EDITION, FOR CONSTRUCTION AND MAINTENANCE WORK ZONES' (LATEST EDITION). IN THE EVENT OF CONFLICT BETWEEN THESE DOCUMENTS THE MOST STRINGENT REQUIREMENT SHALL APPLY.
4. ALL TRAFFIC CONTROL DEVICES SHALL BE KEPT IN THEIR PROPER POSITION AT ALL TIMES, AND SHALL BE REPAIRED, REPLACED, OR CLEANED AS NECESSARY TO PRESERVE THEIR MAXIMUM VISIBILITY AND EFFECTIVENESS.
5. CONTRACTOR SHALL REPLACE OR REPAIR ALL DAMAGES STRIPING WITH TEMPORARY STRIPING OR RAISED PAVEMENT MARKERS AT END OF EACH WORKING DAY.
6. LOCAL LAW ENFORCEMENT, EMERGENCY & CITY TRANSIT DEPARTMENTS SHALL BE NOTIFIED 48 HOURS PRIOR TO COMMENCEMENT OF TRAFFIC CONTROL OPERATIONS.
7. CONTRACTOR SHALL MAINTAIN PEDESTRIAN ACCESS AT ALL TIMES.
8. CONTRACTOR SHALL COVER OR REMOVE ALL CONFLICTING SIGNS.
9. LOCAL AND EMERGENCY ACCESS SHALL BE MAINTAINED AT ALL TIMES.
10. NO SIGNS, OTHER THAN THOSE CALLED FOR ON THESE PLANS, SHALL BE PLACED IN THE PUBLIC RIGHT-OF-WAY WITHOUT WRITTEN APPROVAL OF THE TRANSPORTATION PLANNING MANAGER.
11. LANE CLOSURES, ROAD DETOURS, ROAD CLOSURES, AND TRAFFIC SIGNAL MODIFICATION ASSOCIATED WITH OVERNIGHT CONSTRUCTION ACTIVITIES WILL REQUIRE INFORMATION SIGNS BE PLACED AT LEAST ONE (1) WEEKS IN ADVANCE OF CONSTRUCTION.
12. ALL ADVANCED WARNING SIGNS SHALL BE EQUIPPED WITH FLAGS DURING DAY TIME WORKING HOURS AND WITH FLASHING BEACONS AT NIGHT.
13. ALL BARREL DELINEATORS SHALL BE 36" MINIMUM HEIGHT AND CONES SHALL BE 28" MINIMUM HEIGHT AND SHALL INCLUDE 6" AND 4" HIGH INTENSITY REFLECTORIZED BANDS OR SLEEVES. ALL SIGNS SHALL BE REFLECTORIZED AND STANDARD SIZE.

INDEX: SHEET 1 - COVER SHEET  
SHEET 2 - RIGHT SHOULDER CLOSURE

CONTRACTOR: ENERPIPE, LTD  
500 SOUTH TAYLOR, SUITE 1010  
AMARILLO, TX 79105

PROJECT: OLD HIGHWAY 75 SHOULDER PROTECTION  
42°20'32.8"N, 96°18'39.5"W  
OLD HWY 75 & BENTON AVE  
SALIX, IA 51052

DESCRIPTION: SHOULDER CLOSURE FOR WORK ZONE  
ALONG NORTHBOUND OLD HIGHWAY 75

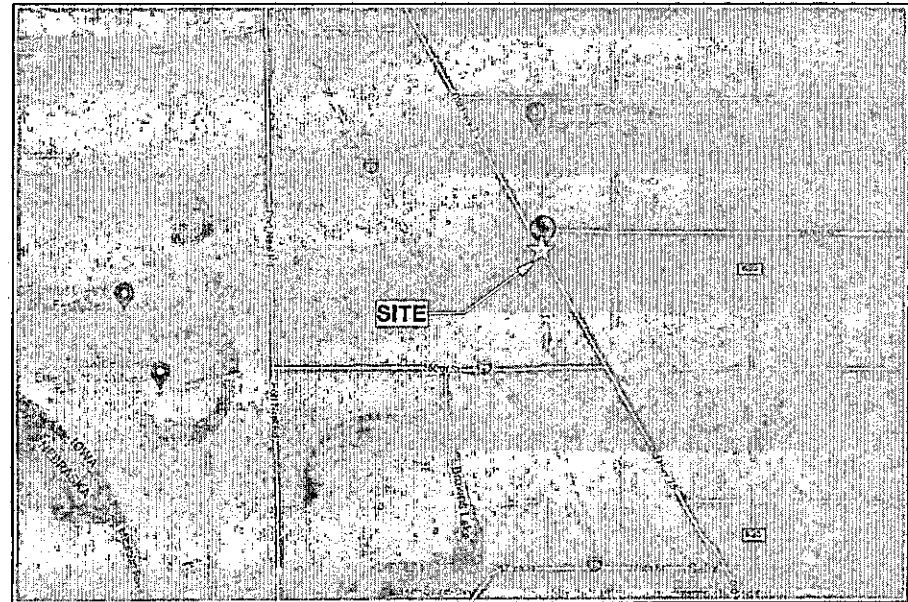
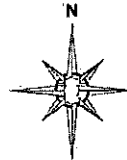

NATIONAL TRENCH SAFETY  
3550 ROUND BARN BLVD.  
SUITE 205  
SANTA ROSA, CA. 95403

JOB #	22395	REVISIONS		
		REV	BY	DATE
DRAWN	LE			
DESIGNED	IMH			
CHECKED	PM			
DATE	10-24-22			

ENERPIPE, LTD  
500 SOUTH TAYLOR SUIT 1010  
AMARILLO, TX 79105

OLD HIGHWAY 74 SHOULDER PROTECTION  
SALIX, IA  
TRAFFIC CONTROL PLAN  
COVER SHEET

SCALE  
HOR. AS SHOWN  
VER. AS SHOWN  
DRAWING  
SHEET  
1 of 2

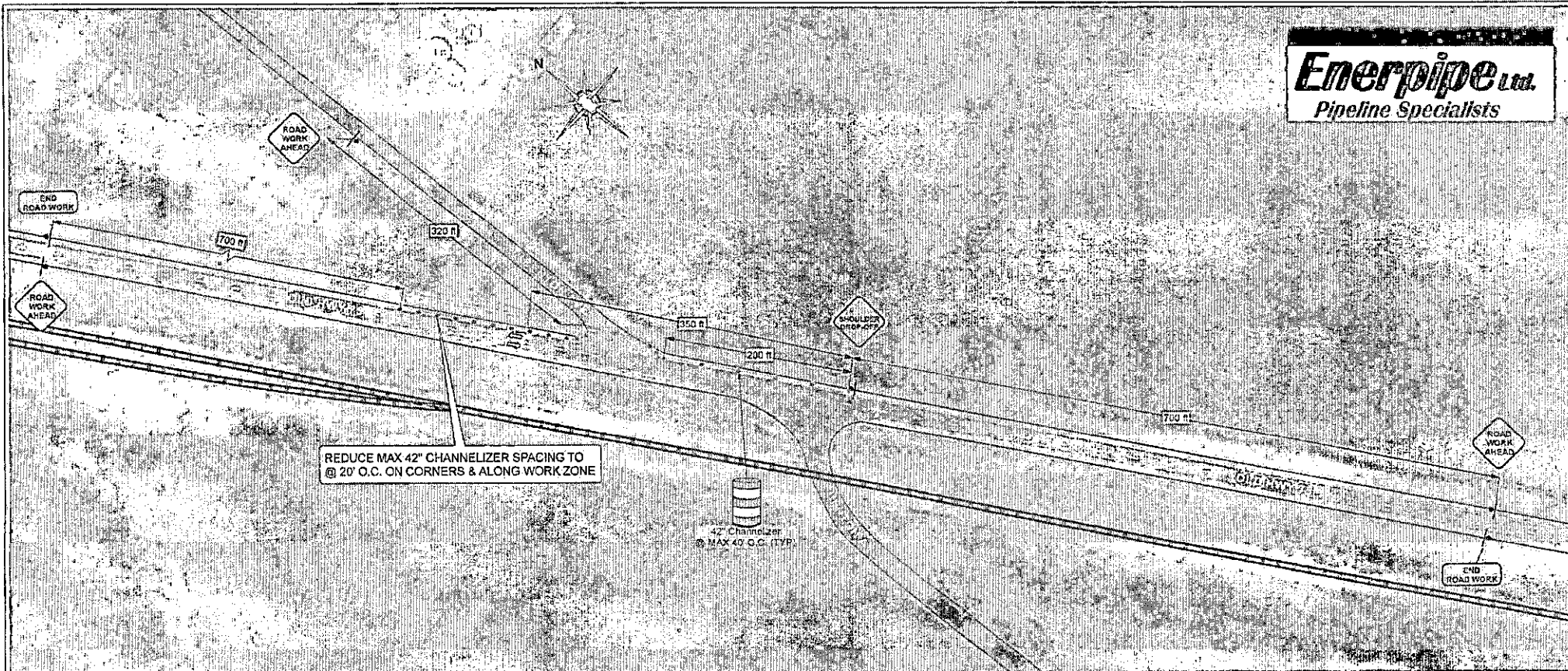

REDUCE MAX 42" CHANNELIZER SPACING TO @ 20' O.C. ON CORNERS & ALONG WORK ZONE

42" Channelizer  
@ MAX 45' O.C. (TYP)

- Legend**
- 42" Channelizer
  - ⚠ Adv. Warning Sign
  - Safety Zone
  - ➡ Traffic Flow
  - ▭ Work Area

**Estim. Equipment List**

21 x 42" Channelizer
3 x CW20-1 road work ahead
2 x G20-2a End Road Work
1 x W8-9a shoulder drop-off

\*NOTE:  
THIS LIST IS FOR CONTRACTOR'S ESTIMATING PURPOSES ONLY.  
THIS LIST IS TO BE REVIEWED AND IS THE RESPONSIBILITY OF  
THE CONTRACTOR TO VERIFY REQUIRED QUANTITY  
ACCEPTED BY THE CONTRACTOR. THIS LIST INCLUDES NO  
ALLOWANCE FOR LOST AND/OR STOLEN EQUIPMENT.  
CONTRACTOR IS RESPONSIBLE FOR MAINTENANCE OF ALL  
EQUIPMENT SHOWN ON THIS PLAN AND SHALL MAINTAIN  
ADDITIONAL SUPPLY OF SIGNAGE AND EQUIPMENT AT THE JOB  
SITE AT ALL TIMES.

**SPEED  
LIMIT  
45**  
OLD HWY 75  
(M.I.F.)

POSTED SPEED LIMIT (MPH)	MIN. SIGN SPACING "X" (FT)	MAX. SPACING OF CHANNELIZING DEVICES (FT)	MIN. MERGE TAPER "L" (FT)			MIN. LONGIT. BUFFER "B" (FT)
			10'	11'	12'	
30	120'	30'	150'	165'	180'	90'
35	160'	35'	205'	225'	245'	120'
40	240'	40'	285'	295'	320'	155'
45	320'	45'	450'	495'	540'	195'
50	400'	50'	500'	550'	600'	240'



**NATIONAL TRENCH SAFETY**  
3550 ROUND BARN BLVD.  
SUITE 205  
SANTA ROSA, CA. 95403

JOB #	22395	REVISIONS		
DRAWN	LE	REV	BY	DATE
DESIGNED	MH			
CHECKED	PM			
DATE	10-24-22			

ENERPIPE, LTD  
500 SOUTH TAYLOR SUIT 1010  
AMARILLO, TX 79105

**OLD HIGHWAY 74 SHOULDER PROTECTION**  
SALIX, IA  
TRAFFIC CONTROL PLAN  
RIGHT SHOULDER CLOSURE

SCALE  
HOR. AS SHOWN  
VER. AS SHOWN  
DRAWING  
SHEET  
2 of 2