

Woodbury County Permit No. \_\_\_\_\_

**PERMIT FOR USE OF COUNTY ROAD/HIGHWAY RIGHT-OF-WAY  
FOR OVERHEAD AND/OR BURIED UTILITIES ACCOMMODATION**

Job # 21159152

**REQUEST BY APPLICANT:**

Name Telcom Construction for Lumen Highway \_\_\_\_\_  
Township \_\_\_\_\_  
Address PO Box 189, Clearwater MN 55320 City of Mapleton

---

Office Phone 320-321-0235 Local Phone \_\_\_\_\_ Section:  $\frac{1}{4}$  of  $\frac{1}{4}$  Sec  
Type of Utility Installation Buried service wire/telecommunications T N, R W  
Plans Prepared By Telcom Construction for Lumen Copy Enclosed Yes No  
Map Showing Location Enclosed  Yes  No  
Utility Location is \_\_\_\_\_ cross right-of-way  parallel to right-of-way  
\_\_\_\_\_ overhead  underground

Proposed Method of Installation

<input type="checkbox"/> tunnel	<input type="checkbox"/> suspend on poles	<input type="checkbox"/> cased
<input type="checkbox"/> 45ft jack & bore	<input type="checkbox"/> suspend on towers	<input type="checkbox"/> trench
<input type="checkbox"/> open cut	<input type="checkbox"/> 100ft plow	

Estimated Starting Date 10/18/21 Estimated Restoration Date 05/18/22 1 day

The Applicant understands and agrees that the permitted work shall comply with all permit provisions and conditions listed on the reverse side hereof, and special provisions listed below or attached hereto, and any and all plans, details, or notes attached hereto and made a part thereof. Applicant is to complete in triplicate and send all copies including plans and maps to Woodbury County Engineer, 759 E. Frontage Road, Merville, IA 51039. One executed copy will be returned to the Applicant.

By Jessica Voigt Title Permit Clerk  
(Signature of Authorized Utility Representative)  
Date 10/18/21

**PERMIT APPROVAL BY PERMITTING AUTHORITY**

The forgoing application is hereby approved and permit issued by the Permitting Authority subject to full compliance by the Applicant with all provisions and conditions stated herein and on the reverse side hereof and all attachments hereto.

By [Signature] Title Chair  
(Signature of Woodbury County Board Chairman)

Date 10/26/2021

By Mark J. Mahan Title County Engineer  
(Signature of Woodbury County Engineer)

Date 10/27/2021

Other Special Provisions:

**Permit Provisions and Conditions of Issuance**

- The County and/or the County Board of Supervisors will not be charged with any responsibility for damages to the Applicant's property occasioned by any construction or maintenance operations on said county roads, including new or additional right-of-way acquired in connection therewith, subsequent to the building of the Applicant's facilities. The Board will endeavor to give the Applicant sufficient notice of any proposed construction or maintenance work, on either existing or newly acquired right-of-way that is likely to expose, cover up, or disturb any facilities belonging to the Applicant, in order that the Applicant may arrange to protect the facilities. The Board will inform contractors, and others working on the job of the location of the facilities so that reasonable care may be taken to avoid damaging the facilities, however the County and the Board of Supervisors will assume no responsibility for failure to give such notice.

Approved 1/19/99

2. The Applicant shall take all reasonable precaution during the construction of said facilities to protect and safeguard the lives and property of the adjacent property owners and the traveling public and shall save the County and the Board of Supervisors harmless of any damages or losses that may be sustained by adjacent property owners and the travelling public on account of such construction operations.
3. Operations in the construction and maintenance of said facilities shall be carried on in such a way as to not interfere with, or interrupt traffic on said roads. However, should the performance of work called for in this permit in any way interfere with or obstruct traffic on said roads, the Applicant shall provide the necessary flagmen as required by the Statutes when one-way traffic is involved and/or otherwise mark said work so as to protect the travelling public.
4. The Applicant shall hold the County and the Board of Supervisors harmless from any damages that may result to said highway because of the construction or maintenance of said facilities and shall reimburse the County or the Board of Supervisors for any expenditures that the County or the Board of Supervisors may have to make on said roads on account of replacement of surfacing gravel and bridge and culvert repairs.
5. Applicant shall lay, construct, operate and maintain said facilities so as not to interfere with natural drainage of the road and so as not to interfere with the construction or maintenance of said roads. When buried cable or wire lines are to be placed lengthwise with the roadway, they shall be placed in the County road shoulder or ditch near the toe of the fore-slope and parallel to centerline of roadbed at a depth of three (3) to four (4) feet by using specially designed plows or by trenching, whichever is appropriate. Plow slots and trenches shall be repacked as necessary to restore the disturbed area to its original condition. For buried line crossings of roadways not paved, an open trench may be dug and the lines placed therein, and the trench back-filled over the lines. Buried line crossings on paved roadways, lines may be placed through the sub-grade by jacking, or by boring a hole just large enough to take the lines; or if the County Engineer approves, a tunnel may be dug through and the cable or wire lines placed therein. All backfill of tunnels and trenches shall be thoroughly compacted in layers of 6" or less in depth. Back-filling of trenches within the right-of-way by not under the traveled roadway shall be tamped sufficiently to avoid settlement. When crossing an existing roadway, all buried facilities shall be placed a minimum of three (3) to four (4) below the bottom of the existing adjacent ditches. Overhead lines, where practical, shall be placed adjacent to and with two (2) feet of the Road/Highway Right-of-Way Line.
6. The Applicant will at any time subsequent to placing the facilities, and at the Applicant's expense, relay, replace, alter, change, reconstruct, or relocate its overhead and/or buried facilities and appurtenances thereto as may become necessary to conform to new grades, alignment, or widening right-of-way, resulting from maintenance or construction operations by the County Board of Supervisors irrespective of whether or not additional right-of-way is acquired in connection with such road improvements. The Applicant agrees to do this within ninety (90) days written notice from the Board of Supervisors, and without cost to the County. If the Applicant is unable to comply within said ninety (90) days, the Board of Supervisors may cause the work to be done and the Applicant will pay the cost thereof upon receipt of statement.
7. All work shall be done in a workmanlike manner; the surrounding ground, slopes, and ditch bottoms shall be reshaped to conform to the area and left in a neat condition satisfactory to the County Engineer. All areas where sod has been damaged or destroyed shall be re-seeded.
8. The Applicant shall notify the County Board of Supervisors at least forty-eight (48) hours in advance of the Applicant's intention of starting work covered by this permit on the road right-of-way. Said notice shall be in writing to the County Engineer.
9. Applicant, its' successors, grantees and assigns shall and hereby agrees to assume all responsibility, risks and liabilities for all accidents and damages that may occur to persons and/or property on account of the work done under this permit, and to this end, indemnify and hold the County and all authorized representatives thereof harmless from any and all claims, damages, losses, and expense including judgments, costs and including attorney's fees, for personal injuries (including death) or property damage arising or resulting from the activities of the Applicant in connection herewith, now and at all times in the future.
10. It is understood that this permit is issued only insofar as Woodbury County has jurisdiction and does not presume to release the Applicant from fulfilling any existing statutes relating to the installation, construction and operation of said facilities.
11. It is further understood that the facilities covered by this permit shall be constructed or installed within one (1) year after the date of approval of this permit, unless otherwise extended in writing by Woodbury County.
12. Engagement in the operations as herein applied for by the Applicant shall be considered and constitute an acceptance of all the terms and conditions herein set forth.

ARMOR =



BSW SKETCH FORM

Neclas #: 21159152-HELD

NPA / N NX (Wiro Center): 712-882

Date Submitted: 10/13/21

Installation / Repair / Proprovisioning <i>(Please Circle One of the Above)</i>	Customer Name: <u>Troy's Gray</u>
Job ID <u>N 25561795</u>	Address: <u>3379 Michigan Ave</u>
TN <u>712-882-9139</u>	City: <u>Mapleton</u>
<i>(Please Check One of the Below)</i>	011 Address: <u>1</u>
<input checked="" type="radio"/> HELD for BSW	Phone: _____ CBR: <u>712-880-0524</u>
<input type="radio"/> 2. HELD - cannot locate ENCAP	Subdivision: _____ Lot: _____ Block: _____
<input checked="" type="radio"/> 3. OOS - cannot lay temp	County: _____ Section: _____ Range: _____ Twnship: _____
<input type="radio"/> 4. HELD for F1-F2 (also needs BSW)	Quarter Section: <i>(circle one)</i> _____ NW NE SW SE
<input type="radio"/> 5. TEMP Plected	Submitted By Name: <u>Rob Mosel</u>
<input type="radio"/> 6. TEMP Found - Same Job	EC: <u>686</u> Pgr/Cell: <u>712-253-8121</u>
<input type="radio"/> 7. Add Line - Other Location	Supervisor: <u>Chris Lovelace</u>
	Office # _____ Pgr: <u>702-544-8783</u>
	Customer was contacted: <i>(circle one)</i> verbally <input checked="" type="checkbox"/> by card

Hudson / King: Yr. \_\_\_\_\_ Pg. \_\_\_\_\_ Terminal Address: 132 P2

Cross Street: n/a Total BSW Footage: 145 Type of Wire:  (3pr) /  (6pr)

L-INFO:	L	S	W	2	C		3			
	LE	F,R,S	N,E,S,W	1-2-3-4-5-6-7	W,S,P,O,C	G,A,M,N	3/6	S,N	P,N	C

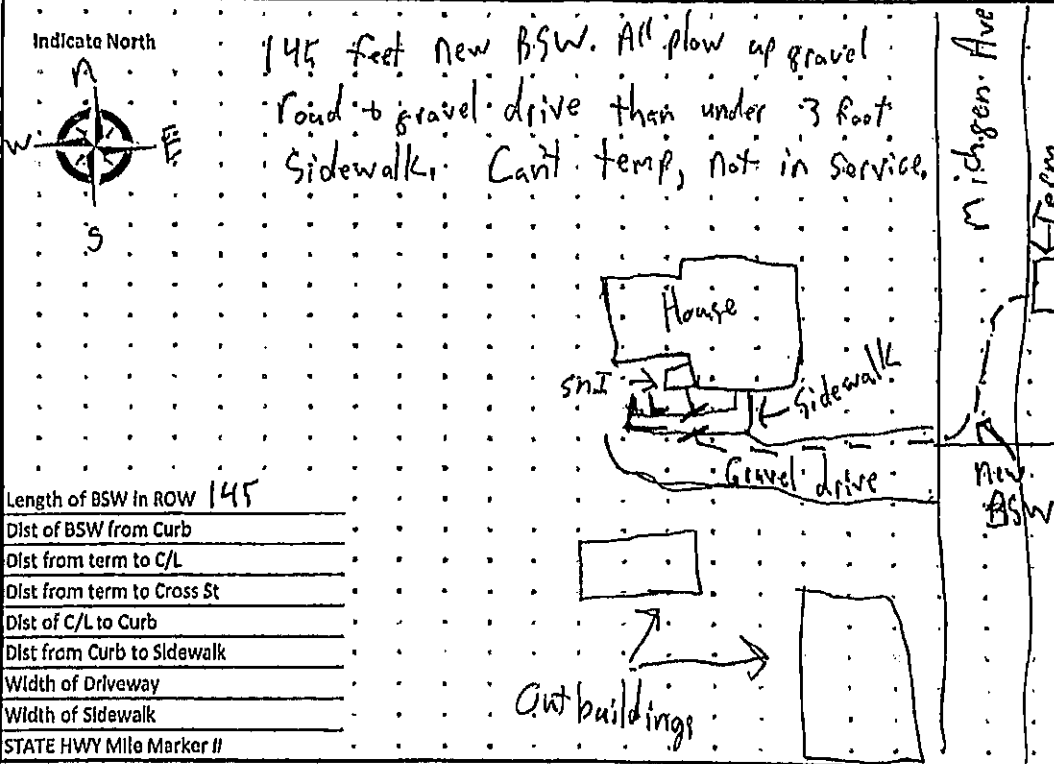

Length of BSW in ROW 145

Dist of BSW from Curb \_\_\_\_\_

Dist from term to C/L \_\_\_\_\_

Dist from term to Cross St \_\_\_\_\_

Dist of C/L to Curb \_\_\_\_\_

Dist from Curb to Sidewalk \_\_\_\_\_

Width of Driveway \_\_\_\_\_

Width of Sidewalk \_\_\_\_\_

STATE HWY Mile Marker # \_\_\_\_\_

Road crossing must be bored, bury in ROW

Permit Required  Hand Dig (NOTE: Hand Dig must be 12")