

**PCO #019R1**

Hausmann Construction, Inc.
2108 Taylor Ave. #850
Norfolk, Nebraska 68701
Phone: (402) 371-8650
Fax: (402) 438-3235

Project: 21-068 - Woodbury County - Law Enforcement Center
3701 28th Street
Sioux City, Iowa 51104

Prime Contract Potential Change Order #019R1: CE #PCO 019R1 - PR 11 Site Revision

TO:	Woodbury County Law Enforcement 620 Douglas Street Sioux City, Iowa 51105	FROM:	Hausmann Construction, Inc. 8885 Executive Woods Drive Lincoln, Nebraska 68512
PCO NUMBER/REVISION:	019R1 / 0	CONTRACT:	21-068 - Woodbury County - Law Enforcement Center
REQUEST RECEIVED FROM:		CREATED BY:	Nathan Thege (Hausmann Construction, Inc.)
STATUS:	Pending - In Review	CREATED DATE:	4/11/2022
REFERENCE:		PRIME CONTRACT CHANGE ORDER:	None
FIELD CHANGE:	No		
LOCATION:	Woodbury County LEC	ACCOUNTING METHOD:	Amount Based
SCHEDULE IMPACT:		PAID IN FULL:	No
EXECUTED:	No	SIGNED CHANGE ORDER RECEIVED DATE:	
		TOTAL AMOUNT:	(\$1,953.00)

POTENTIAL CHANGE ORDER TITLE: CE #PCO 019R1 - PR 11 Site Revision

CHANGE REASON: Design Development

POTENTIAL CHANGE ORDER DESCRIPTION: *(The Contract Is Changed As Follows)*

CE #PCO 019R1 - PR 11 Site Revisions

PCO 019R1 is created to incorporate costs associated with PR 011 as itemized within. Please provide approval of pricing no later than 3/10/22.

ATTACHMENTS:

[21-068 - CO BACK UP 4.11.22.pdf](#) , [_Eggar - Deduct.pdf](#) , [_Woodbury Co PR 11.pdf](#) , [_HCC- PR-11 Response REV1.pdf](#) , [_Alliant - PR 11.pdf](#)

#	Description	Amount
1	Removal 2 Concrete Steps	\$(495.00)
2	Removal Handrails	\$(600.00)
3	Reduced Yards Concrete	\$(180.00)
4	Reduced Form Material	\$(100.00)
5	Reduce Labor Install Handrails	\$(540.00)
6	Fee	\$(38.00)
Grand Total:		\$(1,953.00)

Kevin Rost (Goldberg Group Architects)
520 Francis Street Suite 200C
St. Joseph, Missouri 64501

Woodbury County Law Enforcement
620 Douglas Street
Sioux City, Iowa 51105

Hausmann Construction, Inc.
8885 Executive Woods Drive
Lincoln, Nebraska 68512

DocuSigned by:

Kevin Rost 4/14/2022

—B8A4BCDF8BED4D9...

SIGNATURE

DATE

DocuSigned by:

Ron Wieck 4/28/2022

—7AD68DE5E3CE459...

SIGNATURE

DATE

DocuSigned by:

Klay Kasik 4/13/2022

—B96658CE885642A...

SIGNATURE

DATE

Approved By:

DocuSigned by:
Klay Karik
B96656CE885642A...



Woodbury LEC
PR 11 - Site Revision

Cost Item: PR 11 - Site Revision
21-068 DATE: 04/11/22

ITEM DESCRIPTION	QUANTITY	UNIT	MATERIAL COST		LABOR COSTS		EQUIPMENT COSTS		SUBCONTRACTOR		SUBTOTALS	
			Rate	TOTAL	RATE	TOTAL	Rate	TOTAL	Rate	TOTAL		
Self Perform											\$	-
	1	hour		\$ -					\$ -		\$ -	
Subcontracts												
Heartland Concrete - 2 Concrete Steps Removed	9	Hrs		\$ -	\$55	\$ 495.00		\$ -	\$ -	\$ (495.00)	\$ (495.00)	
Eggar Steel - Eliminated Handrail	1	Isum		\$ -		\$ -		\$ -	\$ -	\$ (600.00)	\$ (600.00)	
Hausmann - Reduce 1.5 yds Concrete	1.50	Yds	\$120.00	\$ 180.00		\$ -		\$ -	\$ -	\$ (180.00)	\$ (180.00)	
Hausmann - Form Material	1	Isum		\$ -		\$ -		\$ -	\$ -	\$ (100.00)	\$ (100.00)	
Alliant	1	Isum		\$ -		\$ -		\$ -	\$ -	\$ (540.00)	\$ (540.00)	
	1	Isum		\$ -		\$ -		\$ -	\$ -	\$ -	\$ -	
Subtotals				\$ 180.00		\$ 495.00		\$ -		\$ (1,915.00)	\$ (1,915.00)	
Subtotal				\$ (1,915.00)								
Self-Perform Fee	10.0%			\$ -								
Sub Fee	2.0%			\$ (38.00)								
Bond & Insurance				\$ -								
Grand Total				\$ (1,953.00)								



909 South 7th Avenue
P.O. Box 2698
Sioux Falls, S.D. 57101
Telephone 605-336-2490
Fax 605-332-3023

GENERAL CONDITIONS OF SALE

1. ACCEPTANCE OF PROPOSAL.

- A. We propose to furnish the materials described on the front of this form for the referenced project, in accordance with the terms printed on this form, which are accepted and agreed to by you upon your signing and returning this form or by your verbal authorization at any time within thirty (30) days from the date listed on the front of this form.
- B. This proposal must be accepted as contained on this form. Any conditions or terms which differ from this proposal may be cause for us to withdraw this proposal.
- C. If a subsequent contract is entered into concerning this proposal or the referenced project, this form shall be incorporated into that contract and made a part thereof, whether specifically referred to or not.

2. DELIVERY.

- A. All deliveries are subject to availability. We assume no liability for damages of whatever kind for delay's in delivery. No delays in delivery shall relieve you from your obligations to perform hereunder.
- B. Immediately upon receiving the materials you must check them for shortages, defects, and damages. All claims for shortages, defects, or damages must be made in writing and must specify in detail the nature and extent of the shortage, defect or damage. The original freight bill with a notation on the face thereof by the local agent of the carrier as to the shortage, defect or damage must accompany each claim.
- C. Upon receipt of a claim, and upon its substantiation, we shall, at our option, either: (1) replace the shortage up to the contract requirements or repair the defect in or the damage to the item, part or work; or (2) refund an equitable portion of the purchase price.

3. PAYMENT.

- A. Shipment and deliveries of material are subject to approval by our credit department.
- B. Payment on our invoices must be made within thirty (30) days of the invoices date. A service charge will apply on past due accounts.
- C. Upon receipt of mill material in our yard, payment for such material, including freight charges, must be made within thirty (30) days of our receipt and invoicing of that material.
- D. In the event you fail to fulfill the terms of payment, we may defer other shipments or may, at our option, cancel this agreement. We reserve the right, previous to making any shipment, to require from you satisfactory security for performance of your obligations.

4. DESIGN.

- A. We are in no manner responsible for the design on those projects where we prepare shop drawings from designs or plans furnished by others.
- B. In the event disputes arise as to the fabrication of structural steel, such disputes shall be resolved by reference to the American Institute of Steel Construction's specifications and the Code of Standard Practice.
- C. Approval by you, or anyone on your behalf, of shop drawings prepared by us is your approval of our interpretation of the contract requirements and specifications. This approval constitutes your acceptance of all responsibility for the structural design, including connections, and further releases us from any and all liability for the structural design adequacy.

5. TAXES.

- A. As noted on the front of this form, the prices quoted do not include applicable taxes, whether sales, use, excise or otherwise.
- B. We request that you advise us as to any taxes to which you are subject, and the rates thereof, so that we may collect these taxes in accordance with federal, state and local laws.
- C. We will accept a valid tax exemption certificate from you if applicable. The exemption certificate must accompany the signed proposal. You will agree to be responsible for any applicable taxes on shipments made prior to receipt of the exemption certificate by us.

6. MISCELLANEOUS.

- A. In the event that you require us to stop fabrication or you require us to delay delivery of any materials, then there will be a charge for all material and labor expended, plus a charge to cover the expense of stopping and restarting the project. These charges will be due and payable immediately upon interruption of our work. Material held in storage for you shall be at your risk and expense and this expense shall be at a price agreed upon by you and us at the time of stoppage. In the event that you remove your order from our production schedule, then you automatically relinquish your position in our production schedule. At any time thereafter that you instruct us to proceed with your order, your order must at that time take its position in our then-existing production schedule.
- B. No backcharges, except freight, will be allowed on this order unless authorized by us in writing before the expense is incurred.
- C. All quoted prices are based on current transportation rates. Any increase or decrease in transportation rates shall result in a corresponding increase or decrease in the ultimate price of the quoted items.
- D. No alteration or modification of the terms and conditions contained on this form shall be valid unless in writing and signed by both parties.

7. LIEN WAIVERS

- A. Upon request, Egger Steel Company will sign and furnish partial lien waivers on the project. Egger Steel Company will sign and return only lien waivers approved or furnished by Egger Steel Company.

8. SPECIAL NOTES.

- A. Egger Steel Company is certified by the American Institute of Steel Construction for:
 - Category 1: Conventional Steel Structures.
 - Category 2: Complex Steel Building Structures.
 - Category 3: Major Steel Bridges.

520 Francis Street, Suite 200C
Saint Joseph, Missouri, 64501
806-344-9879 | info@gga-pc.com
GoldbergArchitects.com



Work Changes Proposal Request

PROJECT *(Name and address):*

Woodbury County Law Enforcement
Center
3701 28th Street
Sioux City, Iowa 51105

PROPOSAL REQUEST NUMBER: 11

DATE OF ISSUANCE: 03.08.2022

OWNER

ARCHITECT

CONSULTANT

OWNER *(Name and address):*

Woodbury County Law Enforcement
Authority
620 Douglas Street
Sioux City, Iowa 51101

CONTRACT FOR: Woodbury County Law Enforcement
Center

CONTRACT DATE: 06.28.2021

CONTRACTOR

FIELD

ARCHITECT'S PROJECT NUMBER: 16003-06

OTHER

FROM ARCHITECT *(Name and address):*

Goldberg Group Architects, PC
520 Francis Street, Suite 200C
St. Joseph, Missouri 64501

TO CONTRACTOR *(Name and address):*

Hausmann Construction, Inc.
2108 Taylor Avenue #850
Norfolk, Nebraska 68701

Please submit an itemized proposal for changes in the Contract Sum and Contract Time for proposed modifications to the Contract Documents described herein. Within fourteen (14) days, the Contractor must submit this proposal or notify the Architect, in writing, of the date on which proposal submission is anticipated.

THIS IS NOT A CHANGE ORDER, A CONSTRUCTION CHANGE DIRECTIVE OR A DIRECTION TO PROCEED WITH THE WORK DESCRIBED IN THE PROPOSED MODIFICATIONS.

DESCRIPTION *(Insert a written description of the Work):*

Item No. 1 – Site Revisions:

Sheet C3.02 – Grading Plan

- Sheet reflects that the elevation against the building was raised.
- Additionally, two steps were eliminated from stairs on the northwest side of the building.

ATTACHMENTS *(List attached documents that support description):*

Sheet C3.01

REQUESTED BY THE ARCHITECT:

(Signature)

Carole Cline, Associate
(Printed name and title)

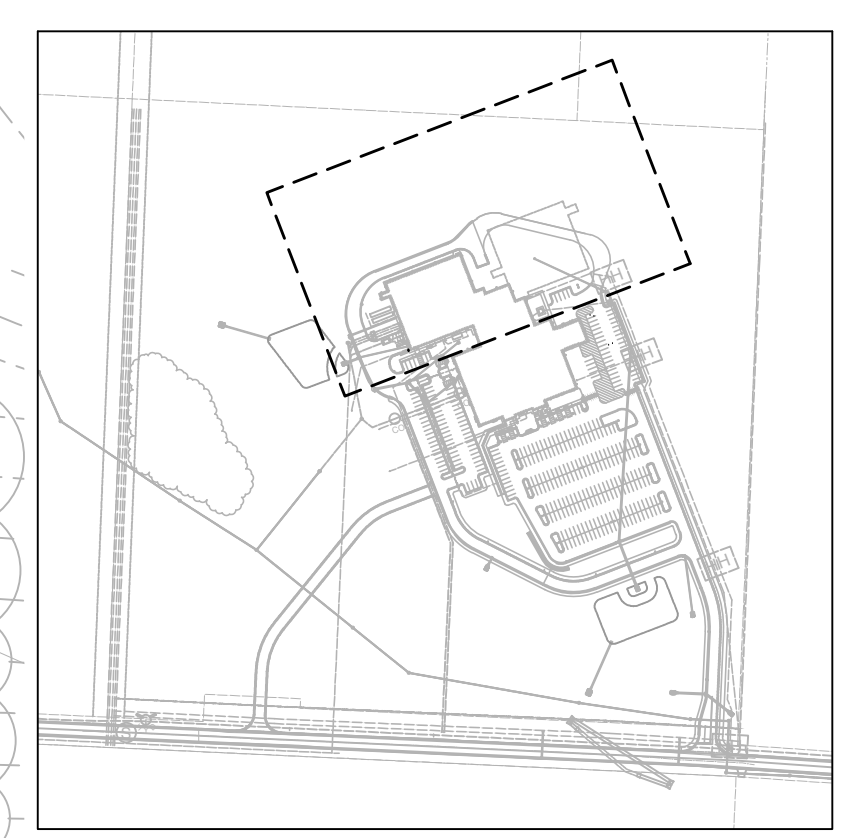

OVERALL KEY MAP
SCALE: 1" = 400'

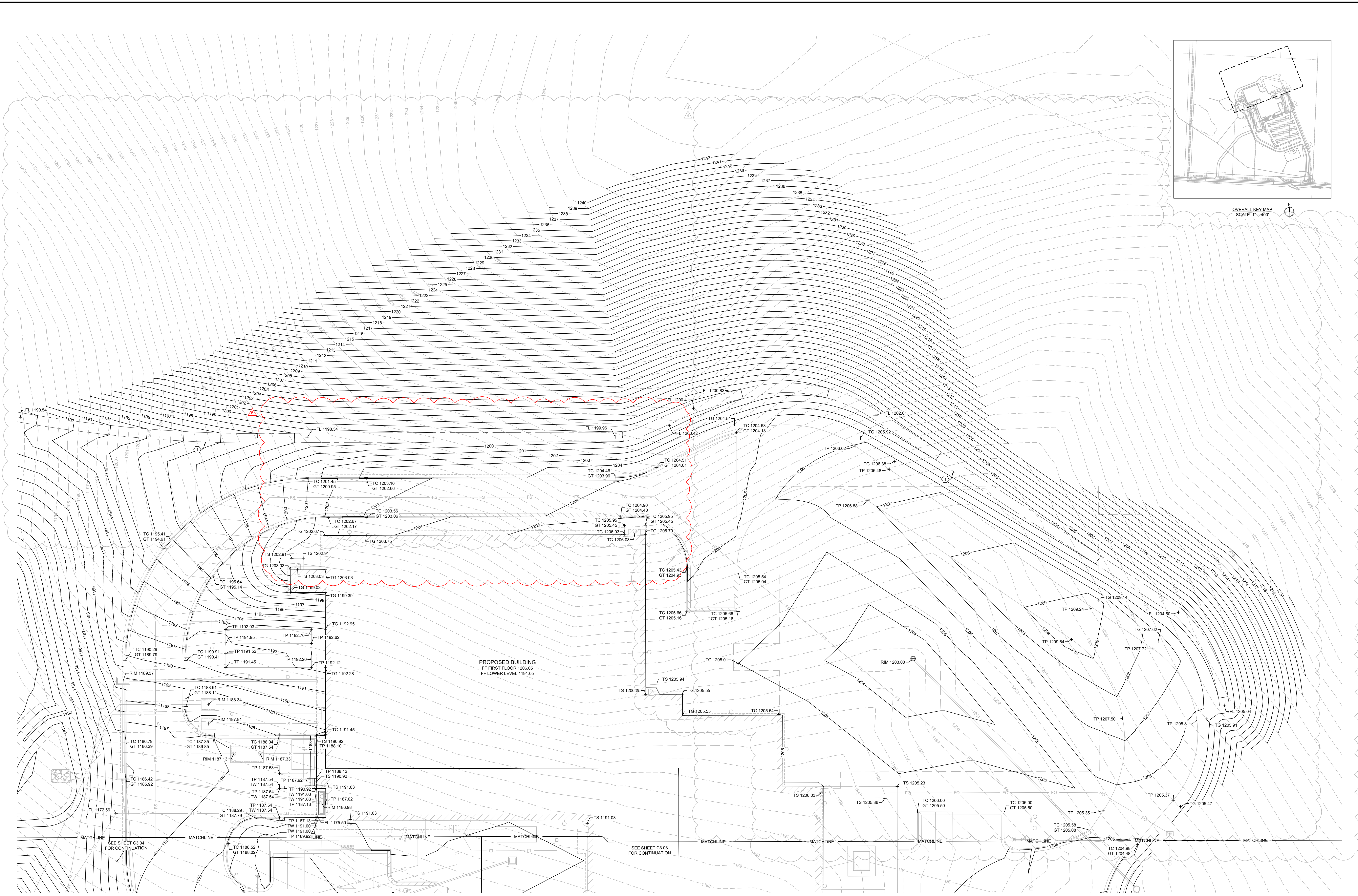

PROPOSED BUILDING
FF FIRST FLOOR 1206.05
FF LOWER LEVEL 1191.05

CONSULTANTS:
Civil: **TOTH AND ASSOCIATES**
Springfield, Missouri 65804
P: (417) 888-0604
Structure: **TOTH AND ASSOCIATES**
550 East Franklin Road
Springfield, Missouri 65804
P: (417) 888-0604
MEP: **ROSS & BARTZMAN**
5350 West 84th, Terrace, Suite 102
Springfield, Missouri 65807
P: (417) 238-5028

PROJECT:
**WOODBURY COUNTY LAW
ENFORCEMENT CENTER**
3701 28th Street
Souix City, Iowa 51105

Description	Date
PR 03	08/15/2021
PR 03R	03/18/2022
PR 03R2	02/18/2022
PR 11	03/08/2022

IF YOU ARE LOOKING AT AN INCOMPLETE SET OF CONTRACT DOCUMENTS (DRAWINGS & SPECIFICATIONS), YOU MAY BE MISSING PORTIONS OF THE WORK FOR WHICH YOU WILL BE RESPONSIBLE.



MATTHEW STEVEN MILLER - ENGINEER
IA# 25536

PROJECT NO:
16003-06
DATE:
08.18.2021
ISSUED FOR:
CONFORMED SET
SHEET NAME:

GRADING PLAN

SHEET NUMBER:
C3.02

ABBREVIATIONS

BC	BACK OF CURB	MC	MOUNTABLE CURB
CC	STANDARD CATCH CURB	PVC	POLYVINYL CHLORIDE PIPE
CL	CENTER LINE	R/W	RIGHT-OF-WAY
CMP	CORRUGATED METAL PIPE	RCP	REINFORCED CONCRETE PIPE
EP	EDGE OF PAVEMENT	SC	SPILL CURB
FES	FLARED END SECTION	TB	TOP OF BASE ROCK
FL	FLOW LINE	TC	TOP OF CURB
GT	GUTTER INVERT	TG	TOP OF GROUND
GY	GUY WIRE	TP	TOP OF PAVEMENT
HDPE	HIGH DENSITY POLYETHYLENE	TS	TOP OF SIDEWALK
INV	INVERT	TW	TOP OF WALL
LF	LINEAR FEET		

KEY NOTES:
① CENTERLINE OF PROPOSED 4' WIDE DRAINAGE DITCH.

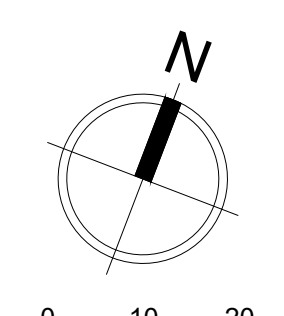

0 10 20
NOTE: DRAWING REPRODUCTION AND SCALING MAY CHANGE THE INDICATED GRAPHIC SCALES
H. SCALE: 1" = 20'



Know what's below.
Call before you dig.
or
1-800-292-8989
www.iowaonecall.com



Alliant Building Group

4500 N 176th St.
Lincoln, NE 68527

402.216.9422

mattb@alliantbuildinggroup.com

DATE 4/4/22

Proposal For: Hausmann Construction

Project Name: Woodbury County LEC

Scope of Work:

Elimination of two exterior rails per ASI 11. This includes labor, equipment, and consumables necessary for installation.

TOTAL \$540.00

Acceptance & Proposal

The above price, specifications, and conditions are satisfactory and are hereby accepted.

Signature of Acceptance:

Date:

____/____/____