

6d
7/30/19

PERMIT FOR USE OF COUNTY ROAD/HIGHWAY RIGHT-OF-WAY
FOR OVERHEAD AND/OR BURIED UTILITIES ACCOMMODATION

WOODBURY COUNTY

REQUEST BY APPLICANT:

2019 AUG 14 AM 11 50

Name Western Iowa Telephone Association

Highway _____

Address 202 Cedar Street Lawton, IA 51030

Township RUTLAND

City of _____

Office Phone 712-944-5711 Local Phone 712-870-1298

Section: 32 1/4 of 1/4 Sec

Type of Utility Installation Underground Fiber Optic Cable

T 89 N, R 43W

Plans Prepared By Phillip Robinson

Copy Enclosed Yes No

Map Showing Location Enclosed X Yes No

Utility Location is X cross right-of-way
 overhead

 X parallel to right-of-way
 X underground

Proposed Method of Installation

 tunnel suspend on poles cased
 X jack & bore suspend on towers trench
 open cut X plow

Estimated Starting Date 7-24-2019 Estimated Restoration Date 8-24-2019

The Applicant understands and agrees that the permitted work shall comply with all permit provisions and conditions listed on the reverse side hereof, and special provisions listed below or attached hereto, and any and all plans, details, or notes attached hereto and made a part thereof. Applicant is to complete in triplicate and send all copies including plans and maps to Woodbury County Engineer, 759 E. Frontage Road, Merville, IA 51039. One executed copy will be returned to the Applicant.

By Phillip Robinson
(Signature of Authorized Utility Representative)

Title Operations Manager

Date 7-15-2019

PERMIT APPROVAL BY PERMITTING AUTHORITY

The forgoing application is hereby approved and permit issued by the Permitting Authority subject to full compliance by the Applicant with all provisions and conditions stated herein and on the reverse side hereof and all attachments hereto.

By [Signature]
(Signature of Woodbury County Board Chairman)

Title Chair

Date 7/30/2019

By Mark J. Nolan
(Signature of Woodbury County Engineer)

Title County Engineer

Date 7/30/2019

Other Special Provisions:

All lines must be bored under or plowed around county culverts and drainage structures.

Permit Provisions and Conditions of Issuance

- 1. The County and/or the County Board of Supervisors will not be charged with any responsibility for damages to the Applicant's property occasioned by any construction or maintenance operations on said county roads, including new or additional right-of-way acquired in connection therewith, subsequent to the building of the Applicant's facilities. The Board will endeavor to give the Applicant sufficient notice of any proposed construction or maintenance work, on either existing or newly acquired right-of-way that is likely to expose, cover up, or disturb any facilities belonging to the Applicant, in order that the Applicant may arrange to protect the facilities. The Board will inform contractors, and others working on the job of the location of the facilities so that reasonable care may be taken to avoid damaging the facilities, however the County and the Board of Supervisors will assume no responsibility for failure to give such notice.

Google Maps

1556 Knox Ave

Blake Simmons - 712-348-1905

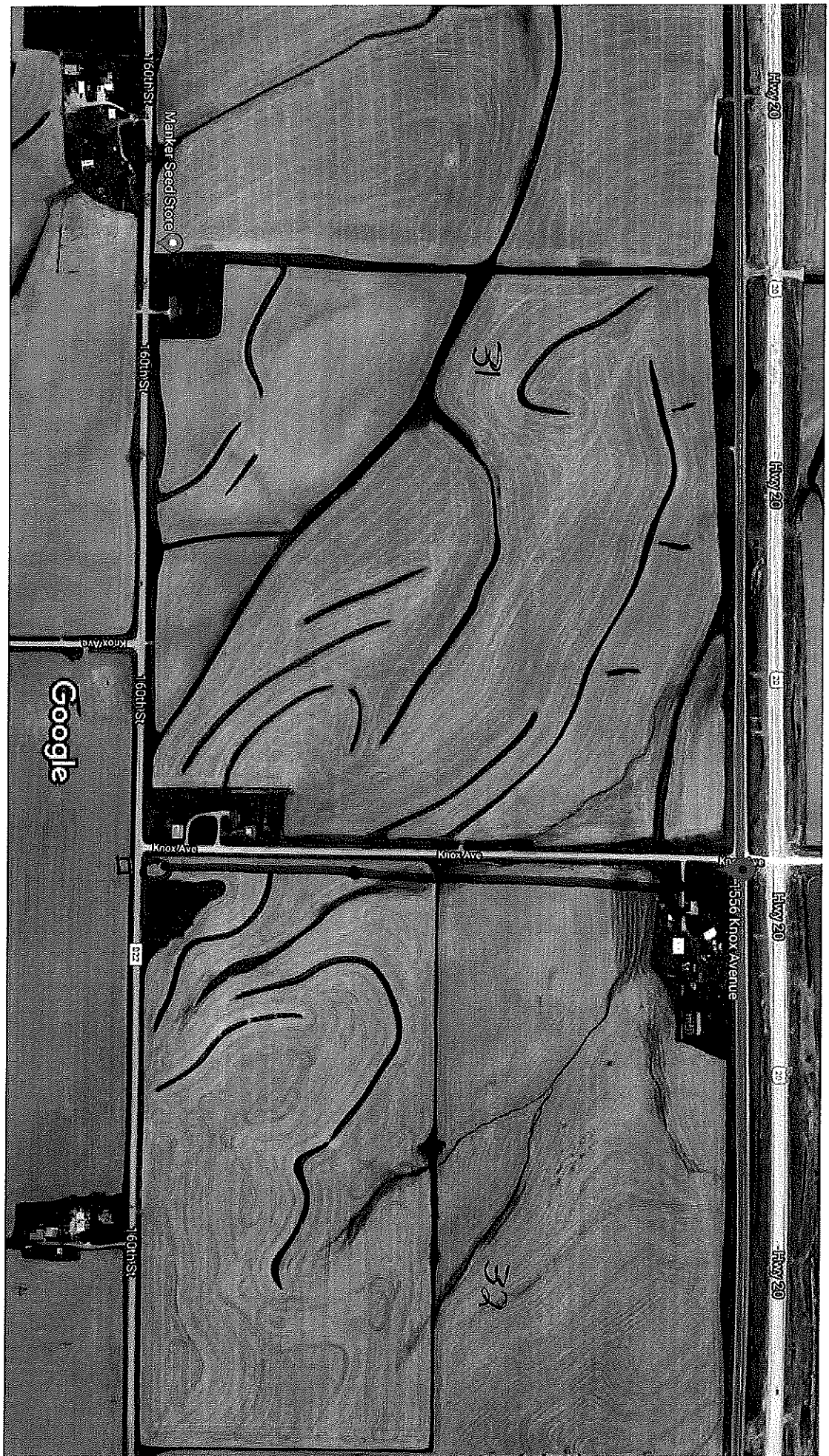

Imagery ©2019 Google, Map data ©2019 Google 200 ft

PERMIT FOR USE OF COUNTY ROAD/HIGHWAY RIGHT-OF-WAY
FOR OVERHEAD AND/OR BURIED UTILITIES ACCOMMODATION

REQUEST BY APPLICANT:

Name Western Iowa Telephone Association

Highway _____

Address 202 Cedar Street Lawton, IA 51030

Township ARLINGTON

City of _____

Office Phone 712-944-5711 Local Phone 712-870-1298

Section: 24/4 of 1/4 Sec

Type of Utility Installation Underground Fiber Optic Cable

T89 N, R44W

Plans Prepared By Phillip Robinson

Copy Enclosed Yes No

Map Showing Location Enclosed Yes No

Utility Location is cross right-of-way
 overhead

parallel to right-of-way
 underground

Proposed Method of Installation

tunnel

suspend on poles

cased

jack & bore

suspend on towers

trench

open cut

plow

Estimated Starting Date 7-25-2019

Estimated Restoration Date 8-25-2019

The Applicant understands and agrees that the permitted work shall comply with all permit provisions and conditions listed on the reverse side hereof, and special provisions listed below or attached hereto, and any and all plans, details, or notes attached hereto and made a part thereof. Applicant is to complete in triplicate and send all copies including plans and maps to Woodbury County Engineer, 759 E. Frontage Road, Merville, IA 51039. One executed copy will be returned to the Applicant.

By Phillip Robinson
(Signature of Authorized Utility Representative)

Title Operations Manager

Date 7-15-2019

PERMIT APPROVAL BY PERMITTING AUTHORITY

The forgoing application is hereby approved and permit issued by the Permitting Authority subject to full compliance by the Applicant with all provisions and conditions stated herein and on the reverse side hereof and all attachments hereto.

By [Signature]
(Signature of Woodbury County Board Chairman)

Title Chair

Date 7/30/2019

By Mark J. Moberg
(Signature of Woodbury County Engineer)

Title County Engineer

Date 7/30/2019

Other Special Provisions:

All lines must be bored under or plowed around county culverts and drainage structures.

Permit Provisions and Conditions of Issuance

- The County and/or the County Board of Supervisors will not be charged with any responsibility for damages to the Applicant's property occasioned by any construction or maintenance operations on said county roads, including new or additional right-of-way acquired in connection therewith, subsequent to the building of the Applicant's facilities. The Board will endeavor to give the Applicant sufficient notice of any proposed construction or maintenance work, on either existing or newly acquired right-of-way that is likely to expose, cover up, or disturb any facilities belonging to the Applicant, in order that the Applicant may arrange to protect the facilities. The Board will inform contractors, and others working on the job of the location of the facilities so that reasonable care may be taken to avoid damaging the facilities, however the County and the Board of Supervisors will assume no responsibility for failure to give such notice.

Google Maps

1321 Jewell Ave

CARY & DONNA KECH

from 3119 130th Ken Webb

L3



Imagery ©2019 Google, Map data ©2019 200 ft



PERMIT FOR USE OF COUNTY ROAD/HIGHWAY RIGHT-OF-WAY
FOR OVERHEAD AND/OR BURIED UTILITIES ACCOMMODATION

REQUEST BY APPLICANT:

Name Western Iowa Telephone Association

Highway _____

Address 202 Cedar Street Lawton, IA 51030

Township RUTLAND

City of _____

Office Phone 712-944-5711 Local Phone 712-870-1298

Section: 30/4 of 1/4 Sec

Type of Utility Installation Underground Fiber Optic Cable

T 89 N, R 43 W

Plans Prepared By Phillip Robinson

Copy Enclosed Yes No

Map Showing Location Enclosed X Yes No

Utility Location is X cross right-of-way
 overhead

 X parallel to right-of-way
 X underground

Proposed Method of Installation

 tunnel

 suspend on poles

 cased

 X jack & bore

 suspend on towers

 trench

 open cut

 X plow

Estimated Starting Date 7-24-2019 Estimated Restoration Date 8-24-2019

The Applicant understands and agrees that the permitted work shall comply with all permit provisions and conditions listed on the reverse side hereof, and special provisions listed below or attached hereto, and any and all plans, details, or notes attached hereto and made a part thereof. Applicant is to complete in triplicate and send all copies including plans and maps to Woodbury County Engineer, 759 E. Frontage Road, Merville, IA 51039. One executed copy will be returned to the Applicant.

By Phillip Robinson
(Signature of Authorized Utility Representative)

Title Operations Manager

Date 7-15-2019

PERMIT APPROVAL BY PERMITTING AUTHORITY

The forgoing application is hereby approved and permit issued by the Permitting Authority subject to full compliance by the Applicant with all provisions and conditions stated herein and on the reverse side hereof and all attachments hereto.

By [Signature]
(Signature of Woodbury County Board Chairman)

Title Chair

Date 7/30/2019

By Mark J. Nahr
(Signature of Woodbury County Engineer)

Title County Engineer

Date 7/30/2019

Other Special Provisions:

All lines must be bored ^{under} ~~around~~ or plowed around county culverts and drainage structures.

Permit Provisions and Conditions of Issuance

- The County and/or the County Board of Supervisors will not be charged with any responsibility for damages to the Applicant's property occasioned by any construction or maintenance operations on said county roads, including new or additional right-of-way acquired in connection therewith, subsequent to the building of the Applicant's facilities. The Board will endeavor to give the Applicant sufficient notice of any proposed construction or maintenance work, on either existing or newly acquired right-of-way that is likely to expose, cover up, or disturb any facilities belonging to the Applicant, in order that the Applicant may arrange to protect the facilities. The Board will inform contractors, and others working on the job of the location of the facilities so that reasonable care may be taken to avoid damaging the facilities, however the County and the Board of Supervisors will assume no responsibility for failure to give such notice.

SCOTT & MICHELLE 1459 Knox Ave - Google Maps

CHAWBERLAIN

MARBE

Google Maps 1459 Knox Ave

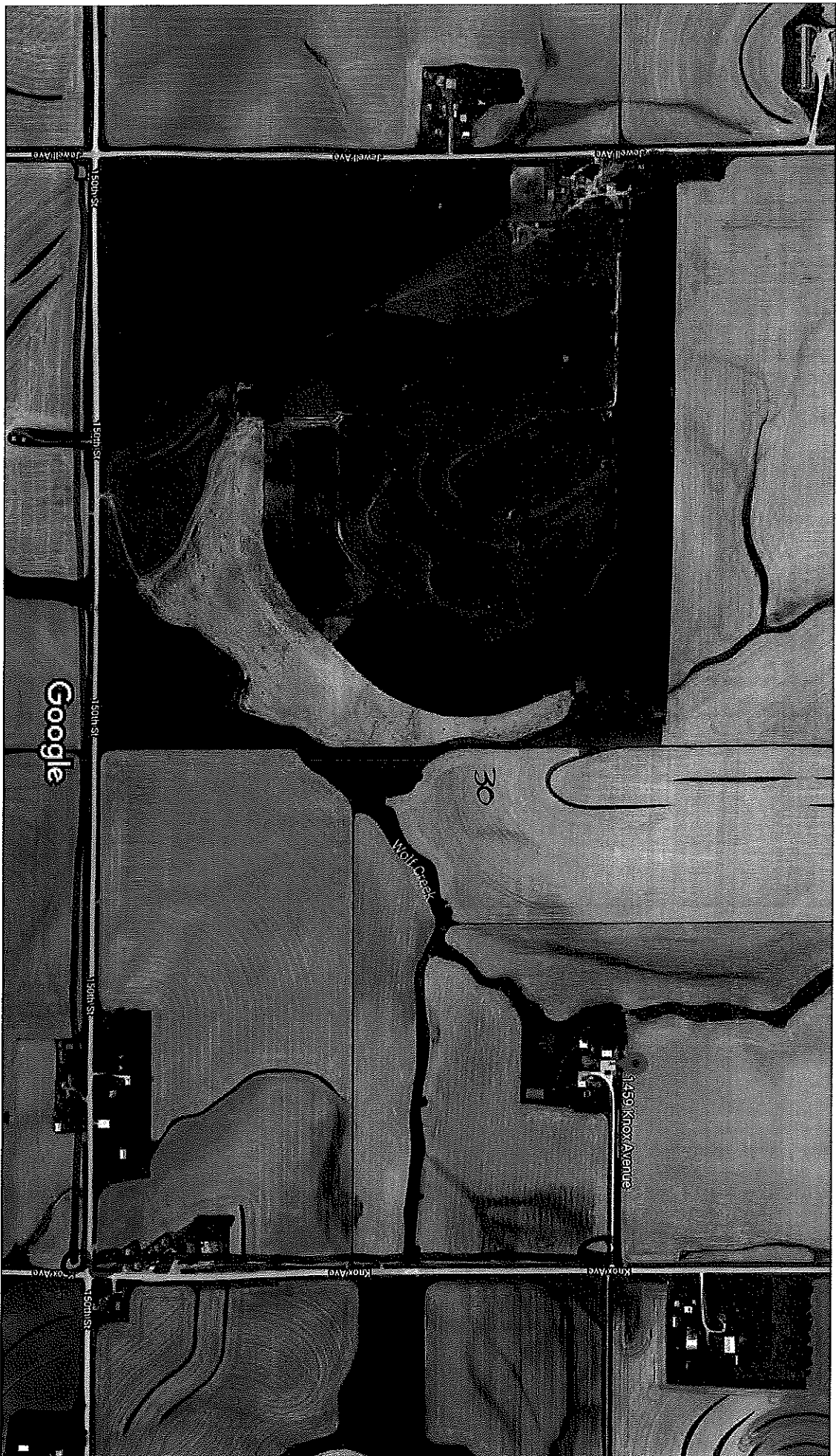

Imagery ©2019 Google, Map data ©2019 Google 500 ft