

Woodbury County Permit No. _____

PERMIT FOR USE OF COUNTY ROAD/HIGHWAY RIGHT-OF-WAY
FOR OVERHEAD AND/OR BURIED UTILITIES ACCOMMODATION

2020 FEB 24 AM 10 47

REQUEST BY APPLICANT:

Name Centurylink

Address 426 Lake Avenue
Storm Lake, IA 50588

Highway 250th st / Mason Ave

Township Miller

City of Anthon

Office Phone 712-732-8348 Local Phone _____

Section: 22 1/4 of 1/4 Sec

Type of Utility Installation copper cable

T87N N, R 42 W

Plans Prepared By Pearce Services

Copy Enclosed X Yes _____ No _____

Map Showing Location Enclosed X Yes _____ No _____

Utility Location is X cross right-of-way
overhead

X parallel to right-of-way
X underground

Proposed Method of Installation

X tunnel _____ suspend on poles _____ cased
jack & bore _____ suspend on towers _____ trench
open cut X plow

Estimated Starting Date 3/24/2020 Estimated Restoration Date 3/31/2020

The Applicant understands and agrees that the permitted work shall comply with all permit provisions and conditions listed on the reverse side hereof, and special provisions listed below or attached hereto, and any and all plans, details, or notes attached hereto and made a part thereof. Applicant is to complete in triplicate and send all copies including plans and maps to Woodbury County Engineer, 759 E. Frontage Road, Merville, IA 51039. One executed copy will be returned to the Applicant.

By Shannon Spain
(Signature of Authorized Utility Representative)

Title Senior Permit Specialist

Date 3/10/2020

PERMIT APPROVAL BY PERMITTING AUTHORITY

The forgoing application is hereby approved and permit issued by the Permitting Authority subject to full compliance by the Applicant with all provisions and conditions stated herein and on the reverse side hereof and all attachments hereto.

By [Signature]
(Signature of Woodbury County Board Chairman)

Title Chairman of the Board

Date 3-17-20

By Mark J. Nelson
(Signature of Woodbury County Engineer)

Title County Engineer

Date 3-17-2020

Other Special Provisions:

Utility must be placed under all county bridges and culverts. Cables may not be placed above culverts.

Permit Provisions and Conditions of Issuance

- The County and/or the County Board of Supervisors will not be charged with any responsibility for damages to the Applicant's property occasioned by any construction or maintenance operations on said county roads, including new or additional right-of-way acquired in connection therewith, subsequent to the building of the Applicant's facilities. The Board will endeavor to give the Applicant sufficient notice of any proposed construction or maintenance work, on either existing or newly acquired right-of-way that is likely to expose, cover up, or disturb any facilities belonging to the Applicant, in order that the Applicant may arrange to protect the facilities. The Board will inform contractors, and others working on the job of the location of the facilities so that reasonable care may be taken to avoid damaging the facilities, however the County and the Board of Supervisors will assume no responsibility for failure to give such notice.

2. The Applicant shall take all reasonable precaution during the construction of said facilities to protect and safeguard the lives and property of the adjacent property owners and the traveling public and shall save the County and the Board of Supervisors harmless of any damages or losses that may be sustained by adjacent property owners and the traveling public on account of such construction operations.
3. Operations in the construction and maintenance of said facilities shall be carried on in such a way as to not interfere with, or interrupt traffic on said roads. However, should the performance of work called for in this permit in any way interfere with or obstruct traffic on said roads, the Applicant shall provide the necessary flagmen as required by the Statutes when one-way traffic is involved and/or otherwise mark said work so as to protect the traveling public.
4. The Applicant shall hold the County and the Board of Supervisors harmless from any damages that may result to said highway because of the construction or maintenance of said facilities and shall reimburse the County or the Board of Supervisors for any expenditures that the County or the Board of Supervisors may have to make on said roads on account of replacement of surfacing gravel and bridge and culvert repairs.
5. Applicant shall lay, construct, operate and maintain said facilities so as not to interfere with natural drainage of the road and so as not to interfere with the construction or maintenance of said roads. When buried cable or wire lines are to be placed lengthwise with the roadway, they shall be placed in the County road shoulder or ditch near the toe of the fore-slope and parallel to centerline of roadbed at a depth of three (3) to four (4) feet by using specially designed plows or by trenching, whichever is appropriate. Plow slots and trenches shall be repacked as necessary to restore the disturbed area to its original condition. For buried line crossings of roadways not paved, an open trench may be dug and the lines placed therein, and the trench back-filled over the lines. Buried line crossings on paved roadways, lines may be placed through the sub-grade by jacking, or by boring a hole just large enough to take the lines; or if the County Engineer approves, a tunnel may be dug through and the cable or wire lines placed therein. All backfill of tunnels and trenches shall be thoroughly compacted in layers of 6" or less in depth. Back-filling of trenches within the right-of-way by not under the traveled roadway shall be tamped sufficiently to avoid settlement. When crossing an existing roadway, all buried facilities shall be placed a minimum of three (3) to four (4) below the bottom of the existing adjacent ditches. Overhead lines, where practical, shall be placed adjacent to and with two (2) feet of the Road/Highway Right-of-Way Line.
6. The Applicant will at any time subsequent to placing the facilities, and at the Applicant's expense, relay, replace, alter, change, reconstruct, or relocate its overhead and/or buried facilities and appurtenances thereto as may become necessary to conform to new grades, alignment, or widening right-of-way, resulting from maintenance or construction operations by the County Board of Supervisors irrespective of whether or not additional right-of-way is acquired in connection with such road improvements. The Applicant agrees to do this within ninety (90) days written notice from the Board of Supervisors, and without cost to the County. If the Applicant is unable to comply within said ninety (90) days, the Board of Supervisors may cause the work to be done and the Applicant will pay the cost thereof upon receipt of statement.
7. All work shall be done in a workmanlike manner; the surrounding ground, slopes, and ditch bottoms shall be reshaped to conform to the area and left in a neat condition satisfactory to the County Engineer. All areas where sod has been damaged or destroyed shall be re-seeded.
8. The Applicant shall notify the County Board of Supervisors at least forty-eight (48) hours in advance of the Applicant's intention of starting work covered by this permit on the road right-of-way. Said notice shall be in writing to the County Engineer.
9. Applicant, its' successors, grantees and assigns shall and hereby agrees to assume all responsibility, risks and liabilities for all accidents and damages that may occur to persons and/or property on account of the work done under this permit, and to this end, indemnify and hold the County and all authorized representatives thereof harmless from any and all claims, damages, losses, and expense including judgements, costs and including attorney's fees, for personal injuries (including death) or property damage arising or resulting from the activities of the Applicant in connection herewith, now and at all times in the future.
10. It is understood that this permit is issued only insofar as Woodbury County has jurisdiction and does not presume to release the Applicant from fulfilling any existing statutes relating to the installation, construction and operation of said facilities.
11. It is further understood that the facilities covered by this permit shall be constructed or installed within one (1) year after the date of approval of this permit, unless otherwise extended in writing by Woodbury County.
12. Engagement in the operations as herein applied for by the Applicant shall be considered and constitute an acceptance of all the terms and conditions herein set forth.

PROJECT WORK AREA



DISCLAIMER:
UTILITY LOCATIONS SHOWN ON THIS DRAWING ARE APPROXIMATE AND SHOULD NOT BE SOLELY RELIED UPON TO LOCATE UNDERGROUND FACILITIES. THE CONTRACTOR SHALL BE FULLY RESPONSIBLE FOR COMPLIANCE WITH STATEWIDE AND/OR LOCAL AREA "ONE CALL" PROGRAMS AND REQUIREMENTS.

CALL BEFORE DIGGING
UTILITY NOTIFICATION CENTER OF IOWA
811

ADDRESS: 250TH ST & MASON AVE
ANTHON, IA
WOODBURY COUNTY
TOWNSHIP: MILLER
S22-T87N-R42W
WOODBURY COUNTY PERMIT REQ'D



CenturyLink ENGINEER: JUSTIN MELOHN
DRAWN BY: PEARCE SERVICES / KEVIN KANNUAN
REVISION: 001
SHEET: PROJECT WORK AREA

PROJECT TITLE: ROAD MOVE PROJECT
PROJECT NUMBER: N.677999
CLI: ANTHIACO
SCALE: NTS
DATE: 25 FEB 2020



PROJECT WORK LOCATION



DISCLAIMER:
UTILITY LOCATIONS SHOWN ON THIS
DRAWING ARE APPROXIMATE AND
SHOULD NOT BE SOLELY RELIED UPON
TO LOCATE UNDERGROUND
FACILITIES. THE CONTRACTOR SHALL
BE FULLY RESPONSIBLE FOR
COMPLIANCE WITH STATEWIDE
AND/OR LOCAL AREA "ONE CALL"
PROGRAMS AND REQUIREMENTS.

CALL BEFORE DIGGING
UTILITY NOTIFICATION CENTER OF
IOWA
811

ADDRESS: 250TH ST & MASON AVE
ANTHON, IA
WOODBURY COUNTY
TOWNSHIP: MILLER
S22-T87N-R42W
WOODBURY COUNTY PERMIT REQ'D



CenturyLink ENGINEER: JUSTIN MELOHN
DRAWN BY: PEARCE SERVICES / KEVIN KANNUAN
REVISION: 001
SHEET: PROJECT LOCATION

PROJECT TITLE: ROAD MOVE PROJECT
PROJECT NUMBER: N.677999
CLI: ANTHIACO
SCALE: NTS
DATE: 25 FEB 2020



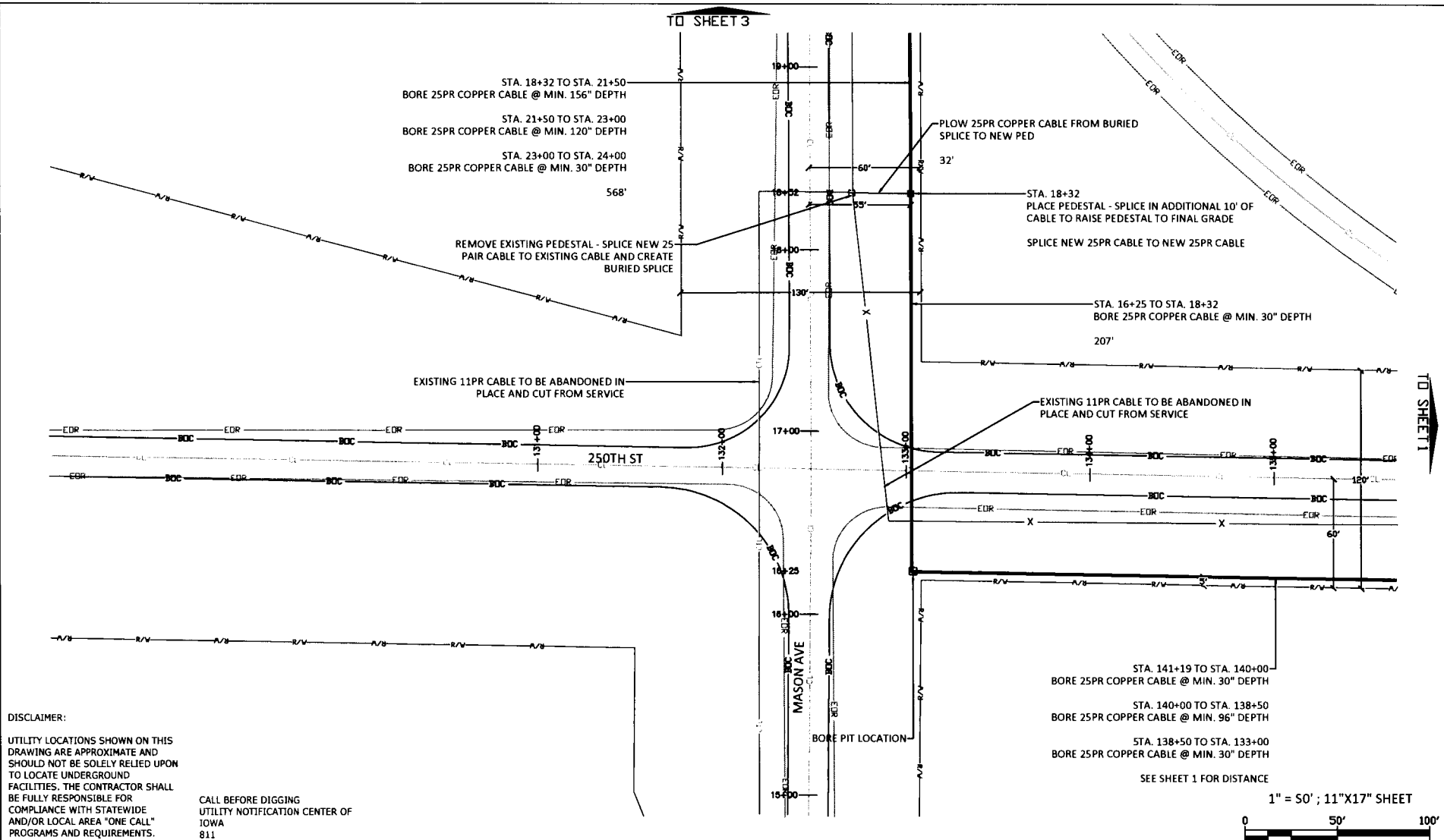

DISCLAIMER:
 UTILITY LOCATIONS SHOWN ON THIS DRAWING ARE APPROXIMATE AND SHOULD NOT BE SOLELY RELIED UPON TO LOCATE UNDERGROUND FACILITIES. THE CONTRACTOR SHALL BE FULLY RESPONSIBLE FOR COMPLIANCE WITH STATEWIDE AND/OR LOCAL AREA "ONE CALL" PROGRAMS AND REQUIREMENTS.

CALL BEFORE DIGGING
 UTILITY NOTIFICATION CENTER OF IOWA
 811

ADDRESS: 250TH ST & MASON AVE
 ANTHON, IA
 WOODBURY COUNTY
 TOWNSHIP: MILLER
 S22-T87N-R42W

WOODBURY COUNTY PERMIT REQ'D



CenturyLink ENGINEER: JUSTIN MELOHN
 DRAWN BY: PEARCE SERVICES / KEVIN KANNUAN
 REVISION: 001
 SHEET: 2 OF 4

PROJECT TITLE: ROAD MOVE PROJECT
 PROJECT NUMBER: N.677999
 CLLI: ANTHIACO
 SCALE: 1:50
 DATE: 25 FEB 2020



1" = 50'; 11"X17" SHEET



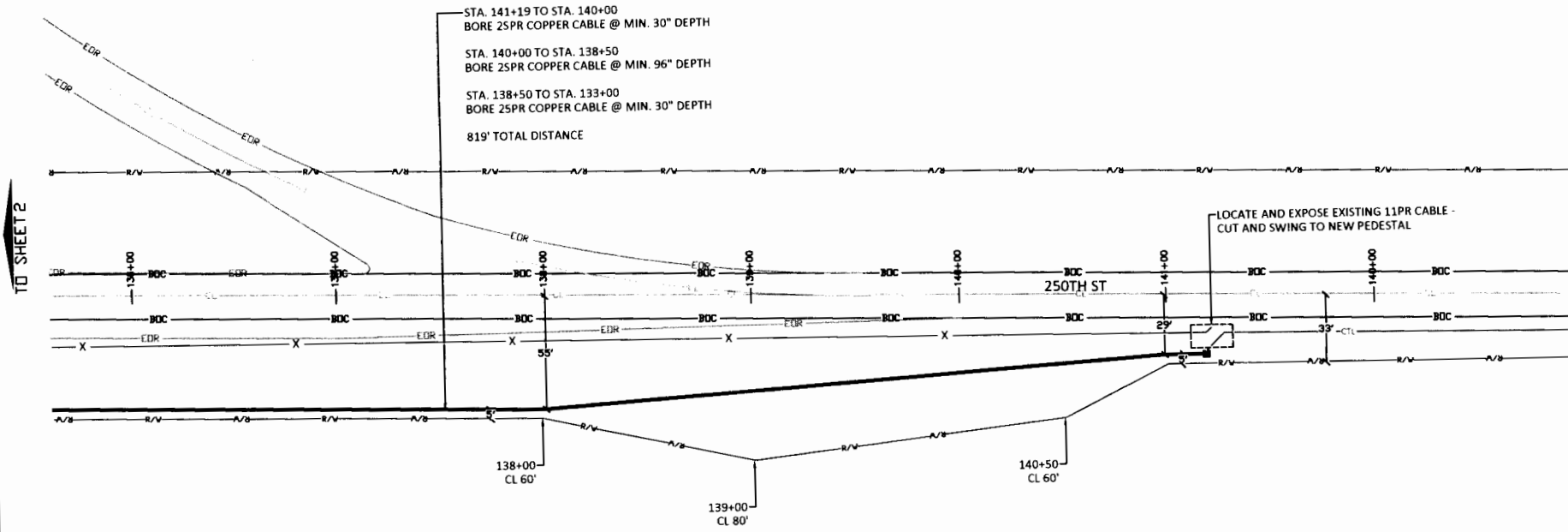

DISCLAIMER:
 UTILITY LOCATIONS SHOWN ON THIS
 DRAWING ARE APPROXIMATE AND
 SHOULD NOT BE SOLELY RELIED UPON
 TO LOCATE UNDERGROUND
 FACILITIES. THE CONTRACTOR SHALL
 BE FULLY RESPONSIBLE FOR
 COMPLIANCE WITH STATEWIDE
 AND/OR LOCAL AREA "ONE CALL"
 PROGRAMS AND REQUIREMENTS.

CALL BEFORE DIGGING
 UTILITY NOTIFICATION CENTER OF
 IOWA
 811

1" = 50' ; 11"X17" SHEET
 0 50' 100'

ADDRESS: 250TH ST & MASON AVE
 ANTHON, IA
 WOODBURY COUNTY
 TOWNSHIP: MILLER
 S22-T87N-R42W WOODBURY COUNTY PERMIT REQ'D



CenturyLink ENGINEER: JUSTIN MELOHN
 DRAWN BY: PEARCE SERVICES / KEVIN KANNUAN
 REVISION: 001
 SHEET: 1 OF 4

PROJECT TITLE: ROAD MOVE PROJECT
PROJECT NUMBER: N.677999
CLLI: ANTHIACO
SCALE: 1:50
DATE: 25 FEB 2020



DISCLAIMER:

UTILITY LOCATIONS SHOWN ON THIS DRAWING ARE APPROXIMATE AND SHOULD NOT BE SOLELY RELIED UPON TO LOCATE UNDERGROUND FACILITIES. THE CONTRACTOR SHALL BE FULLY RESPONSIBLE FOR COMPLIANCE WITH STATEWIDE AND/OR LOCAL AREA "ONE CALL" PROGRAMS AND REQUIREMENTS.

CALL BEFORE DIGGING
UTILITY NOTIFICATION CENTER OF IOWA
811

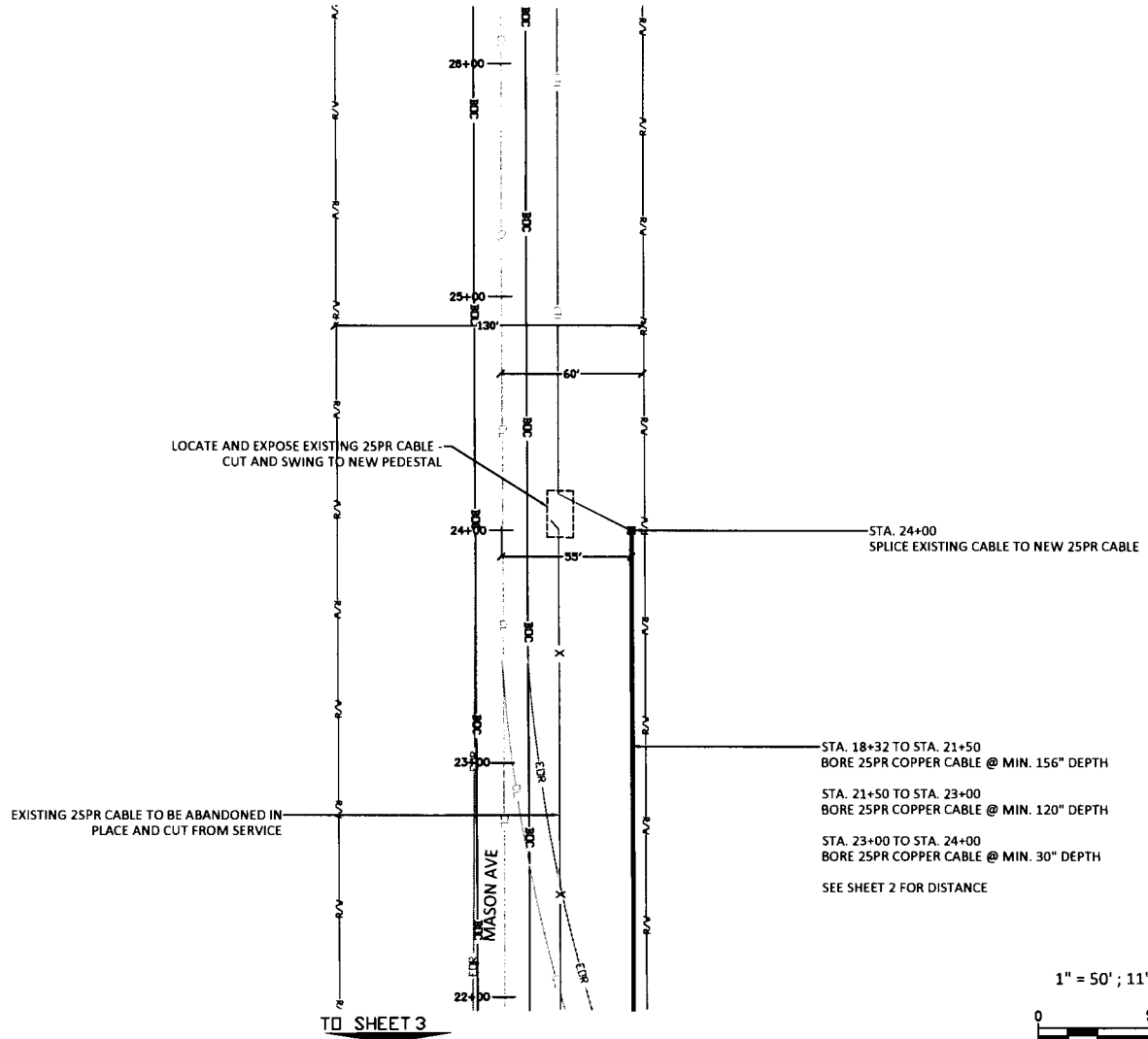

1" = 50'; 11"X17" SHEET

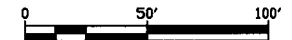

ADDRESS: 250TH ST & MASON AVE
ANTHON, IA
WOODBURY COUNTY
TOWNSHIP: MILLER
S22-T87N-R42W
WOODBURY COUNTY PERMIT REQ'D



CenturyLink ENGINEER: JUSTIN MELOHN
DRAWN BY: PEARCE SERVICES / KEVIN KANNUAN
REVISION: 001
SHEET: 4 OF 4

PROJECT TITLE: ROAD MOVE PROJECT
PROJECT NUMBER: N.677999
CLLI: ANTHIACO
SCALE: 1:50
DATE: 25 FEB 2020

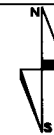

TO SHEET 4

EXISTING 25PR CABLE TO BE ABANDONED IN PLACE AND CUT FROM SERVICE

STA. 18+32 TO STA. 21+50
BORE 25PR COPPER CABLE @ MIN. 156" DEPTH
STA. 21+50 TO STA. 23+00
BORE 25PR COPPER CABLE @ MIN. 120" DEPTH
STA. 23+00 TO STA. 24+00
BORE 25PR COPPER CABLE @ MIN. 30" DEPTH
SEE SHEET 2 FOR DISTANCE

TO SHEET 2

DISCLAIMER:
UTILITY LOCATIONS SHOWN ON THIS DRAWING ARE APPROXIMATE AND SHOULD NOT BE SOLELY RELIED UPON TO LOCATE UNDERGROUND FACILITIES. THE CONTRACTOR SHALL BE FULLY RESPONSIBLE FOR COMPLIANCE WITH STATEWIDE AND/OR LOCAL AREA "ONE CALL" PROGRAMS AND REQUIREMENTS.

CALL BEFORE DIGGING
UTILITY NOTIFICATION CENTER OF IOWA
811

1" = 50'; 11"X17" SHEET

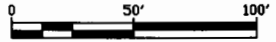

ADDRESS: 250TH ST & MASON AVE
ANTHON, IA
WOODBURY COUNTY
TOWNSHIP: MILLER
S22-T87N-R42W
WOODBURY COUNTY PERMIT REQ'D



CenturyLink ENGINEER: JUSTIN MELOHN
DRAWN BY: PEARCE SERVICES / KEVIN KANNUAN
REVISION: 001
SHEET: 3 OF 4

PROJECT TITLE: ROAD MOVE PROJECT
PROJECT NUMBER: N.677999
CLLI: ANTHIACO
SCALE: 1:50
DATE: 25 FEB 2020

