

Woodbury County Permit No. _____

PERMIT FOR USE OF COUNTY ROAD/HIGHWAY RIGHT-OF-WAY FOR OVERHEAD AND/OR BURIED UTILITIES ACCOMMODATION

REQUEST BY APPLICANT:

Name Cherokee Rural Water Highway 130th street
 Address P.O. Box 1022 Cherokee, IA 51012 Township Union
 City of Pierston
 Office Phone 712-225-6193 Local Phone 712-229-6547 Section: SE 1/4 of SW 1/4 Sec 16, NE 1/4 of NW 1/4 Sec 21
 Type of Utility Installation Water Service Line - 1 1/2" T 89 N, R 42 W
 Plans Prepared By Matt Draper Copy Enclosed Yes No
 Map Showing Location Enclosed Yes No
 Utility Location is _____ cross right-of-way _____ parallel to right-of-way
 _____ overhead underground
 Proposed Method of Installation
 _____ tunnel _____ suspend on poles _____ cased
 jack & bore _____ suspend on towers _____ trench
 _____ open cut _____ plow

Estimated Starting Date 10/28/20 Estimated Restoration Date 10/30/20

The Applicant understands and agrees that the permitted work shall comply with all permit provisions and conditions listed on the reverse side hereof, and special provisions listed below or attached hereto, and any and all plans, details, or notes attached hereto and made a part thereof. Applicant is to complete in triplicate and send all copies including plans and maps to Woodbury County Engineer, 759 E. Frontage Road, Merville, IA 51039. One executed copy will be returned to the Applicant.

By [Signature] Title ASH Mgr
(Signature of Authorized Utility Representative) Date 10/22/20

PERMIT APPROVAL BY PERMITTING AUTHORITY

The foregoing application is hereby approved and permit issued by the Permitting Authority subject to full compliance by the Applicant with all provisions and conditions stated herein and on the reverse side hereof and all attachments hereto.

By [Signature] Title Chairman
(Signature of Woodbury County Board Chairman) Date 10-27-20

By [Signature] Title County Engineer
(Signature of Woodbury County Engineer) Date 10/27/2020

Other Special Provisions:
Permitter may not construct water lines above county culverts.

Permit Provisions and Conditions of Issuance

- The County and/or the County Board of Supervisors will not be charged with any responsibility for damages to the Applicant's property occasioned by any construction or maintenance operations on said county roads, including new or additional right-of-way acquired in connection therewith, subsequent to the building of the Applicant's facilities. The Board will endeavor to give the Applicant sufficient notice of any proposed construction or maintenance work, on either existing or newly acquired right-of-way that is likely to expose, cover up, or disturb any facilities belonging to the Applicant, in order that the Applicant may arrange to protect the facilities. The Board will inform contractors, and others working on the job of the location of the facilities so that reasonable care may be taken to avoid damaging the facilities, however the County and the Board of Supervisors will assume no responsibility for failure to give such notice.

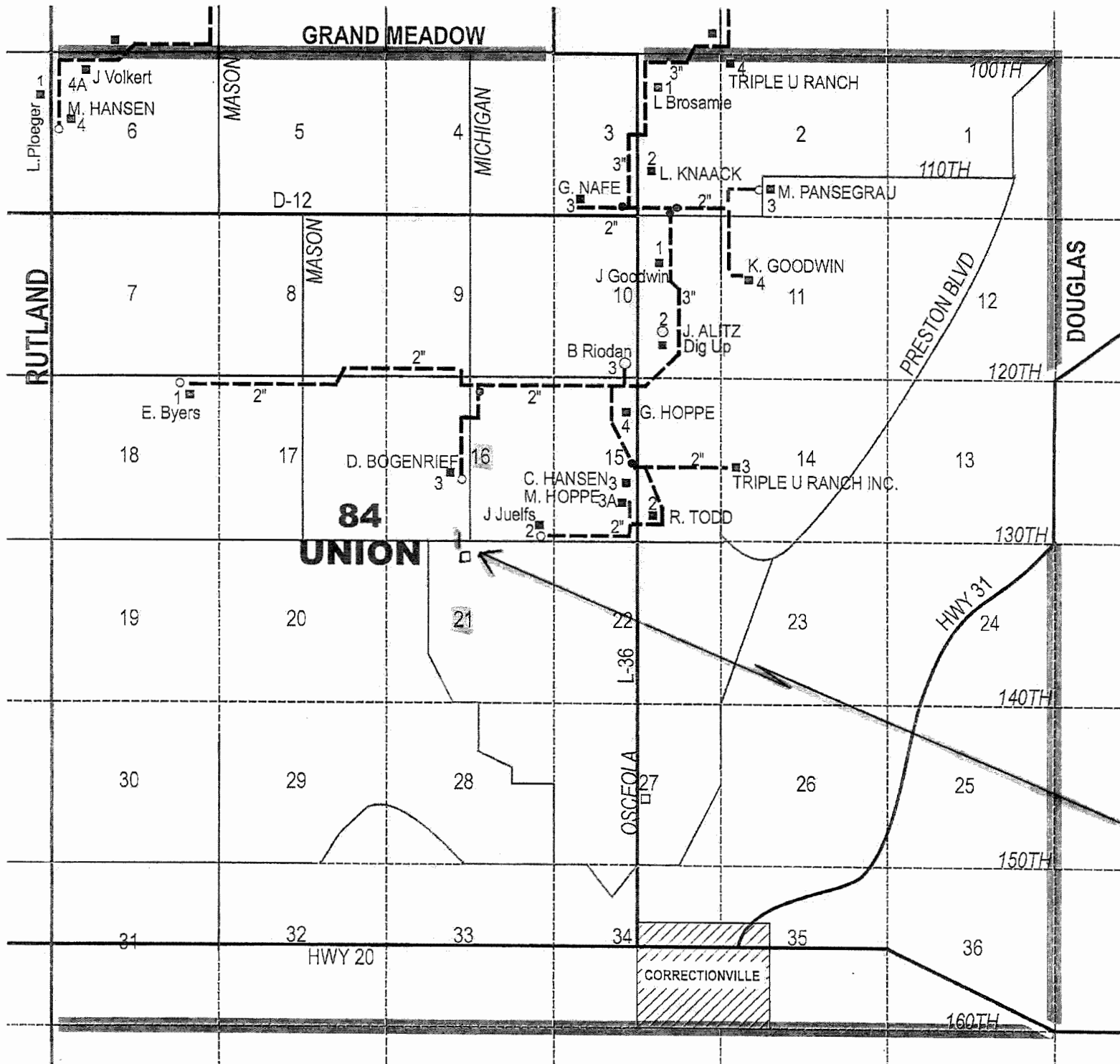

UPDATED: 9-2020

ADDRESSES:
WEST (ODD) TO EAST (EVEN)
3800 - 4300

NORTH (ODD) TO SOUTH (EVEN)
1000 - 1500

NOTES:

* Bored Row to
Row cross.ing
130th Street T89N-R42W

More
Detail

ABANDON

PIPE IN DITCH

TRACER WIRE

GRAND MEADOW

UPDATED: 9-2020

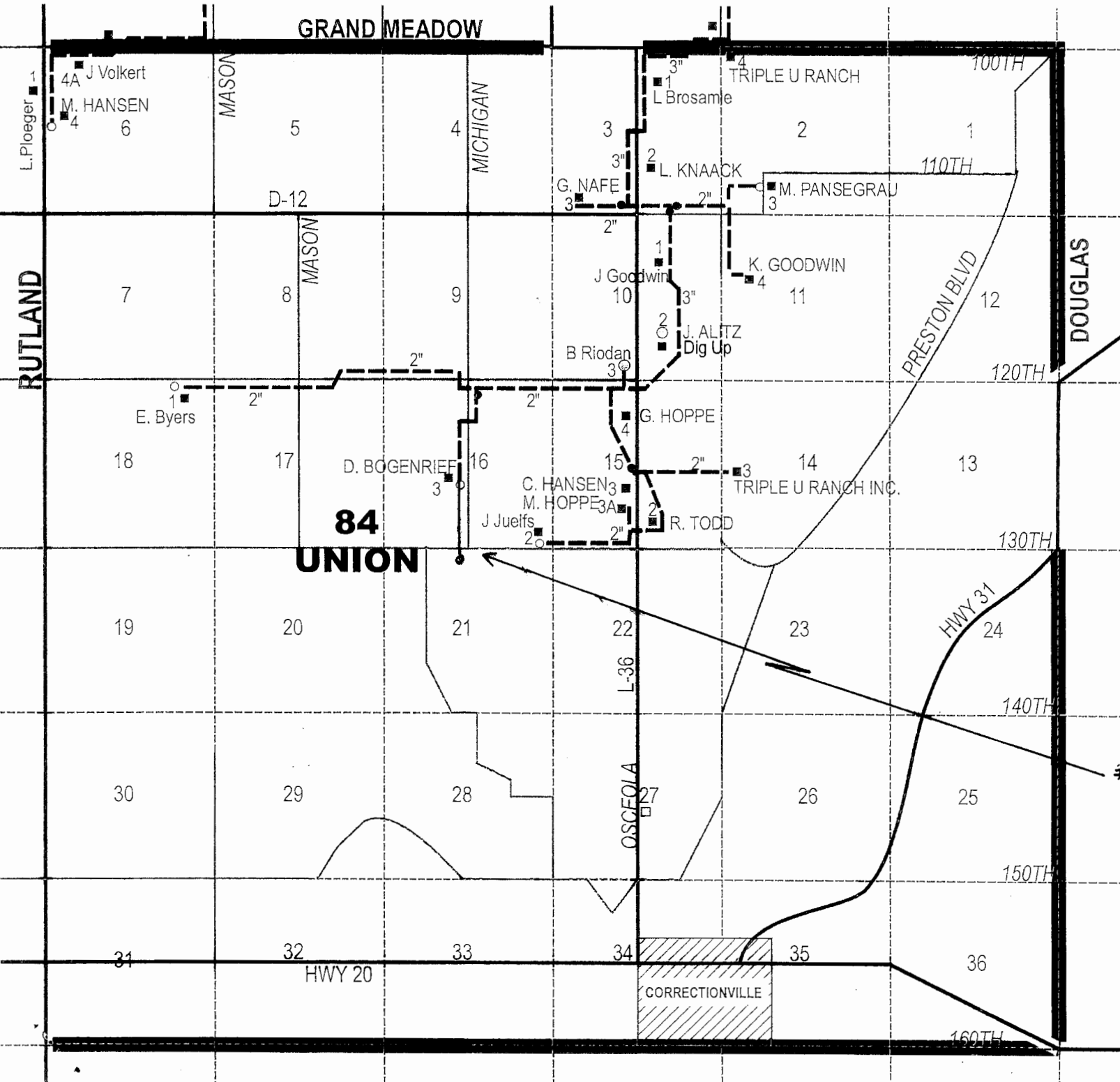

ADDRESSES:
 WEST (ODD) TO EAST (EVEN)
 3800 - 4300

NORTH (ODD) TO SOUTH (EVEN)
 1000 - 1500

NOTES:

T89N-R42W

More
 Detail

ABANDON

PIPE IN DITCH

TRACER WIRE

Cherokee Rural Water

1593 580th St. P.O. Box 1022 Cherokee, IA 51012

Ph. 712-225-6193 Fax 712-225-6195

Mark J. Nahra, P.E.
Woodbury County Engineer
759 E. Frontage Road
Moville, Ia. 51039

RECEIVED
OCT 20 2020
COUNTY ENGINEER
WOODBURY COUNTY IOWA
BY _____

Date: October 15, 2020

Greetings Mark,

Enclosed you will find an application of underground construction on county Road Right-of-Way, along with a map showing the location. We will be installing a water line on the East side of Michigan Avenue, crossing 130th street, for new water service for Jesse Bogenrief. We will let you know of any changes occur.

Waterline will be directional bored under 130th Street from ROW to ROW

We will also let you know when we have any more upcoming projects.

If you have any questions or comments please feel free to give me a call at the above phone number.

Regards..... Matt Draper

GRAND MEADOW

UPDATED: 9-2020

RUTLAND

DOUGLAS

ADDRESSES:
WEST (ODD) TO EAST (EVEN)
3800 - 4300

NORTH (ODD) TO SOUTH (EVEN)
1000 - 1500

NOTES:

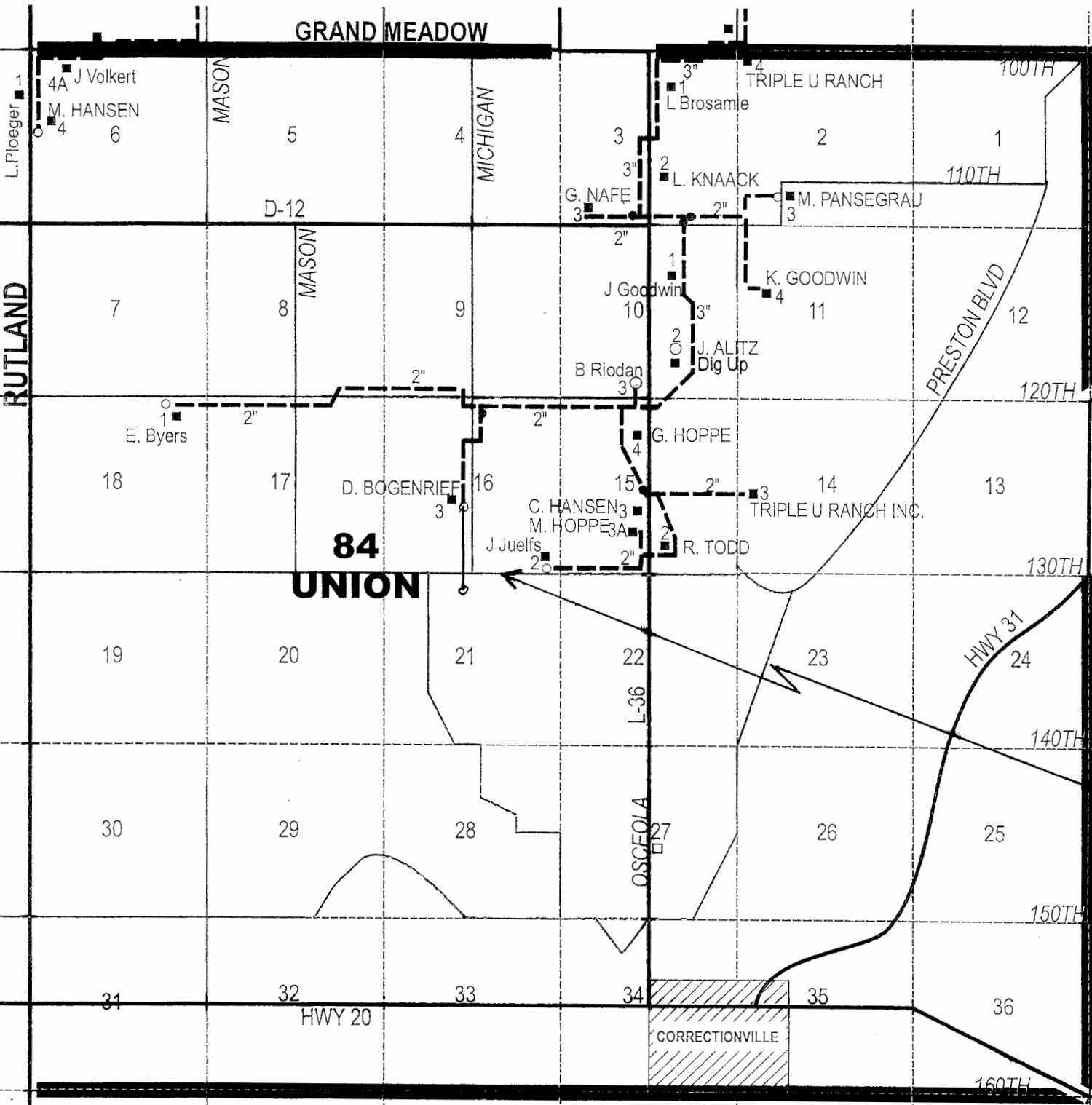

84

UNION

#1

T89N-R42W

More
Detail

ABANDON

PIPE IN DITCH

TRACER WIRE