

Woodbury County Permit No. \_\_\_\_\_

**PERMIT FOR USE OF COUNTY ROAD/HIGHWAY RIGHT-OF-WAY  
FOR OVERHEAD AND/OR BURIED UTILITIES ACCOMMODATION**

**REQUEST BY APPLICANT:**

Name Simon Schwindt - MidAmerican Energy Highway K25 - Port Neal Rd  
Address 2351 East County Line Road Township \_\_\_\_\_  
City of \_\_\_\_\_

Office Phone 224-769-0327 Local Phone \_\_\_\_\_ Section:  $\frac{1}{4}$  of  $\frac{1}{4}$  Sec 17-18  
Type of Utility Installation Communications T 87 N, R 47 W

Plans Prepared By Precision Underground Utilities Copy Enclosed  Yes \_\_\_\_\_ No

Map Showing Location Enclosed  Yes \_\_\_\_\_ No

Utility Location is  cross right-of-way \_\_\_\_\_ parallel to right-of-way  
 overhead \_\_\_\_\_ underground

**Proposed Method of Installation**

tunnel  suspend on poles  cased  
 jack & bore  suspend on towers  trench  
 open cut  plow

Estimated Starting Date 12/13/21 Estimated Restoration Date Spring 2022

The Applicant understands and agrees that the permitted work shall comply with all permit provisions and conditions listed on the reverse side hereof, and special provisions listed below or attached hereto, and any and all plans, details, or notes attached hereto and made a part thereof. Applicant is to complete in triplicate and send all copies including plans and maps to Woodbury County Engineer, 759 E. Frontage Road, Merville, IA 51039. One executed copy will be returned to the Applicant.

By Simon Schwindt Title Project Manager  
(Signature of Authorized Utility Representative) Date 11/29/2021

**PERMIT APPROVAL BY PERMITTING AUTHORITY**

The forgoing application is hereby approved and permit issued by the Permitting Authority subject to full compliance by the Applicant with all provisions and conditions stated herein and on the reverse side hereof and all attachments hereto.

By [Signature] Title Chairman  
(Signature of Woodbury County Board Chairman) Date 12/7/2021

By Mark J. Mahan Title County Engineer  
(Signature of Woodbury County Engineer) Date 12/7/2021

Other Special Provisions:

**Permit Provisions and Conditions of Issuance**

- The County and/or the County Board of Supervisors will not be charged with any responsibility for damages to the Applicant's property occasioned by any construction or maintenance operations on said county roads, including new or additional right-of-way acquired in connection therewith, subsequent to the building of the Applicant's facilities. The Board will endeavor to give the Applicant sufficient notice of any proposed construction or maintenance work, on either existing or newly acquired right-of-way that is likely to expose, cover up, or disturb any facilities belonging to the Applicant, in order that the Applicant may arrange to protect the facilities. The Board will inform contractors, and others working on the job of the location of the facilities so that reasonable care may be taken to avoid damaging the facilities, however the County and the Board of Supervisors will assume no responsibility for failure to give such notice.

Approved 1/19/99

CONSTRUCTION DRAWINGS  
FOR  
MIDAMERICAN ENERGY - KNOX SUB - SIOUX CITY  
PRECISION UNDERGROUND UTILITIES, LLC  
WOODBURY COUNTY

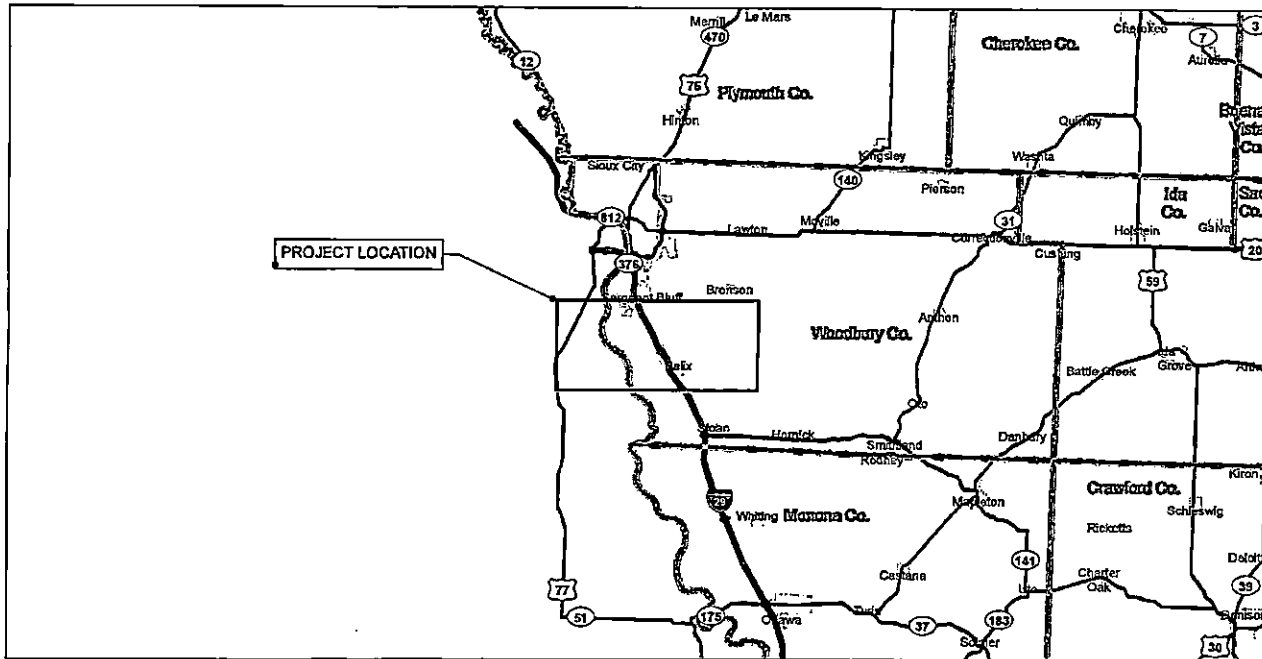

INDEX OF SHEETS	
1	TITLE SHEET
2	SITE OVERVIEW
3	PLANS

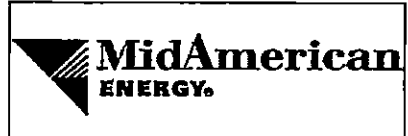

**PRECISION UNDERGROUND UTILITIES, LLC**  
 PO BOX 409  
 309 S. WATER STREET  
 CAMBRIDGE, IA 50046  
 PHONE (515) 597-4004  
[WWW.PRECISIONUNDERGROUNDIA.COM](http://WWW.PRECISIONUNDERGROUNDIA.COM)

**COMMUNICATION INNOVATORS**  
 PO BOX 57037  
 1301 NE 58TH ST  
 PLEASANT HILL, IA 50317  
 PHONE (515) 282-7686  
[WWW.GOTOCL.COM](http://WWW.GOTOCL.COM)

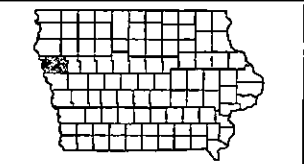

**IOWA ONE CALL**  
 1-800-292-8989  
[WWW.IOWAONECALL.COM](http://WWW.IOWAONECALL.COM)

NOTE: THE PLAN LOCATIONS OF UNDERGROUND AND AERIAL UTILITIES, WHEN SHOWN, ARE APPROXIMATE ONLY. IN ADDITION, A PORTION OF UTILITY INFORMATION MAY NOT HAVE BEEN PROVIDED. ALL UTILITIES SHALL BE LOCATED AND MARKED PRIOR TO CONSTRUCTION. THE CONTRACTOR SHALL BE RESPONSIBLE FOR CONTRACTING UTILITIES AND LOCATOR SERVICES AND SCHEDULING THE LOCATION OF UNDERGROUND UTILITIES. THE CONTRACTOR SHALL ALSO CONTACT ANY AND ALL UTILITIES AND LOCAL GOVERNMENT AGENCIES NOT PARTICIPATING IN LOCATION SERVICES.

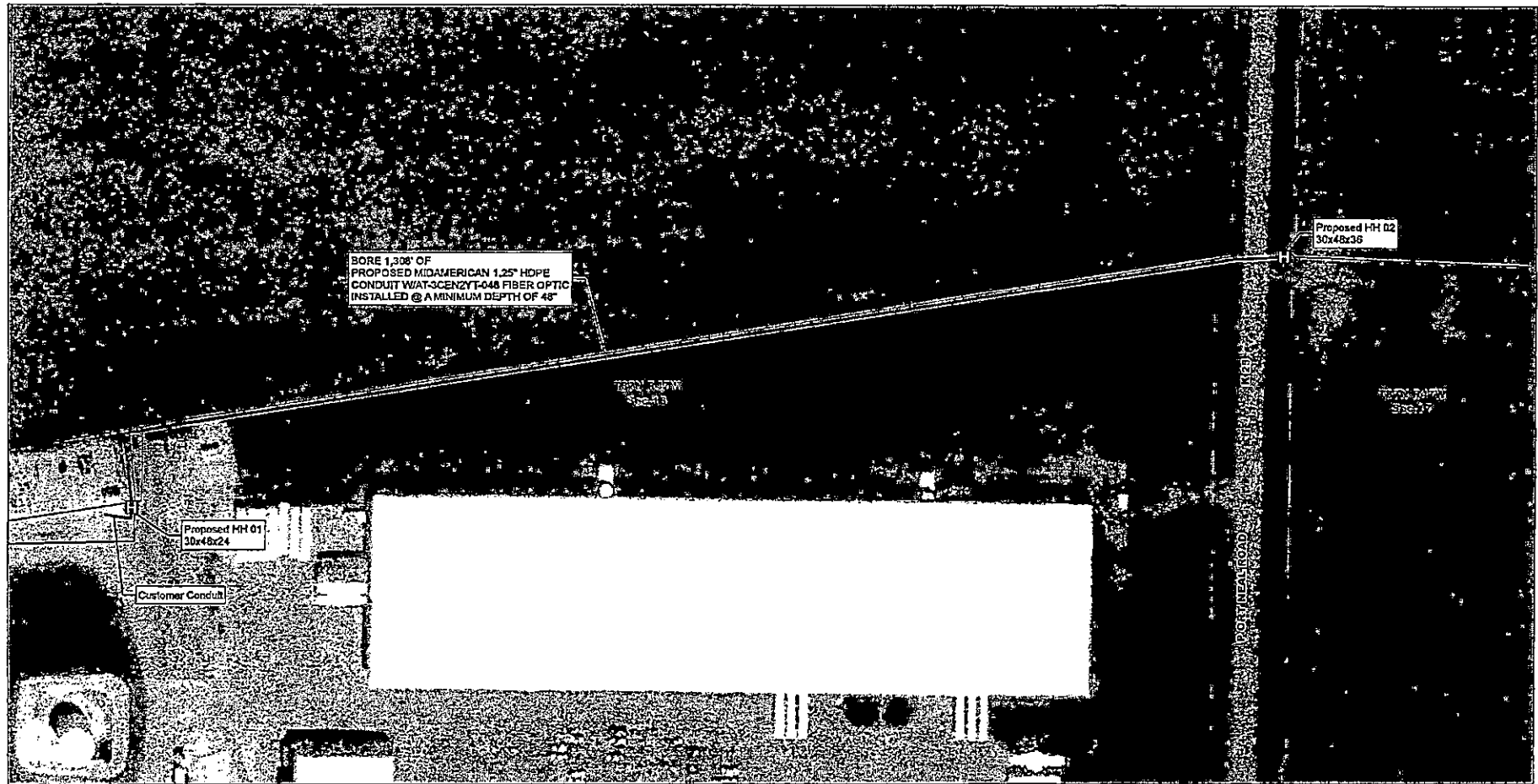

BORE 1,000' OF PROPOSED MIDAMERICAN 1.25" HDPE CONDUIT W/AT-3CENZYT-048 FIBER OPTIC INSTALLED @ A MINIMUM DEPTH OF 48"

Proposed MH 02  
30x48x36

Proposed MH 01  
30x48x24

Customer Conduh

PORTWAL ROAD



**LEGEND AND INFORMATION**

Proposed Handhole    
  Bored Duct    
  County Parcels  
 Customer Installed

PROPOSED MIDAMERICAN 1.25" HDPE CONDUIT W/AT-3CENZYT-048 FIBER OPTIC INSTALLED @ A MINIMUM DEPTH OF 48". BORE ALL CULVERT CROSSINGS A MINIMUM DEPTH OF 60" BELOW FLOWLINE AND BORE ALL STREET CROSSINGS A MINIMUM OF 60" FROM TOP OF CURB OR PAVEMENT.

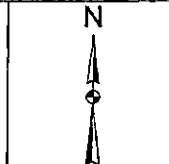

PRECISION UNDERGROUND UTILITIES

COMMUNICATION INNOVATORS

MIDAMERICAN ENERGY - KNOX SUB - SJOUX CITY

PLANS

SCALE 1 in = 100 ft

WOODBURY COUNTY

SHEET NUMBER 3